



**A complete drawer system that is fast and easy**



**With the available accessories for METABOX, not only is the system easy to build, the possibilities are endless**



**More Information is available on these Blum products:**

- Blum Angled hinge program
- BLUMOTION soft closing system
- COMPACT concealed hinges for frame cabinets
- Concealed hinges: CLIP top, CLIP and MODUL
- Machines and assembly aids
- METABOX drawer system
- ORGA-LINE drawer dividing system
- POCKET DOOR hardware
- STANDARD drawer runners
- SOLO concealed runners
- TANDEM concealed runners
- TANDEMBOX drawer system



Julius Blum, Inc.  
7733 Old Plank Rd.  
Stanley, NC 28164  
**toll free** 800-438-6788  
**local** 704-827-1345  
**fax** 704-827-0799  
**internet** [www.blum.com](http://www.blum.com)

The ultimate hardware system



3053.01.03 © 2003 Printed in USA

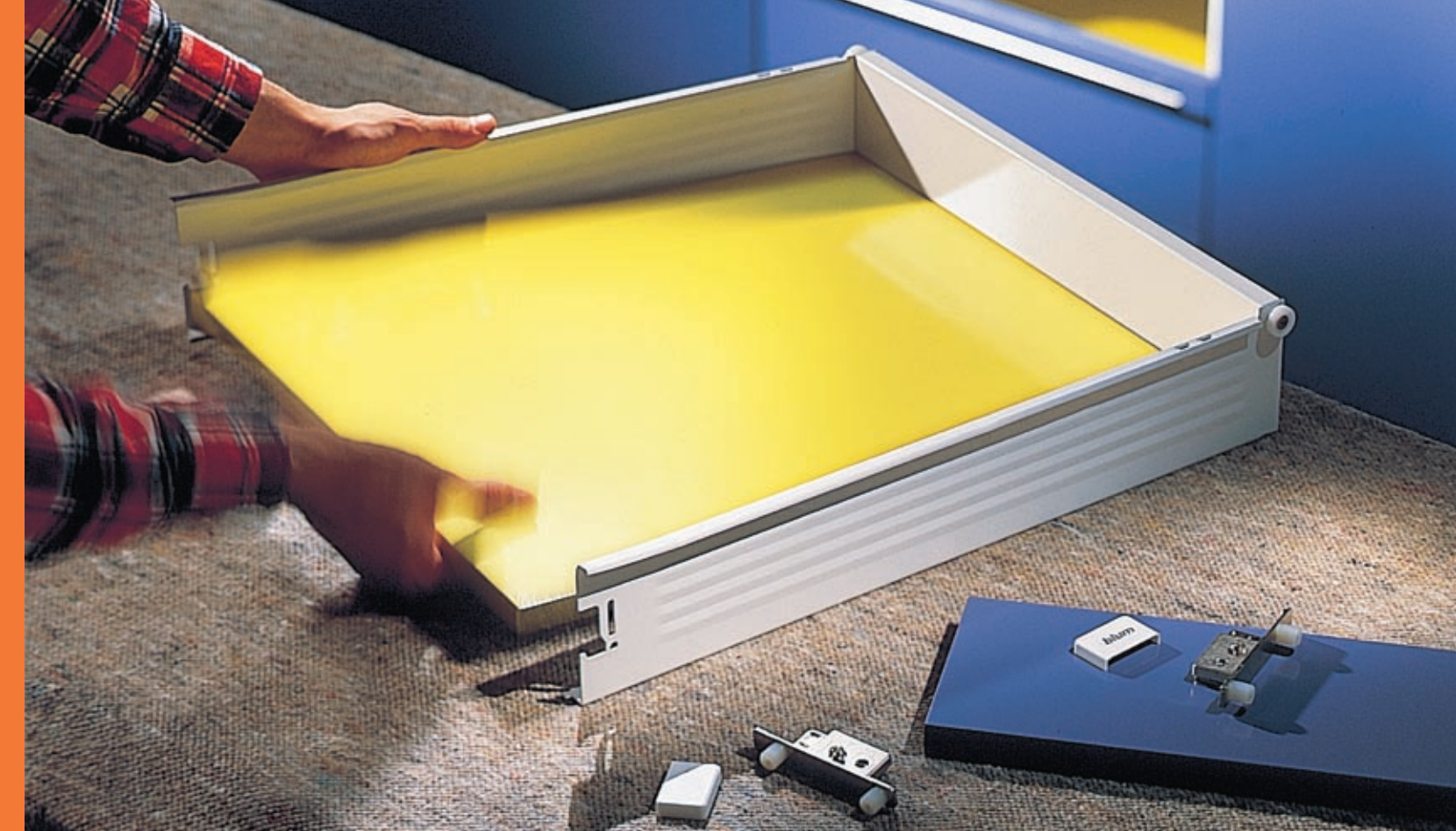

## **METABOX quick start**

**The fastest way to build a drawer**







# METABOX: Steps for frame cabinets

## 1. Measure the opening

This will help you in determining which METABOX drawer will work best for the cabinet opening

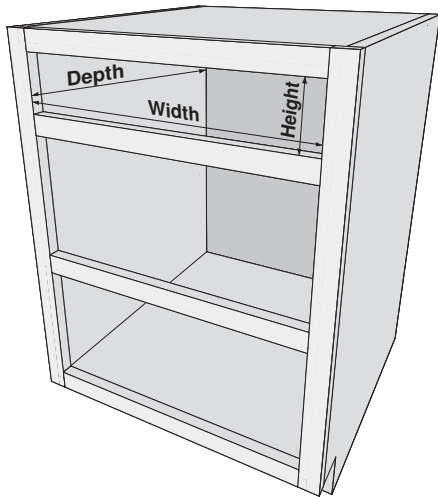

## 2. Determine which METABOX drawer height to use

Choose between the four heights that are offered within the METABOX system

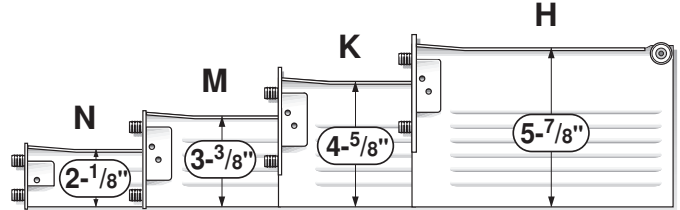

Min. opening height	Available heights			
	N	M	K	H
3-1/16"	Yes	No	No	No
4-5/16"	Yes	Yes	No	No
5-9/16"	Yes	Yes	Yes	No
6-7/8"	Yes	Yes	Yes	Yes

## 3. Determine which METABOX drawer length fits the opening

Choose the correct runner length to best fit the inside depth of the cabinet

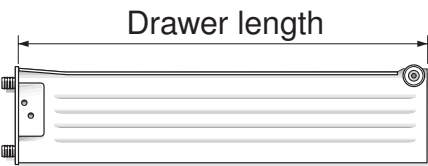

Heights	Available lengths					
	11"	14"	16"	18"	20"	22"
N	No	Yes	Yes	Yes	Yes	Yes
M	Yes	Yes	Yes	Yes	Yes	Yes
K	No	Yes	Yes	Yes	Yes	Yes
H	No	Yes	Yes	Yes	Yes	Yes
Inside depth range	11-5/8" to 13-3/8"	14-1/16" to 16-1/2"	16" to 18-7/16"	18-13/16" to 20-1/4"	19-15/16" to 22-3/8"	21-15/16" to 24-3/8"

## 4. Cut the bottom and back components

No matter what the material or the size of the cabinets, components can be cut and drilled quickly for easy assembly (minimum 13mm material)

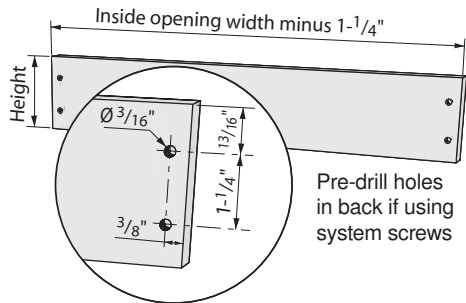
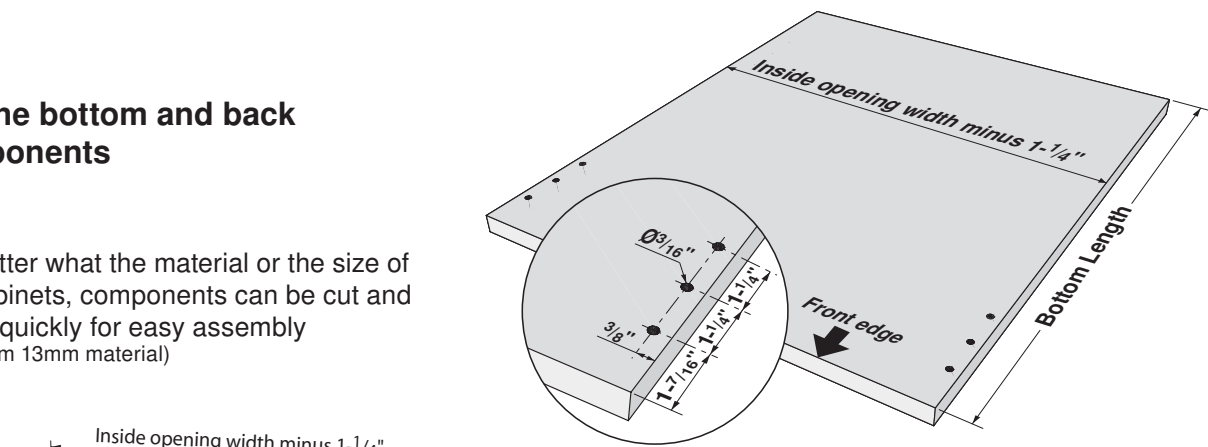

Pre-drill holes in back if using system screws

Heights	Drawer back height		
	1/2" bottom	5/8" bottom	3/4" bottom
N	1-5/8"	1-9/16"	1-7/16"
M	2-15/16"	2-13/16"	2-11/16"
K	4-3/16"	4-1/16"	3-15/16"
H	5-7/16"	5-5/16"	5-3/16"

Drawer bottom length	
Runner length	Bottom length
22"	21-9/16"
20"	19-5/8"
18"	17-5/8"
16"	15-11/16"
14"	13-11/16"
11"	10-9/16"

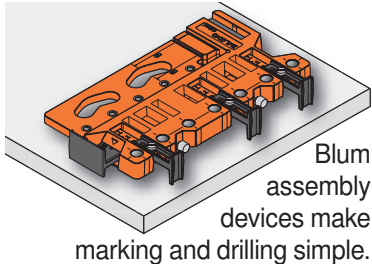

Blum assembly devices make marking and drilling simple.

## 5. Determine front fixing bracket locations

Use the tables below to easily locate the center of the bottom fixing point

Side overlay	Screw or drilling location
1/2"	13/16"
9/16"	7/8"
5/8"	15/16"
11/16"	1"
3/4"	1-1/16"

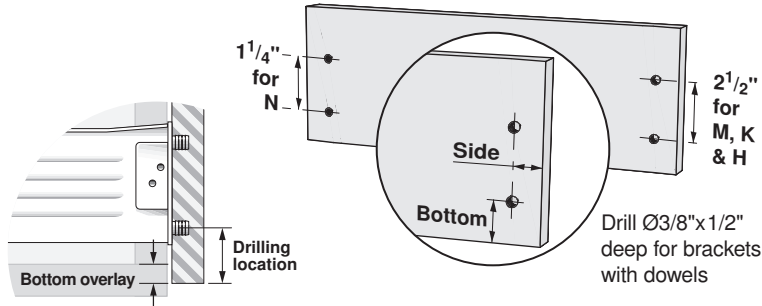

Bottom overlay	Screw or drilling location		
	N and M	K	H
1/2"	1"	2-5/16"	3-9/16"
9/16"	1-1/16"	2-3/8"	3-5/8"
5/8"	1-3/16"	2-7/16"	3-11/16"
11/16"	1-1/4"	2-1/2"	3-3/4"
3/4"	1-5/16"	2-9/16"	3-13/16"

These drilling locations are directly related to the profile locations in step 7

## 6. Assemble the drawer

Assembly is made easy with the METABOX C15 drawer system

- 1 - Place drawer bottom on pins
- 2 - Attach drawer back with screws
- 3 - Install front fixing brackets and attach front to drawer sides

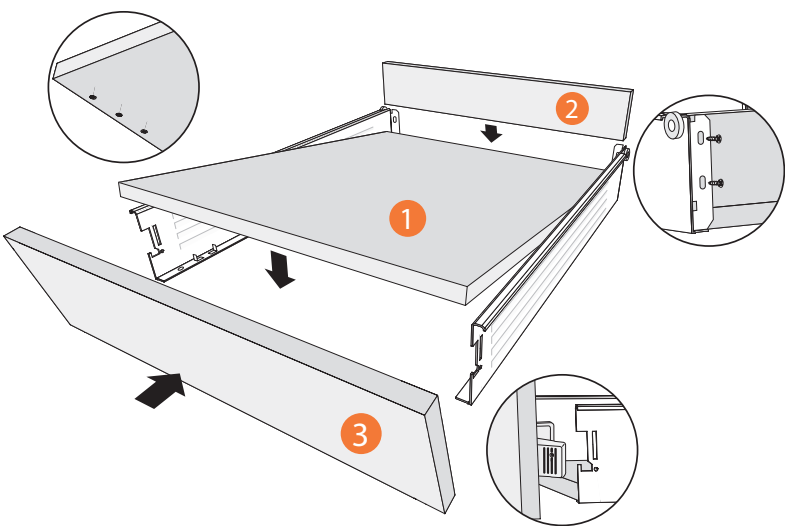

## 7. Mount the cabinet profiles

Attach the cabinet profiles and rear mount sockets to the cabinet

Heights	Runner mounting position	Socket mounting position
N	2-5/8"	1-3/8"
M	3-15/16"	2-11/16"
K	5-3/16"	3-15/16"
H	6-7/16"	5-3/16"

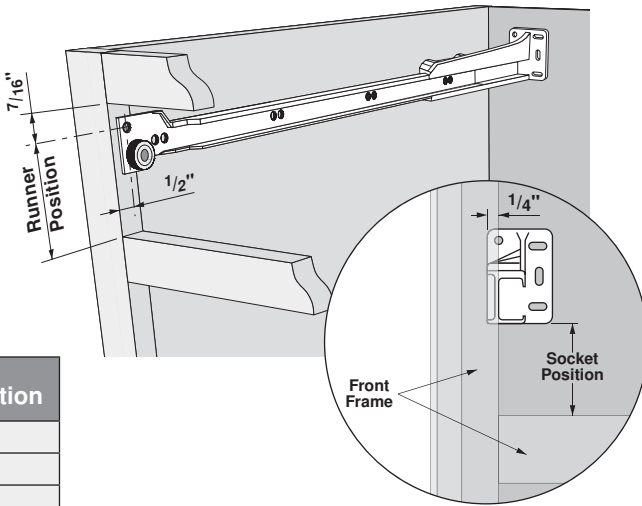

## 8. Install the drawer

Now that the drawer is built and the cabinet profiles are in place, the drawer can be inserted. Final side and height adjustments can be made via the front fixing brackets.

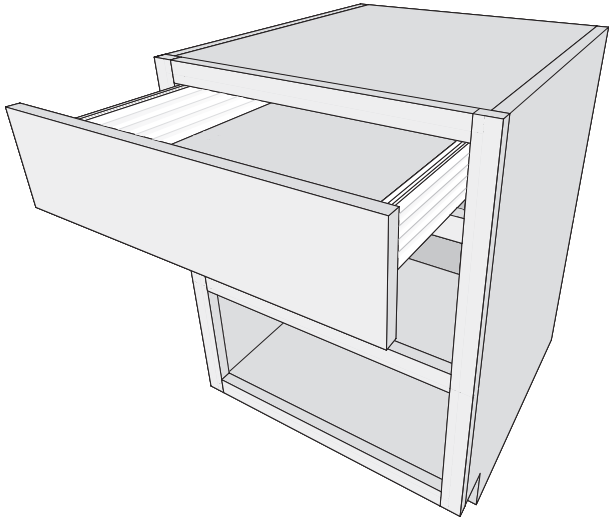

Dimensions in Inches



# Fast, easy and accurate

Building a drawer  
has never been  
this simple

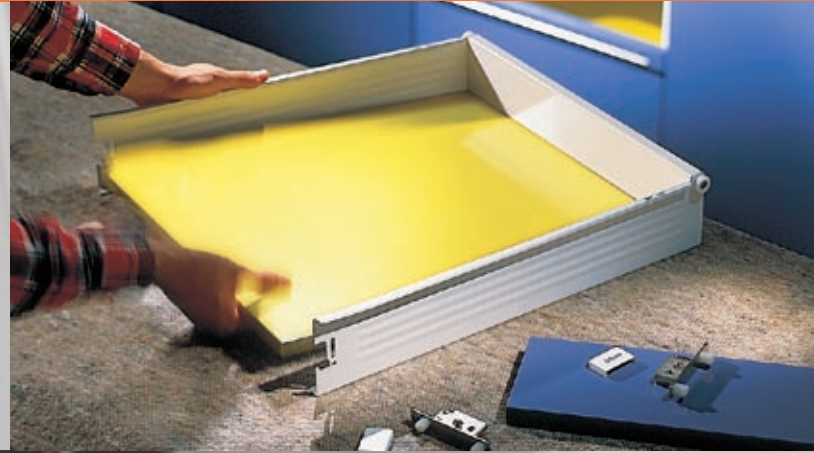

No joinery, glue or  
clamping required



Quick assembly  
and quality all in  
one system



Drill mounting holes, assemble drawer,  
attach clip-on front fixing brackets,  
insert drawer into cabinet and you are  
done.

Drawer front at-  
tachment made  
easy





# METABOX: Steps for frameless cabinets

## 1. Measure the opening

This will help you in determining which METABOX drawer will work best for the cabinet opening

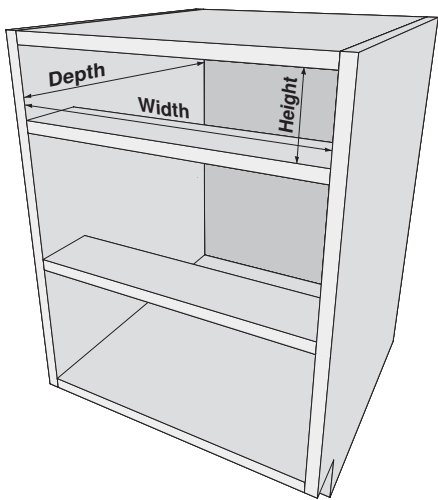

## 2. Determine which METABOX drawer height to use

Choose between the four heights that are offered within the METABOX system

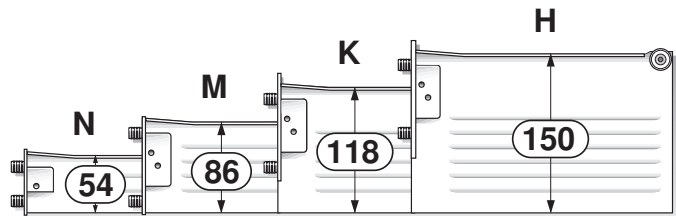

Min. opening height	Available heights			
	N	M	K	H
78	Yes	No	No	No
110	Yes	Yes	No	No
142	Yes	Yes	Yes	No
174	Yes	Yes	Yes	Yes

## 3. Determine which METABOX drawer length fits the opening

Choose the correct runner length to best fit the inside depth of the cabinet

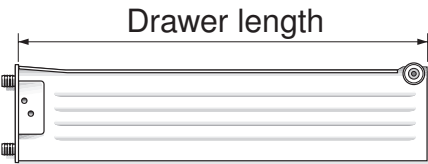

Heights	Available lengths					
	270	350	400	450	500	550
N	No	Yes	Yes	Yes	Yes	Yes
M	Yes	Yes	Yes	Yes	Yes	Yes
K	No	Yes	Yes	Yes	Yes	Yes
H	No	Yes	Yes	Yes	Yes	Yes
Min. inside depth	277	357	407	457	507	557



## 4. Cut the bottom and back components

No matter what the material or the size of the cabinets, components can be cut and drilled quickly for easy assembly (minimum 13mm material)

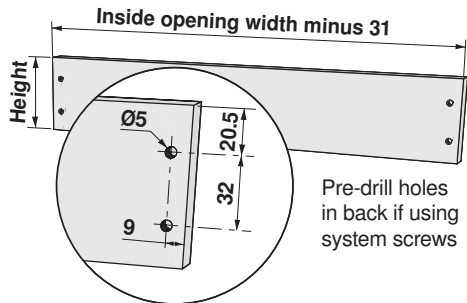
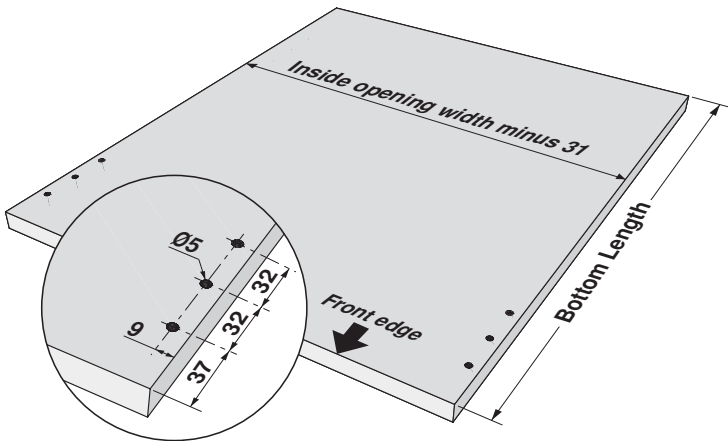

Heights	Drawer backs		
	13mm bottoms	16mm bottoms	19mm bottoms
N	42	39	36
M	74	71	68
K	106	103	100
H	138	135	132

Drawer bottoms	
Runner length	Bottom length
550	548
500	498
450	448
400	398
350	348
270	268

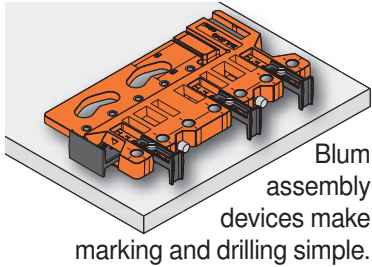

## 5. Determine front fixing bracket locations

Use the tables below to easily locate the center of the bottom fixing point

Side overlay	Screw or drilling location
13	21.5
14	22.5
16	24.5
17.5	26
19	27.5

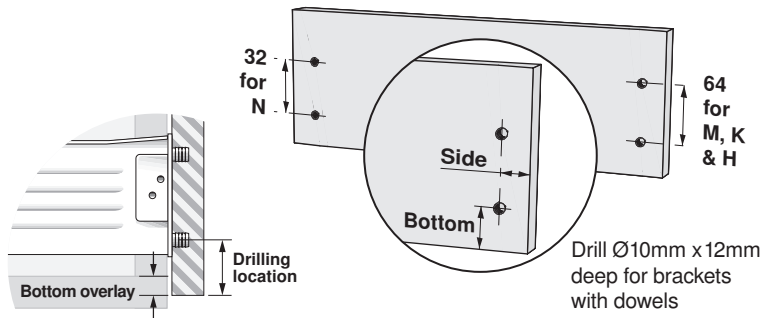

Bottom overlay	Screw or drilling location		
	N and M	K	H
13	26.5	58.5	90.5
14	27.5	59.5	91.5
16	29.5	61.5	93.5
17.5	31	63	95
19	32.5	64.5	96.5

These drilling locations are directly related to the profile locations in step 7

## 6. Assemble the drawer

Assembly is made easy with the METABOX C15 drawer system

- 1 - Place drawer bottom on pins
- 2 - Attach drawer back with screws
- 3 - Install front fixing brackets and attach front to drawer sides

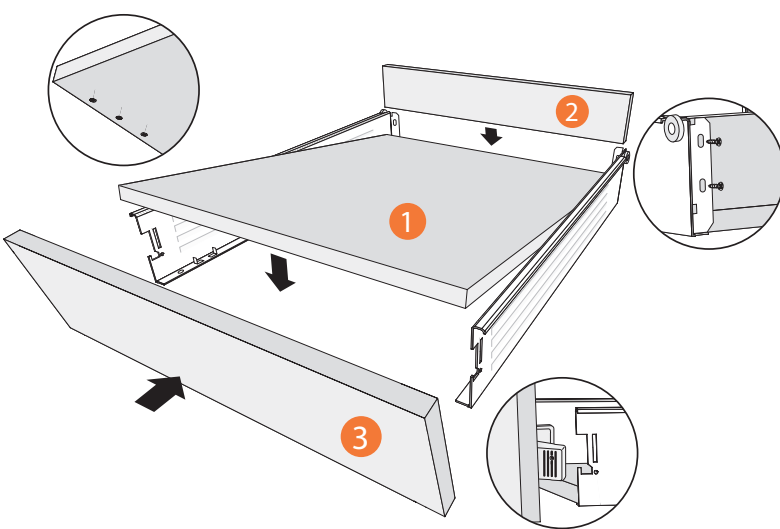

## 7. Mount the cabinet profiles

Attach the cabinet profiles to the cabinet

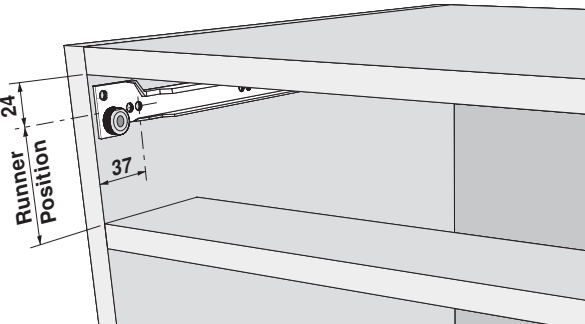

Heights	Mounting position
N	54
M	86
K	118
H	150

## 8. Install the drawer

Now that the drawer is built and the cabinet profiles are in place, the drawer can be inserted. Final side and height adjustments can be made via the front fixing brackets.

