



METABOX

A drawer system with endless possibilities

Perfecting motion  **blum**[®]

Table of contents



Blum, Inc. is a leading manufacturer of functional hardware for the kitchen cabinet and commercial casegoods industries specializing in concealed hinges and drawer runner systems. Virtually all of the hardware needed to assemble and make casegoods functional are available within the wide range of quality Blum products.

Blum's manufacturing and distribution complex in Stanley, North Carolina supplies the North American markets through a network of more than 150 dependable distributors. Wholly owned by the Blum family, the company was formed in 1952 by Julius Blum and is headquartered in Hoechst, Austria.

Global customer benefits

Product development at Blum considers all of the various customers who will come in contact with our products. With this "Global Customer Benefits" philosophy we strive to create advantages for all users from the cabinetmaker to the end consumer.



Blum, Inc. is ISO 9001 certified which means that you are assured of consistent quality in every Blum product. What's more they exceed the requirements of ANSI-BHMA standards for cycle life, static load and self-closing performance. Contact your local Blum representative for more details.

	Page
METABOX drawer system	3
General specifications	4-5
320N specifications	6-7
320M specifications	8-9
320K specifications	10-11
320H specifications	12-13
330M specifications	14-15
330H specifications	16-17
Gallery rail and BOXSIDE specifications	18-21
Interior roll-out specifications	22-27
METAFILE for METABOX	28
METABOX lateral stabilizer	29
METABOX pull-out surround specifications	30
Accessories	31-32
Assembly tools	33-37
Drawer front overlay charts	38
Part number index	39

Blum testing criteria

Cycle life / Dynamic load capacity test

100,000 open/close cycles with a total weight of **34kg** (75 lb.) on a **550mm** (22") drawer.

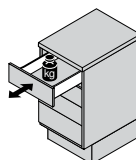

Side pressure test

A force of **15kg** (33 lb.) is applied ten times to a fully extended **550mm** (22") drawer.

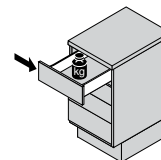

Static load capacity test

45.3kg (100 lb.) applied to a half extended **550mm** (22") drawer for 1 minute.

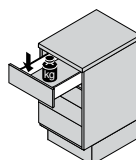

METABOX drawer systems exceed ANSI/BHMA requirements for a Grade 1 rating.

METABOX: The versatile drawer system

Efficient storage in contemporary styling

The spacious layout of this kitchen permits a variety of customized storage solutions. From the largest pot to the smallest bottle, everything has a place in the METABOX program. And with the durable epoxy-coated drawer sides, this kitchen will keep its good looks for years to come.

Virtually unlimited storage solutions are possible with the range of heights, lengths and optional accessories in the METABOX program. Within this comprehensive system, everything stored is easy to access and even small or bulky items are handled with ease.

METABOX's design complements the style of frameless cabinetry that has gained popularity because of its effective use of cabinetry interior room. Since it is fully compatible with the 32mm cabinet construction system, the METABOX program makes installation quick and precise.



Drawer fronts are quickly and easily mounted.



Adjustments are fast, precise and simple.



Tilt adjustment by turning the gallery rails.



Gallery cross rails are easily secured into position.



METABOX general specifications

Cabinet types and capacity

The METABOX drawer system can be installed in either panel or face-frame constructed cabinets with optional rear mounting sockets.

METABOX drawers have a static load capacity of 100 pounds and a dynamic capacity of 75 pounds and are tested to perform 100,000 open/close cycles without failure.

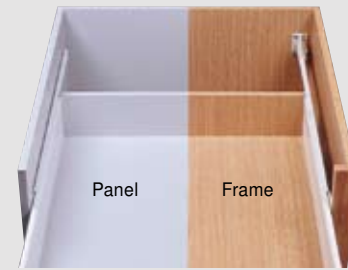

METABOX drawers install in all cabinets



Example of METABOX load capacity

Available heights and colors

METABOX is available in four drawer heights, offering a multitude of design options. "C" drawers are available in cream or white, while "C15" drawers are available in white only.

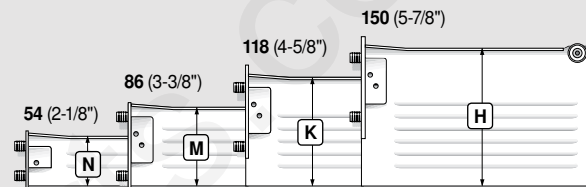
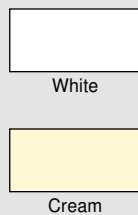

Opening and closing information

BLUMATIC self-closing action results from the angled drawer and cabinet profiles.

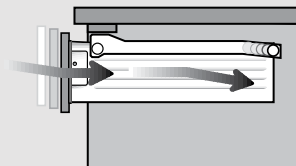

320 series 3/4 extension drawers have an extension loss when fully opened.

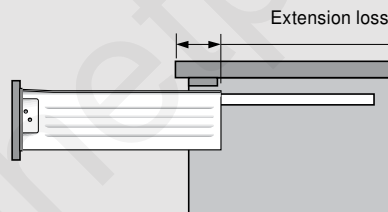

330 series full extension drawers have an over extension of 18 (3/4") when fully opened.

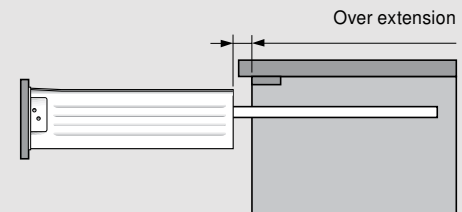

"C" version and the "C15" version

Assembling METABOX "C" drawers is quick and easy.

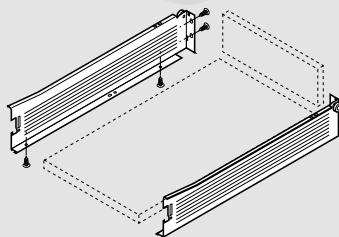

METABOX "C" version

METABOX "C15" drawers can be manually assembled (page 30), or with the METABOX drilling guide (page 28).

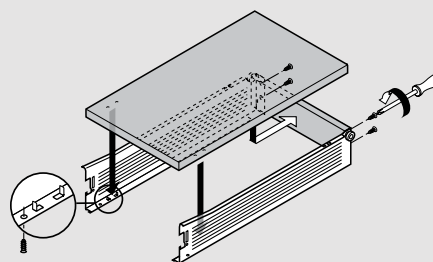

METABOX "C15" version

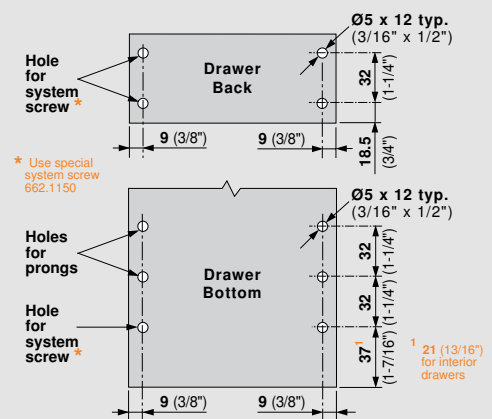

Boring for C15 drawer back and bottom (for 13 (1/2") material, holes are 10 (3/8") deep)

Drawer Configurations

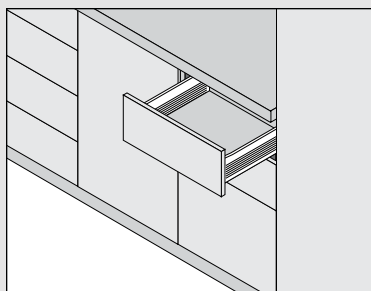

Standard drawer

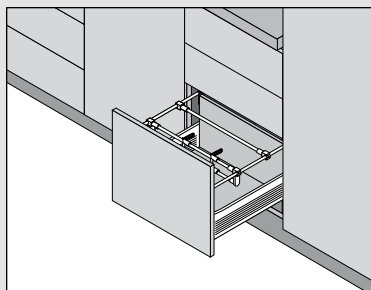

Standard drawer with gallery organization

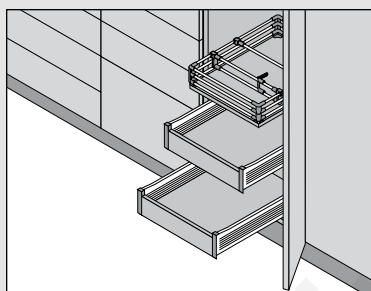

Pull-out surround shelf (top)
Interior roll-out trays (bottom)

Components and accessories

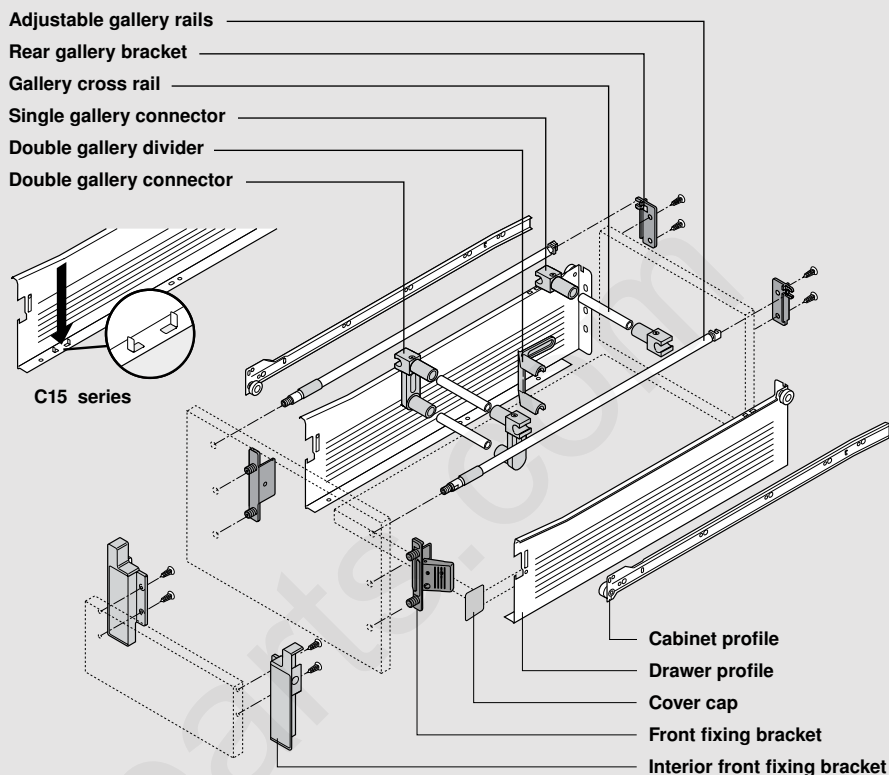

Interior drawer front assembly

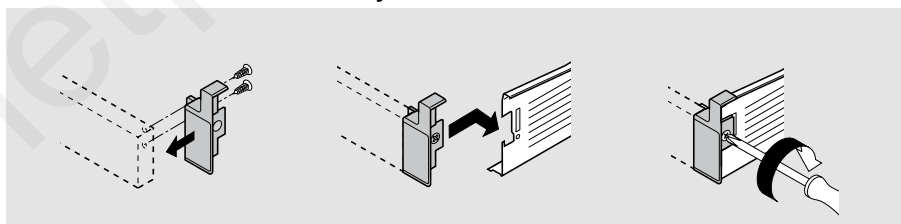

Drawer front assembly

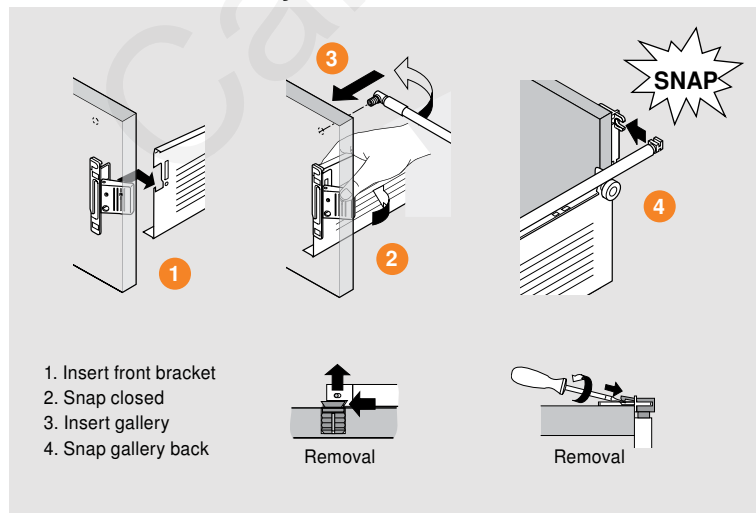

Drawer front adjustment

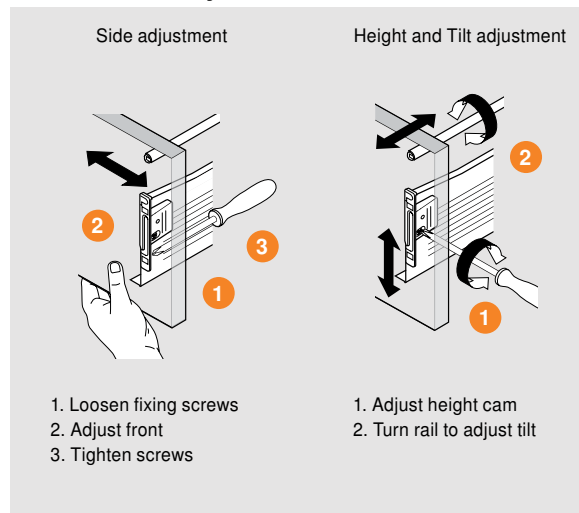

METABOX 320N drawer series

Drawer components

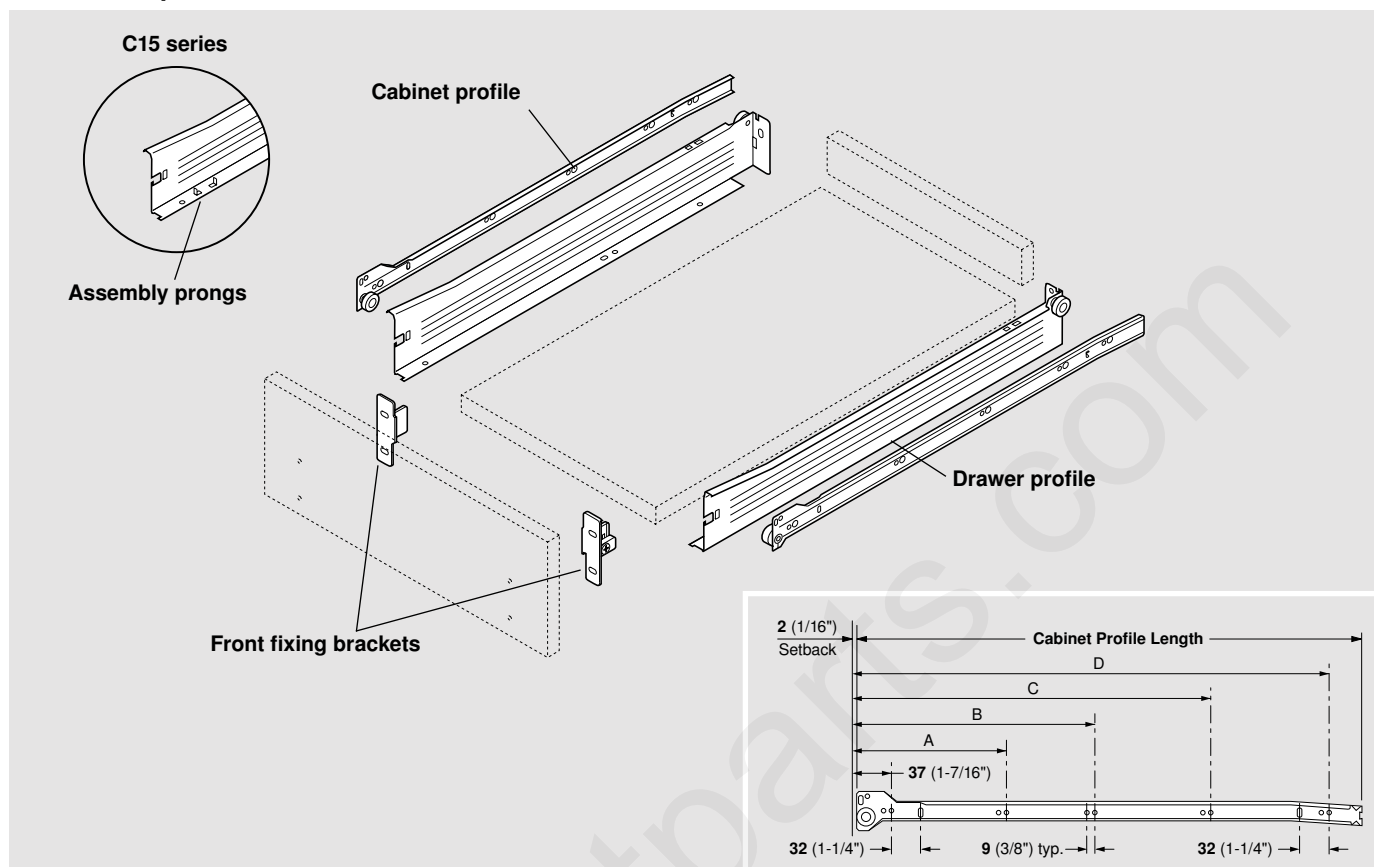

Runner sets (includes cabinet and drawer profiles)

C series cream or white	C15 series white	Nominal Length	Min. cabinet Inside depth	Cabinet & drawer Profile length	System screw mounting hole positions			
					A	B	C	D
320N5500C	320N5500C15	(22")	557 (21-7/8")	550 (21-5/8")	165 (6-1/2")	261 (10-1/4")	389 (15-5/16")	517 (20-3/8")
320N5000C	320N5000C15	(20")	507 (19-15/16")	500 (19-11/16")	165 (6-1/2")	261 (10-1/4")	389 (15-5/16")	453 (17-13/16")
320N4500C	320N4500C15	(18")	457 (17-15/16")	450 (17-11/16")	165 (6-1/2")	261 (10-1/4")	389 (15-5/16")	-
320N4000C	320N4000C15	(16")	407 (16")	400 (15-3/4")	165 (6-1/2")	261 (10-1/4")	357 (14-1/16")	-
320N3500C	320N3500C15	(14")	357 (14")	350 (13-3/4")	165 (6-1/2")	261 (10-1/4")	325 (12-13/16")	-
320N2700C		(11")	277 (10-7/8")	270 (10-5/8")	229 (9")	-	-	-

Standard front fixing bracket

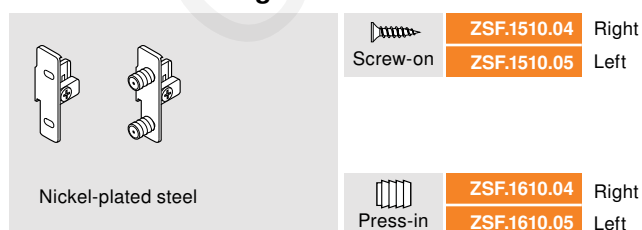

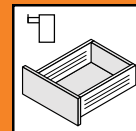

Component specifications

Pre-bore holes for use with
METABOX C15. $\varnothing 5 \times 10$
($3/16'' \times 3/8''$) holes for
13 (1/2'') material

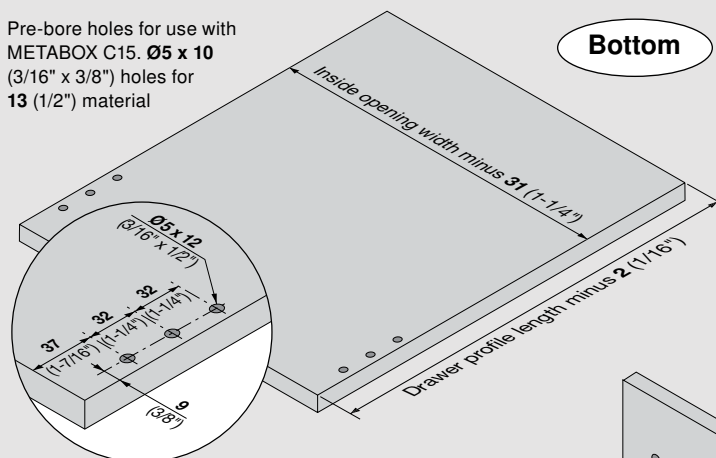

Bottom

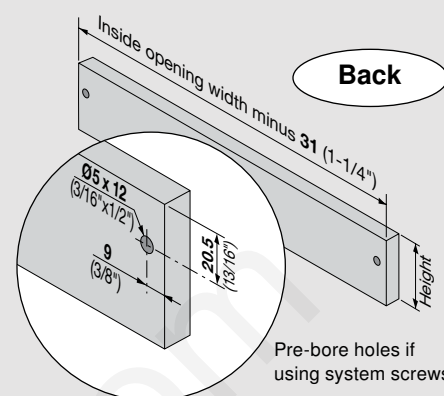

Back

Pre-bore holes if
using system screws

Profile length	Bottom length
550 (21-5/8'')	548 (21-9/16'')
500 (19-11/16'')	498 (19-5/8'')
450 (17-11/16'')	448 (17-5/8'')
400 (15-3/4'')	398 (15-11/16'')
350 (13-3/4'')	348 (13-11/16'')
270 (10-5/8'')	268 (10-9/16'')

Front

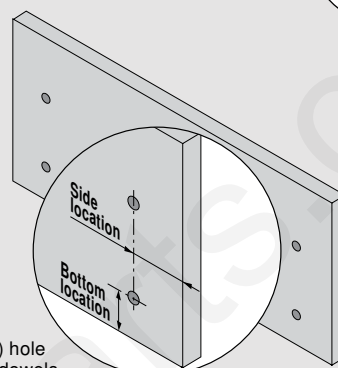

Bore $\varnothing 10 \times 12$ ($\varnothing 3/8'' \times 1/2''$) hole
for front fixing brackets with dowels
(Determine locations from specifications below,
or see page 38 for pre-determined overlays)

Drawer bottom thickness	Back height
13 (1/2'')	42 (1-5/8'')
16 (5/8'')	39 (1-9/16'')
19 (3/4'')	36 (1-7/16'')

Installation specifications

Drawer

Front

Back

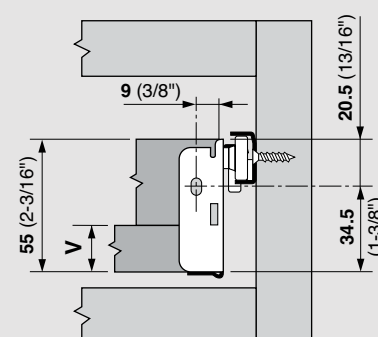
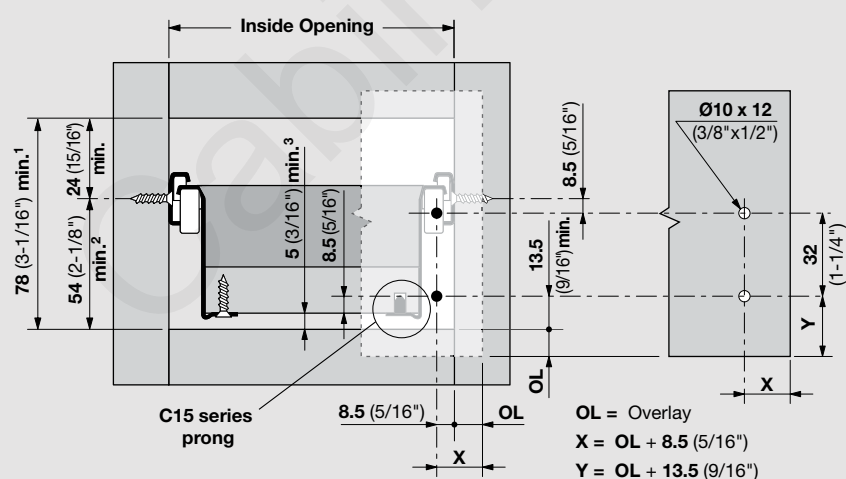

V = Variable bottom thickness
minimum 13(1/2'') material

For frame cabinet specifications please
see page 32

For gallery rail and BOXSIDE
specifications see page 19

For interior drawer specifications
see page 22

METABOX 320M drawer series

Drawer components

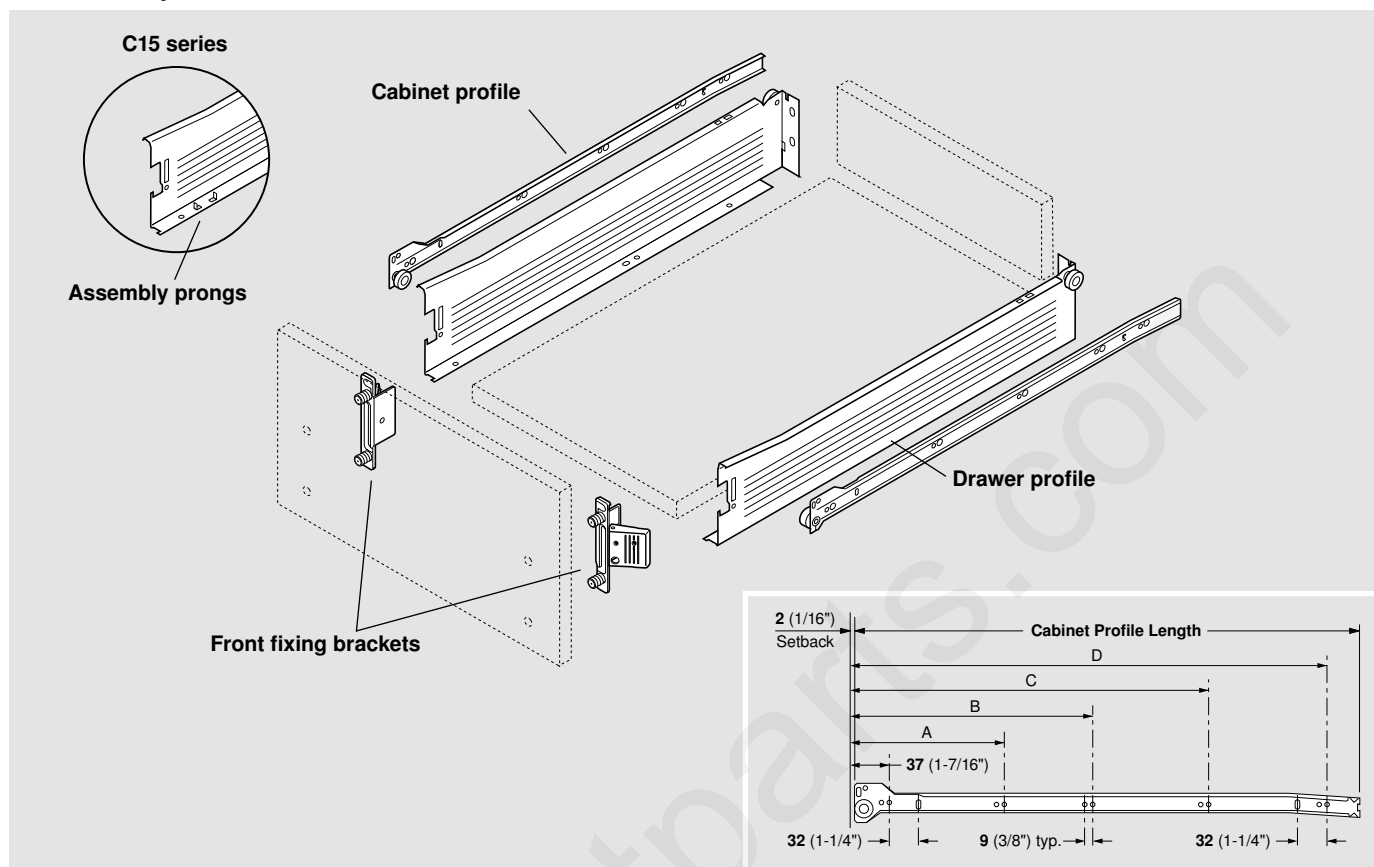

Runner sets (includes cabinet and drawer profiles)

C series cream or white	C15 series white	Nominal Length	Min. cabinet Inside depth	Cabinet & drawer Profile length	System screw mounting hole positions			
					A	B	C	D
320M5500C	320M5500C15	(22")	557 (21-7/8")	550 (21-5/8")	165 (6-1/2")	261 (10-1/4")	389 (15-5/16")	517 (20-3/8")
320M5000C	320M5000C15	(20")	507 (19-15/16")	500 (19-11/16")	165 (6-1/2")	261 (10-1/4")	389 (15-5/16")	453 (17-13/16")
320M4500C	320M4500C15	(18")	457 (17-15/16")	450 (17-11/16")	165 (6-1/2")	261 (10-1/4")	389 (15-5/16")	-
320M4000C	320M4000C15	(16")	407 (16")	400 (15-3/4")	165 (6-1/2")	261 (10-1/4")	357 (14-1/16")	-
320M3500C	320M3500C15	(14")	357 (14")	350 (13-3/4")	165 (6-1/2")	261 (10-1/4")	325 (12-13/16")	-
320M2700C	320M2700C15	(11")	277 (10-7/8")	270 (10-5/8")	229 (9")	-	-	-

Standard front fixing bracket

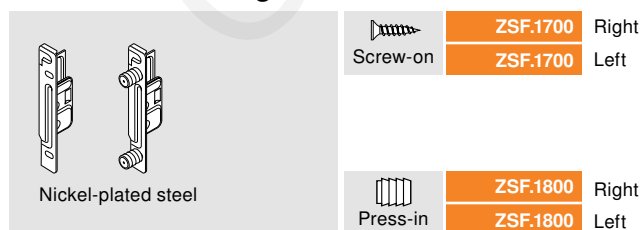

Clip-on front fixing bracket

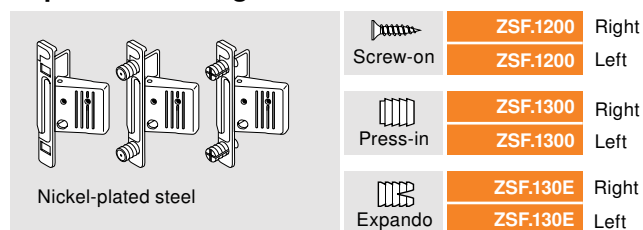

ZAA.3500 Cover cap

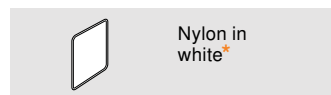

ZAA.3700 Cover cap

*Blum logo cover caps available

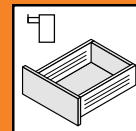

Component specifications

Pre-bore holes for use with
METABOX C15. $\varnothing 5 \times 10$
(3/16" x 3/8") holes for
13 (1/2") material

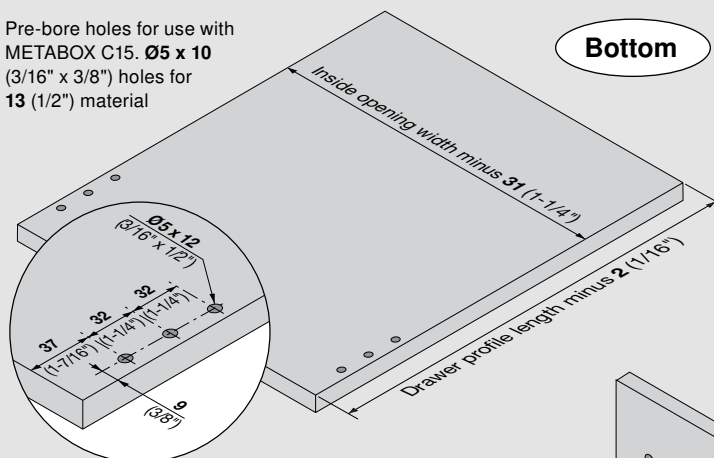

Profile length	Bottom length
550 (21-5/8")	548 (21-9/16")
500 (19-11/16")	498 (19-5/8")
450 (17-11/16")	448 (17-5/8")
400 (15-3/4")	398 (15-11/16")
350 (13-3/4")	348 (13-11/16")
270 (10-5/8")	268 (10-9/16")

Bottom

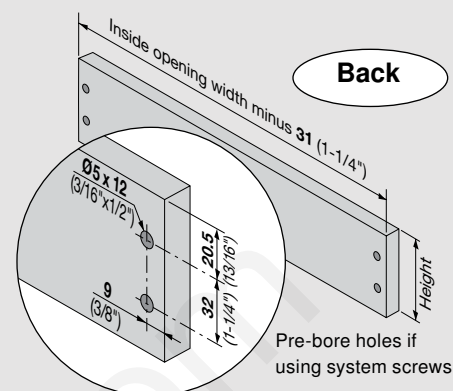

Back

Material thickness	Back height
13 (1/2")	74 (2-15/16")
16 (5/8")	71 (2-13/16")
19 (3/4")	68 (2-11/16")

Front

Bore $\varnothing 10 \times 12$ ($\varnothing 3/8" \times 1/2"$) hole
for front fixing brackets with dowels
(Determine locations from specifications below,
or see page 38 for pre-determined overlays)

Installation specifications

Drawer

Front

Back

For frame cabinet specifications please
see page 32

For gallery rail and BOXSIDE
specifications see page 19

For interior drawer specifications
see page 23

METABOX 320K drawer series

Drawer components

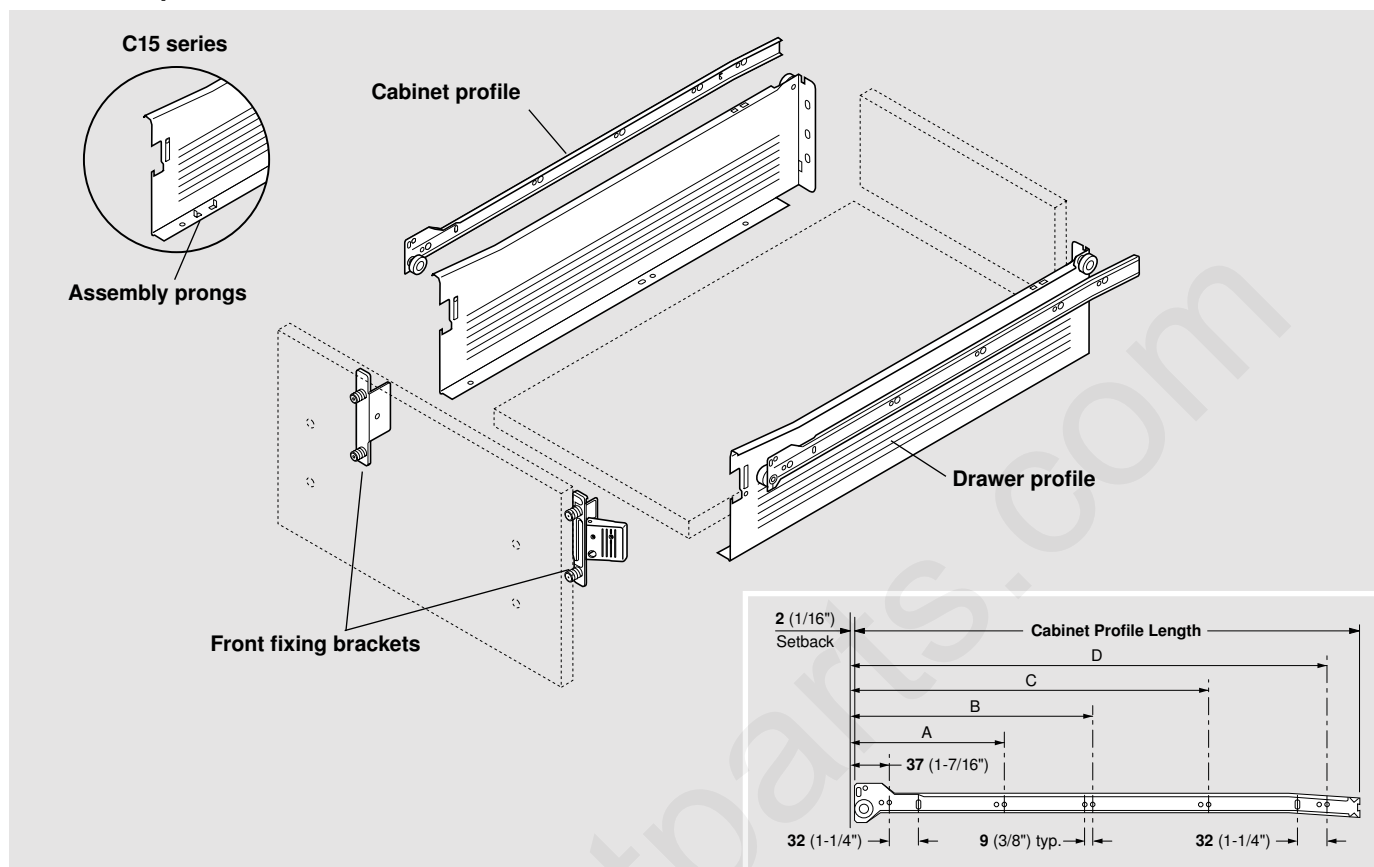

Runner sets (includes cabinet and drawer profiles)

C series cream or white	C15 series white	Nominal Length	Min. cabinet Inside depth	Cabinet & drawer Profile length	System screw mounting hole positions			
					A	B	C	D
320K5500C	320K5500C15	(22")	557 (21-7/8")	550 (21-5/8")	165 (6-1/2")	261 (10-1/4")	389 (15-5/16")	517 (20-3/8")
320K5000C	320K5000C15	(20")	507 (19-15/16")	500 (19-11/16")	165 (6-1/2")	261 (10-1/4")	389 (15-5/16")	453 (17-13/16")
320K4500C	320K4500C15	(18")	457 (17-15/16")	450 (17-11/16")	165 (6-1/2")	261 (10-1/4")	389 (15-5/16")	-
320K4000C	320K4000C15	(16")	407 (16")	400 (15-3/4")	165 (6-1/2")	261 (10-1/4")	357 (14-1/16")	-
320K3500C	320K3500C15	(14")	357 (14")	350 (13-3/4")	165 (6-1/2")	261 (10-1/4")	-	-

Standard front fixing bracket

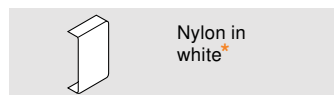
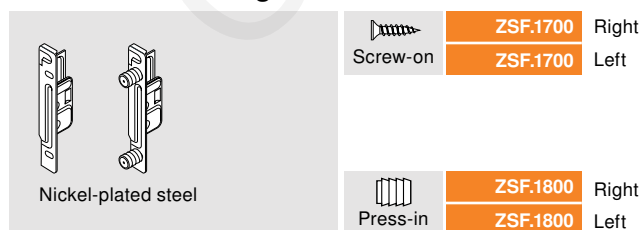

ZAA.3500 Cover cap

Clip-on front fixing bracket

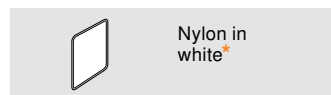
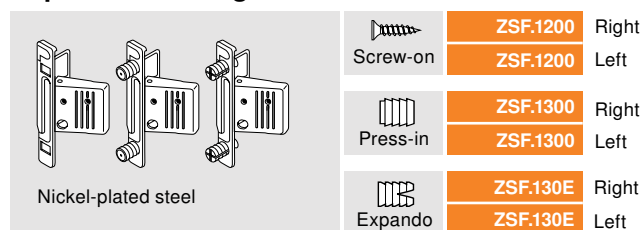

ZAA.3700 Cover cap

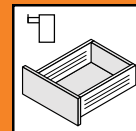

Component specifications

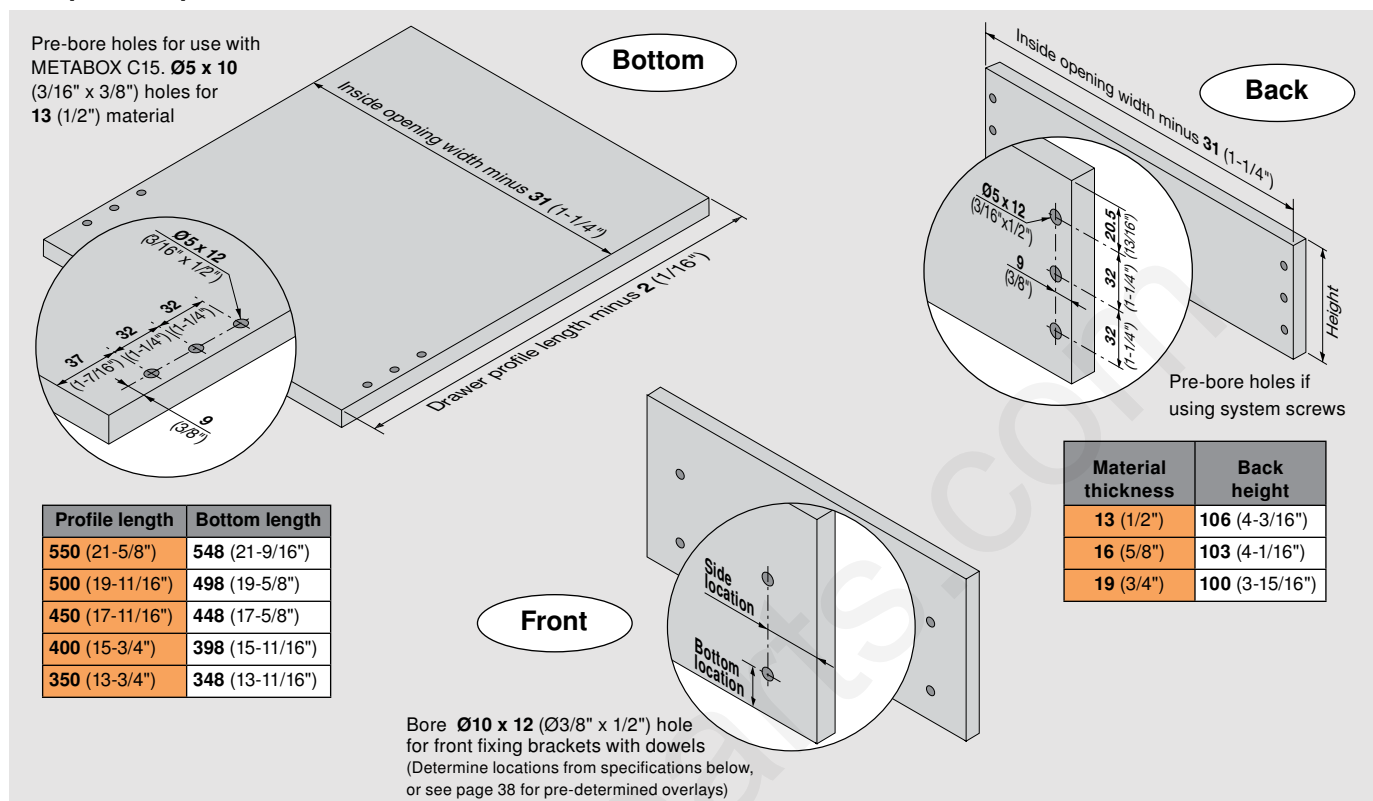

Installation specifications

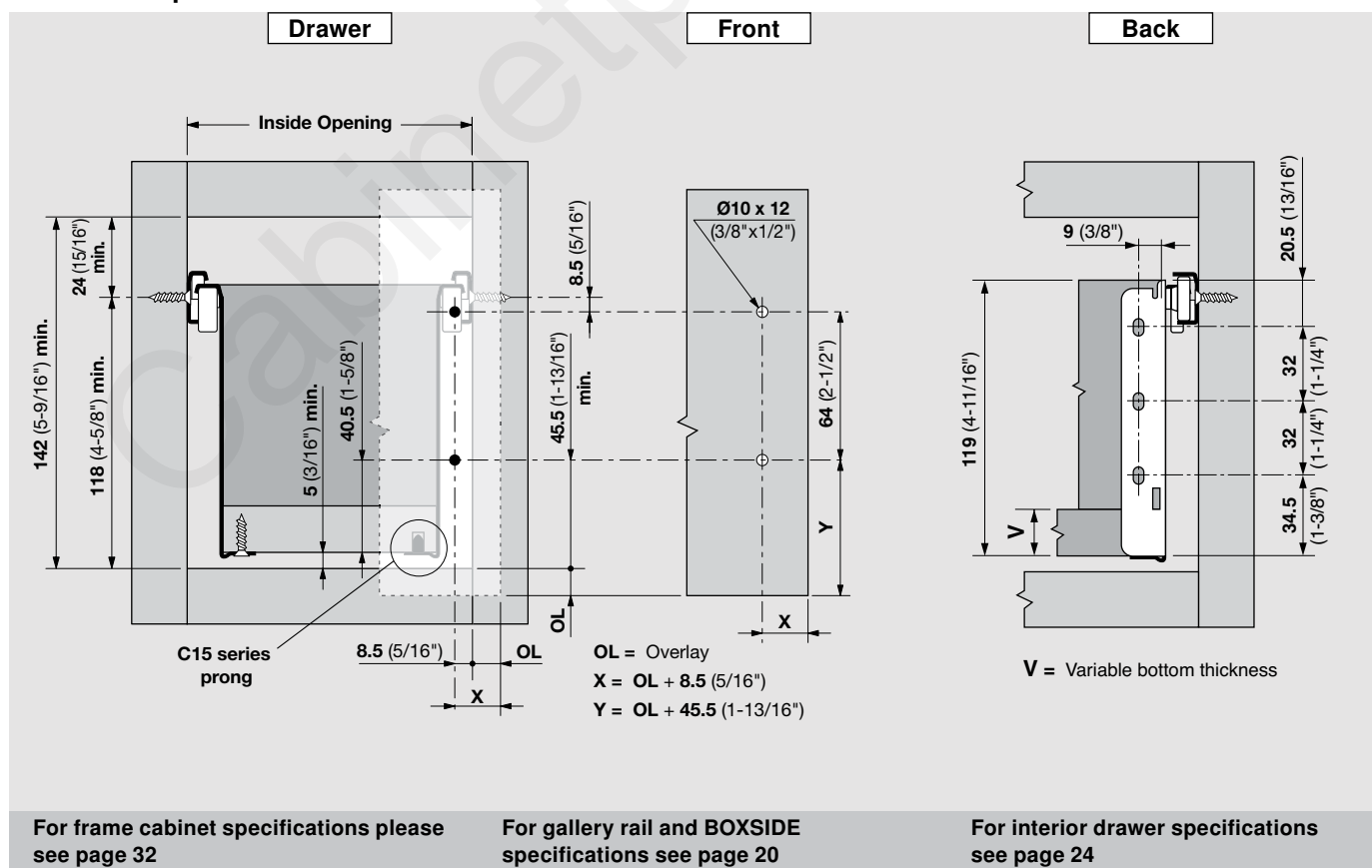

METABOX 320H drawer series

Drawer components

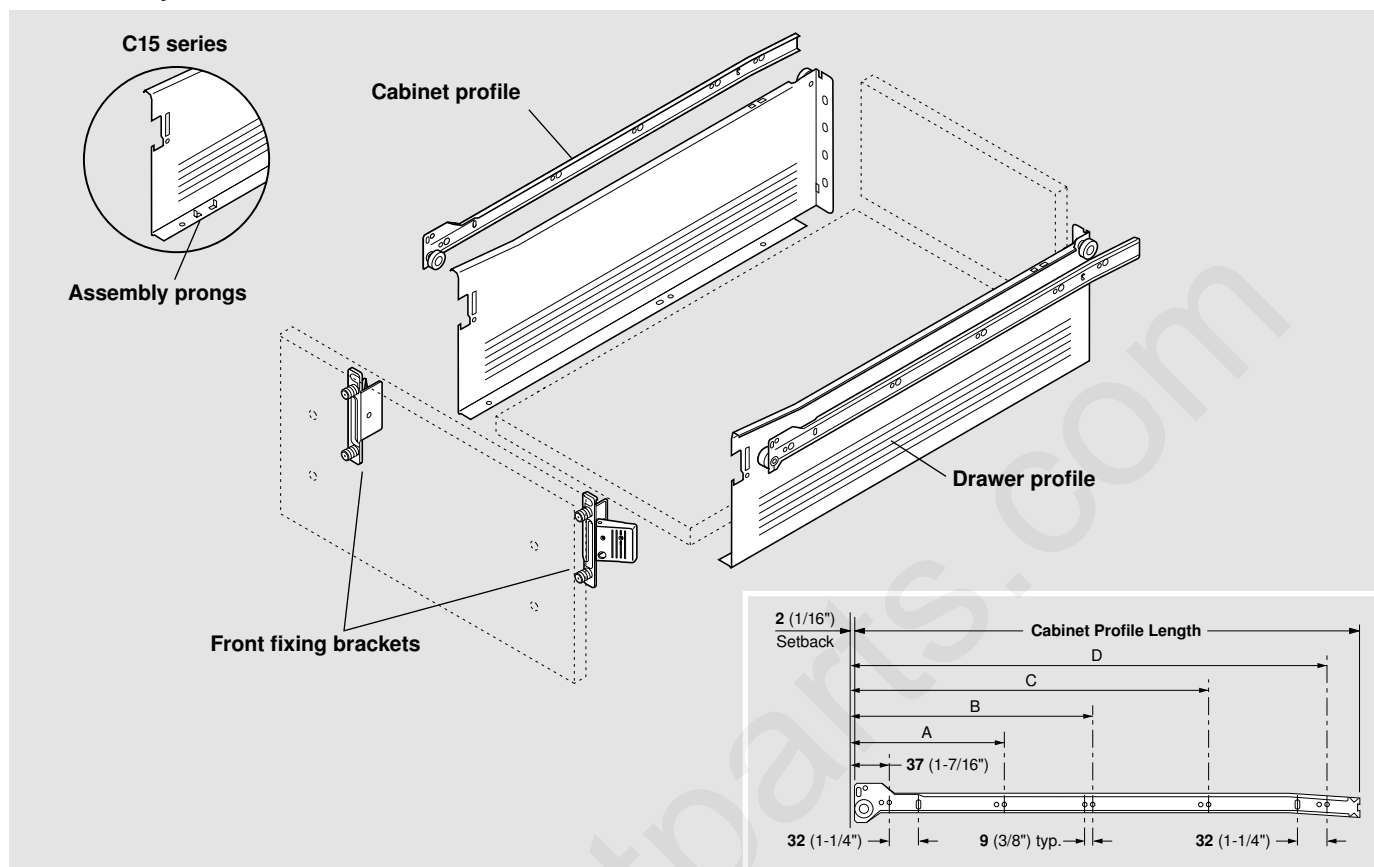

Runner sets (includes cabinet and drawer profiles)

C series cream or white	C15 series white	Nominal Length	Min. cabinet Inside depth	Cabinet & drawer Profile length	System screw mounting hole positions			
					A	B	C	D
320H5500C	320H5500C15	(22")	557 (21-7/8")	550 (21-5/8")	165 (6-1/2")	261 (10-1/4")	389 (15-5/16")	517 (20-3/8")
320H5000C	320H5000C15	(20")	507 (19-15/16")	500 (19-11/16")	165 (6-1/2")	261 (10-1/4")	389 (15-5/16")	453 (17-13/16")
320H4500C	320H4500C15	(18")	457 (17-15/16")	450 (17-11/16")	165 (6-1/2")	261 (10-1/4")	389 (15-5/16")	-
320H4000C	320H4000C15	(16")	407 (16")	400 (15-3/4")	165 (6-1/2")	261 (10-1/4")	357 (14-1/16")	-
320H3500C	320H3500C15	(14")	357 (14")	350 (13-3/4")	165 (6-1/2")	261 (10-1/4")	325 (12-13/16")	-

Standard front fixing bracket

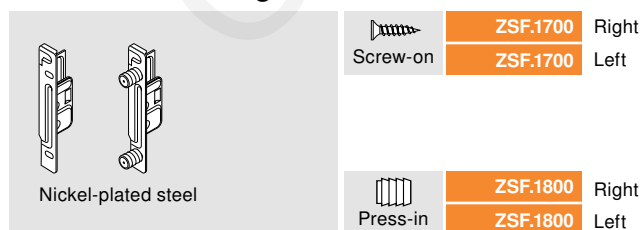

Clip-on front fixing bracket

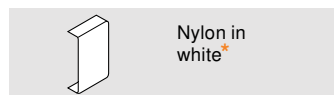
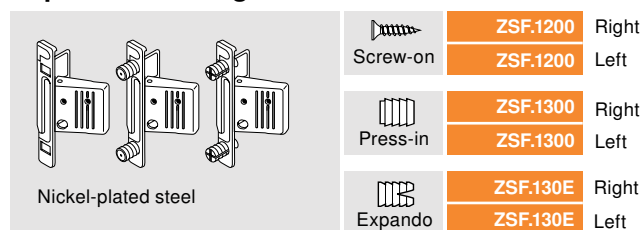

ZAA.3500 Cover cap

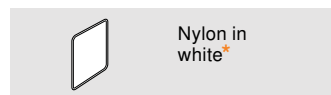

ZAA.3700 Cover cap

*Blum logo cover caps available

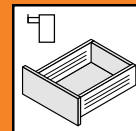

Component specifications

Pre-bore holes for use with
METABOX C15. $\varnothing 5 \times 10$
($3/16'' \times 3/8''$) holes for
13 (1/2'') material

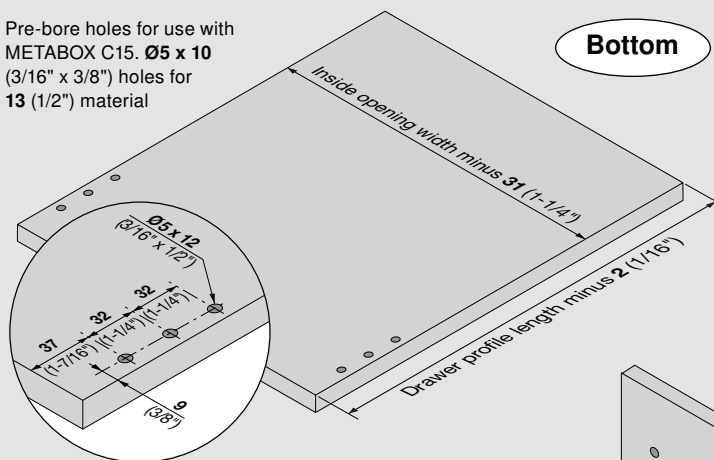

Profile length	Bottom length
550 (21-5/8'')	548 (21-9/16'')
500 (19-11/16'')	498 (19-5/8'')
450 (17-11/16'')	448 (17-5/8'')
400 (15-3/4'')	398 (15-11/16'')
350 (13-3/4'')	348 (13-11/16'')

Bottom

Back

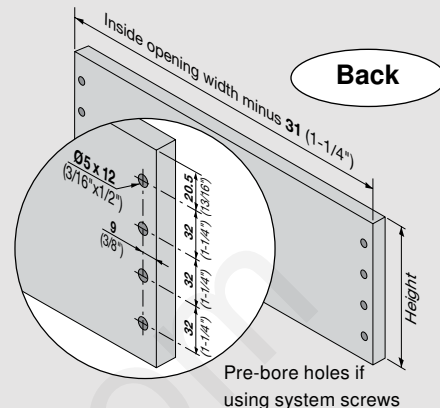

Pre-bore holes if
using system screws

Material thickness	Back height
13 (1/2'')	138 (5-7/16'')
16 (5/8'')	135 (5-5/16'')
19 (3/4'')	132 (5-3/16'')

Front

Bore $\varnothing 10 \times 12$ ($\varnothing 3/8'' \times 1/2''$) hole
for front fixing brackets with dowels
(Determine locations from specifications below,
or see page 38 for pre-determined overlays)

Installation specifications

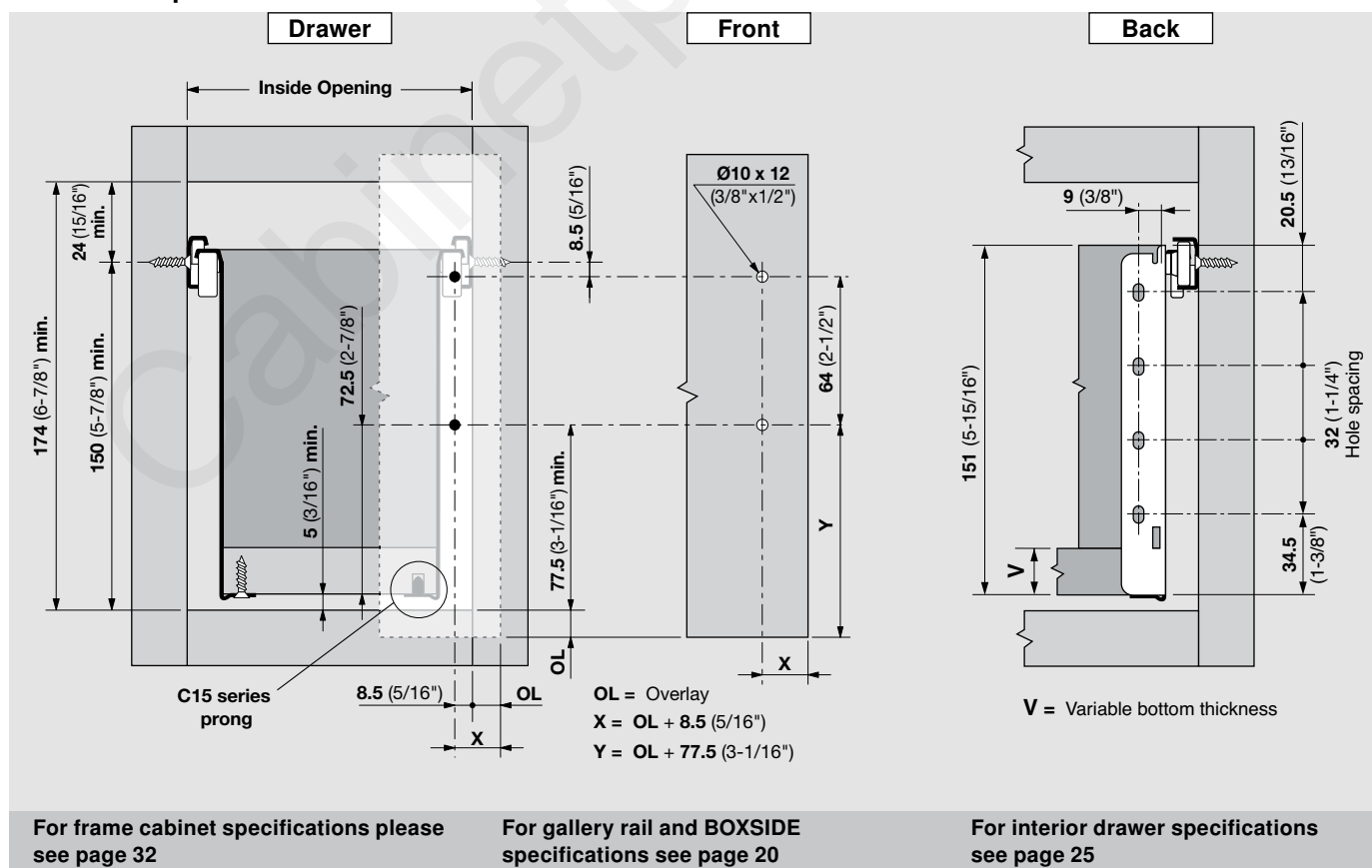

METABOX 330M drawer series

Drawer components

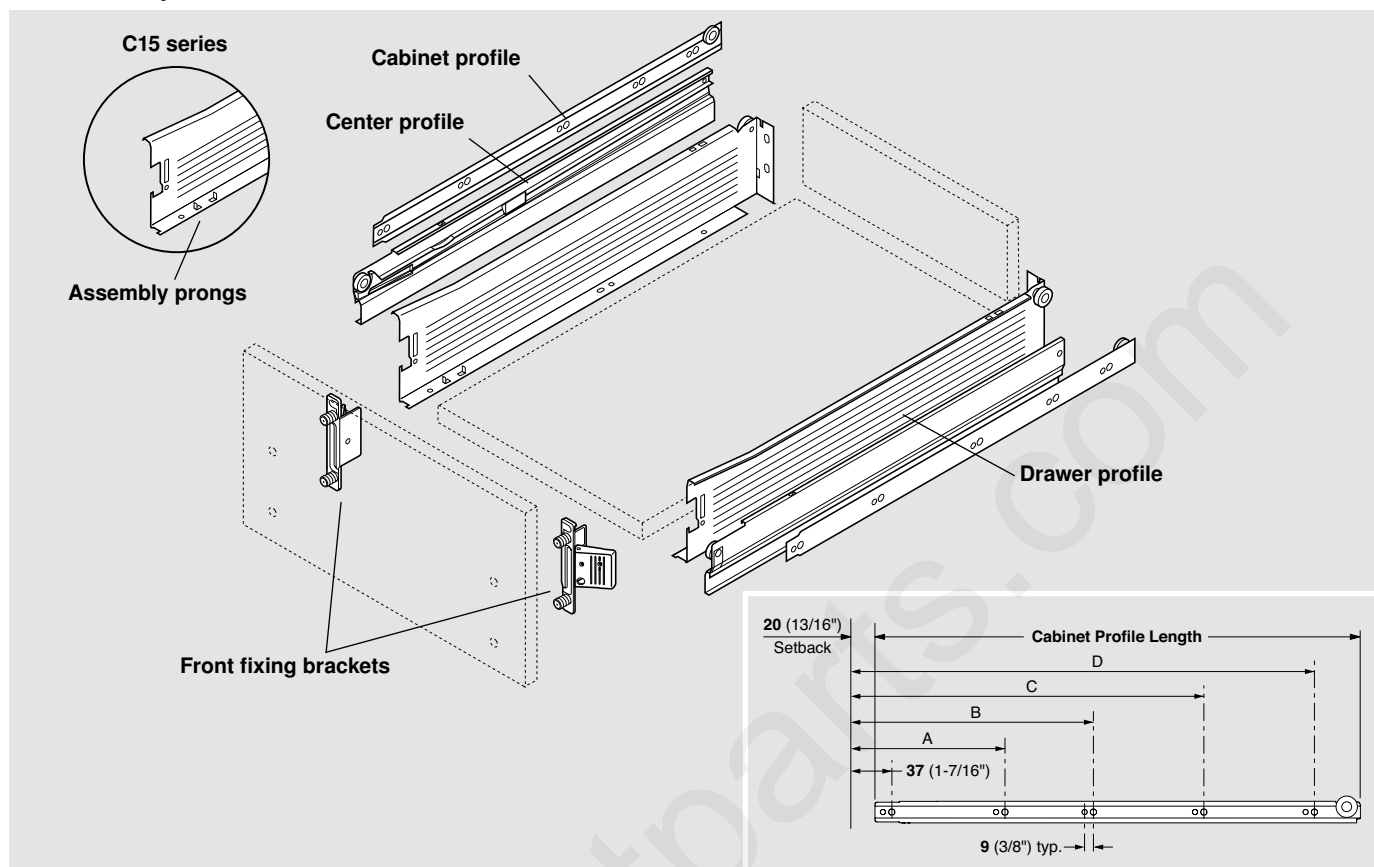

Runner sets (includes cabinet and drawer profiles)

C series cream or white	C15 series white	Nominal Length	Min. cabinet Inside depth	Cabinet & drawer Profile length	System screw mounting hole positions			
					A	B	C	D
330M550PC	330M550PC15	(22")	565 (22-1/4")	550 (21-5/8")	165 (6-1/2")	261 (10-1/4")	389 (15-5/16")	517 (20-3/8")
330M500PC	330M500PC15	(20")	515 (20-1/4")	500 (19-11/16")	165 (6-1/2")	261 (10-1/4")	389 (15-5/16")	453 (17-13/16")
330M450PC	330M450PC15	(18")	465 (18-5/16")	450 (17-11/16")	165 (6-1/2")	261 (10-1/4")	389 (15-5/16")	-
330M400PC	330M400PC15	(16")	415 (16-5/16")	400 (15-3/4")	165 (6-1/2")	261 (10-1/4")	357 (14-1/16")	-

Standard front fixing bracket

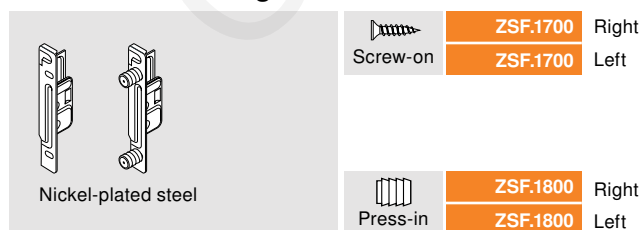

Clip-on front fixing bracket

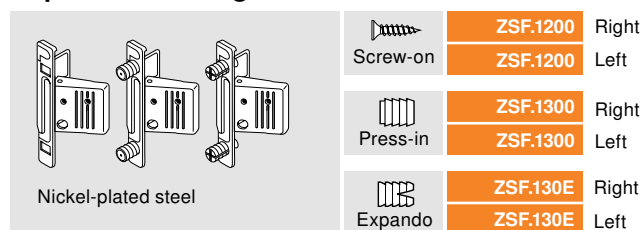

*Blum logo cover caps available

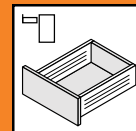

Component specifications

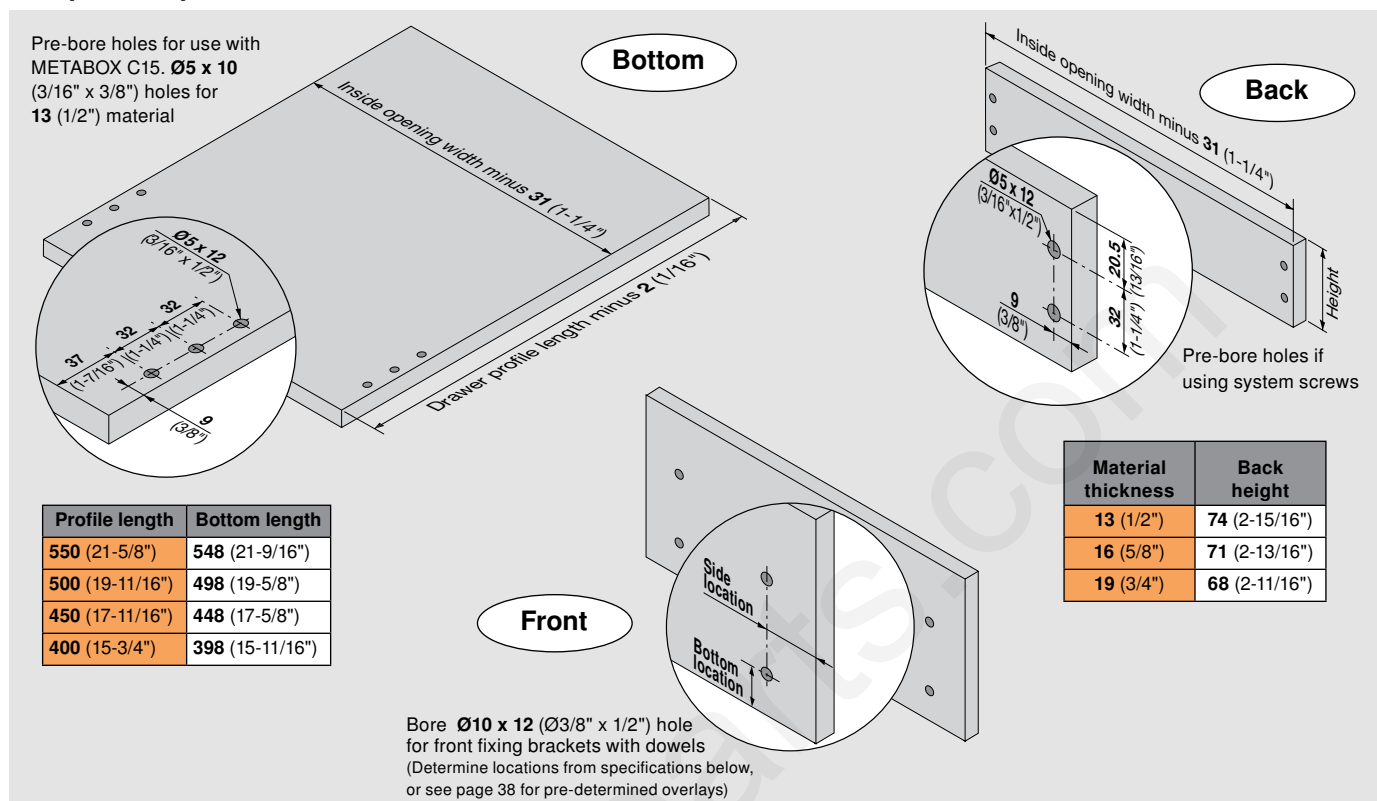

Installation specifications

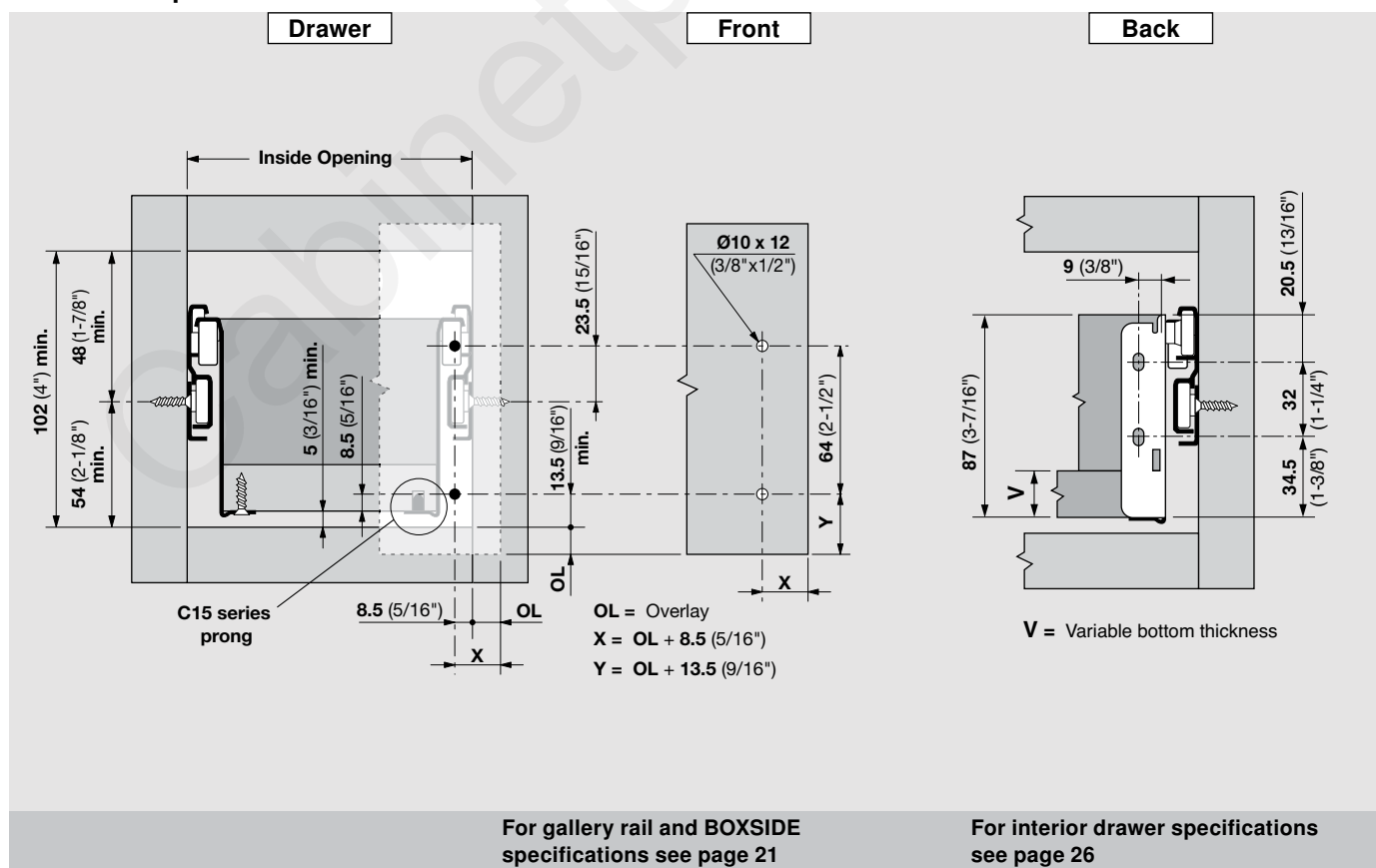

METABOX 330H drawer series

Drawer components

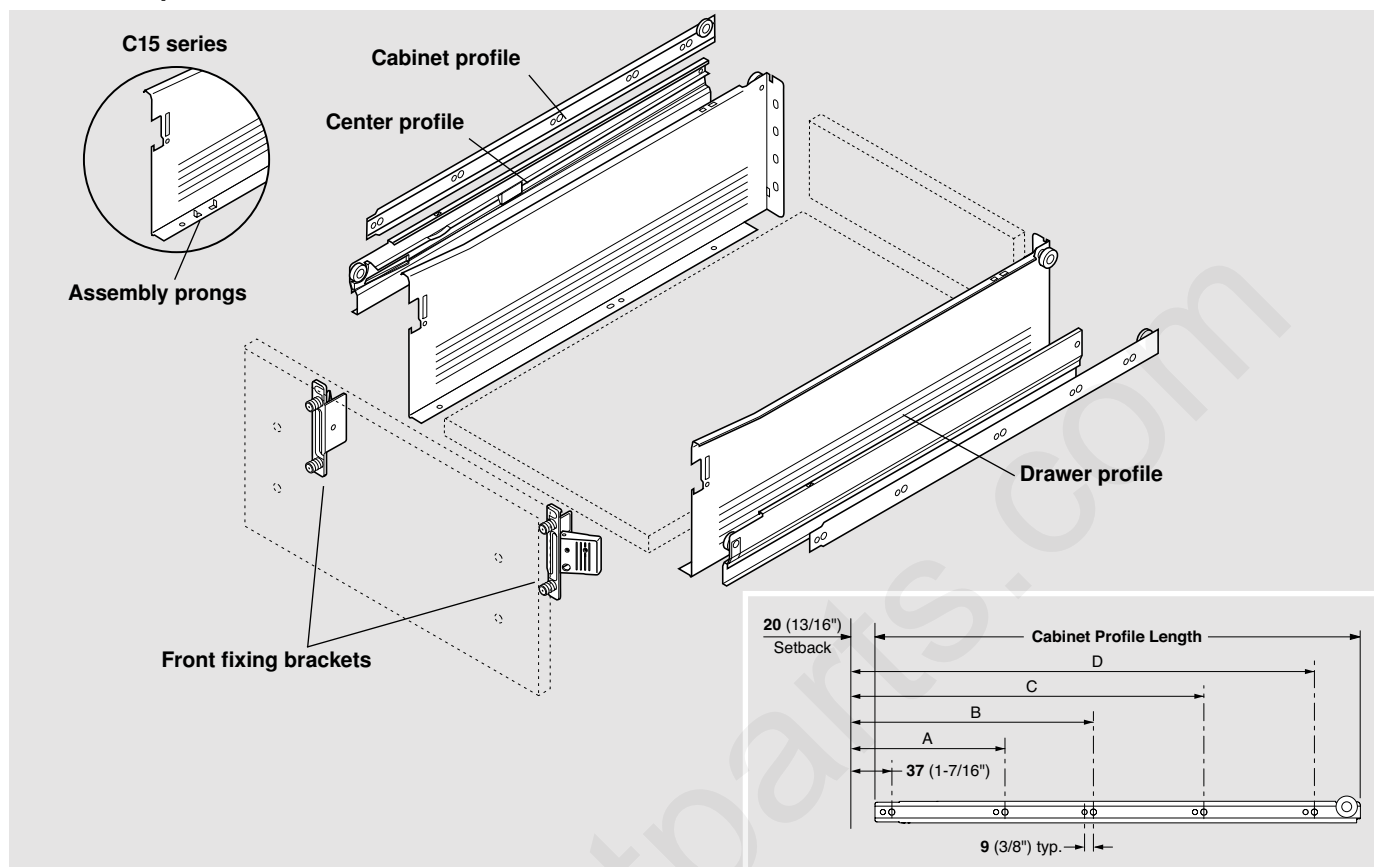

Runner sets (includes cabinet and drawer profiles)

C series cream or white	C15 series white	Nominal Length	Min. cabinet Inside depth	Cabinet & drawer Profile length	System screw mounting hole positions			
					A	B	C	D
330H550PC	330H550PC15	(22")	565 (22-1/4")	550 (21-5/8")	165 (6-1/2")	261 (10-1/4")	389 (15-5/16")	517 (20-3/8")
330H500PC	330H500PC15	(20")	515 (20-1/4")	500 (19-11/16")	165 (6-1/2")	261 (10-1/4")	389 (15-5/16")	453 (17-13/16")
330H450PC	330H450PC15	(18")	465 (18-5/16")	450 (17-11/16")	165 (6-1/2")	261 (10-1/4")	389 (15-5/16")	-
330H400PC	330H400PC15	(16")	415 (16-5/16")	400 (15-3/4")	165 (6-1/2")	261 (10-1/4")	357 (14-1/16")	-

Standard front fixing bracket

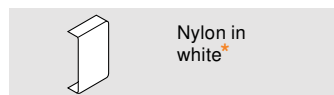
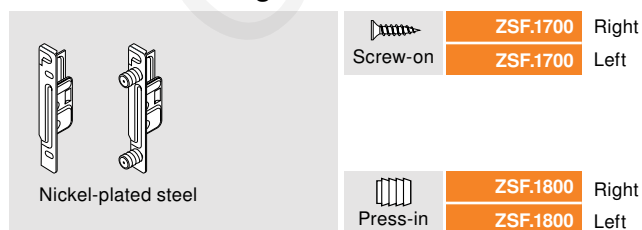

ZAA.3500 Cover cap

Clip-on front fixing bracket

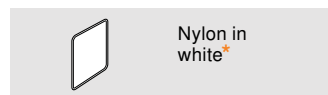
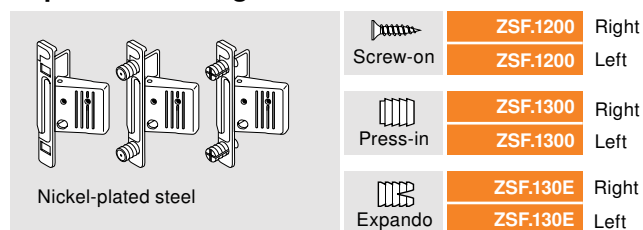

ZAA.3700 Cover cap

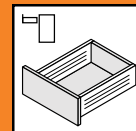

Component specifications

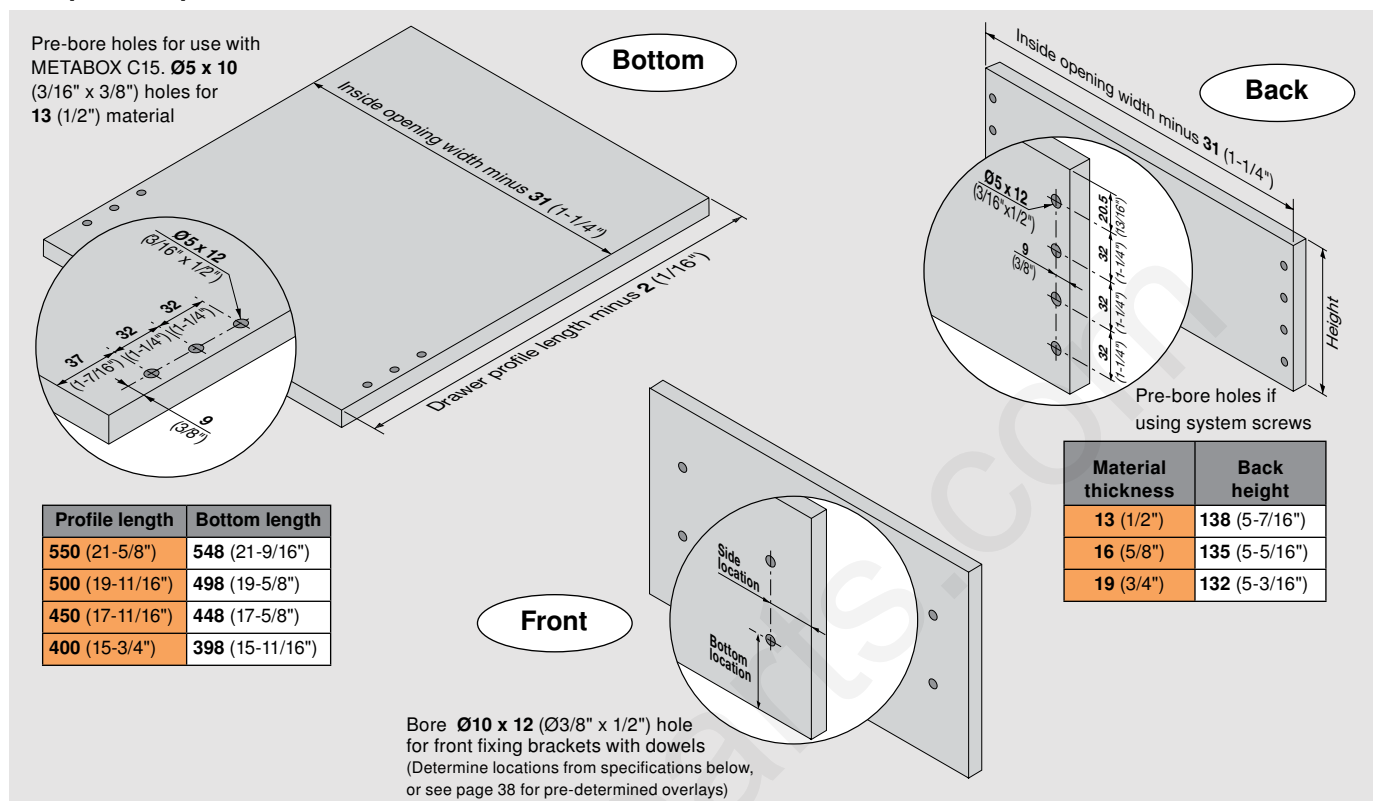

Installation specifications

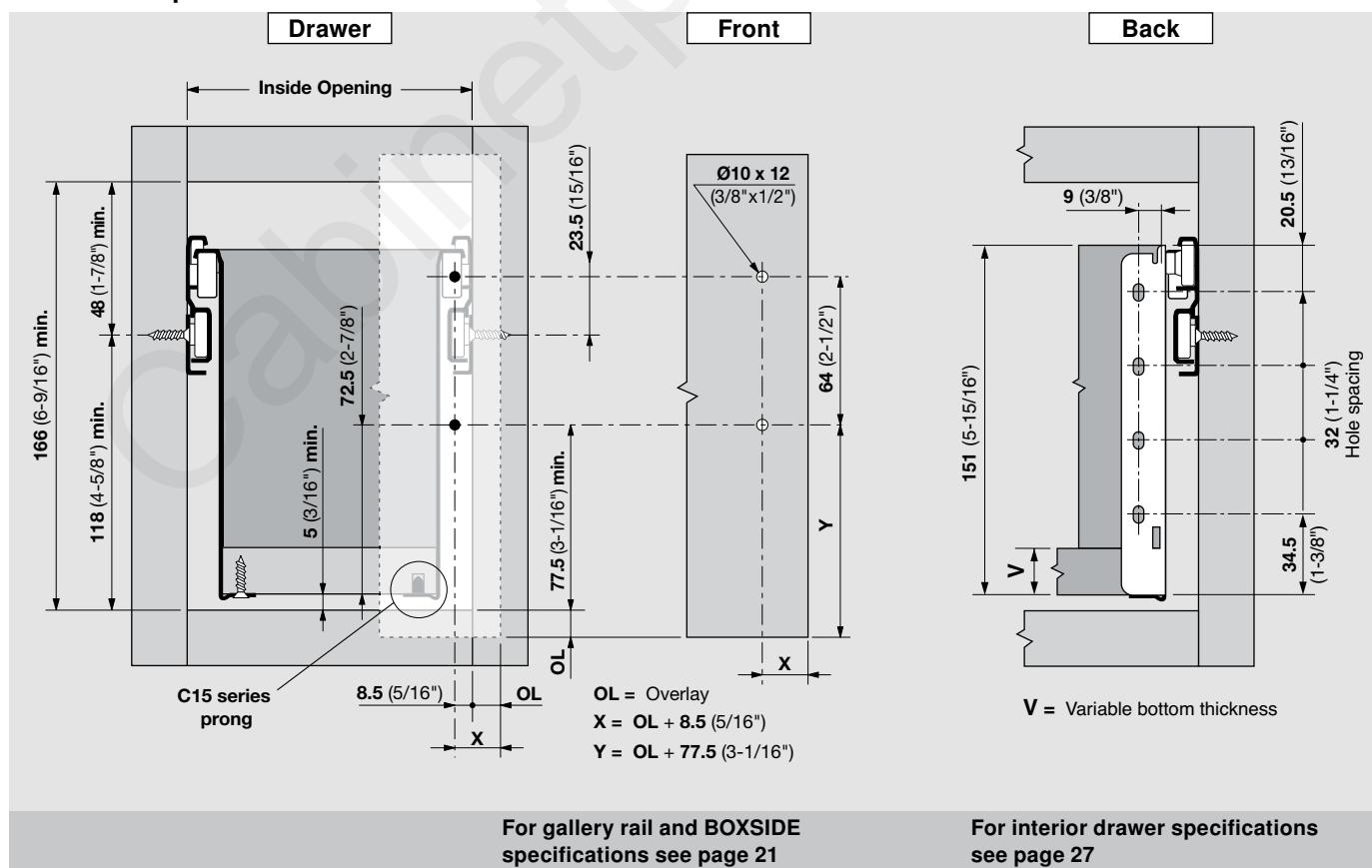

METABOX gallery rail and BOXSIDE systems

Gallery components

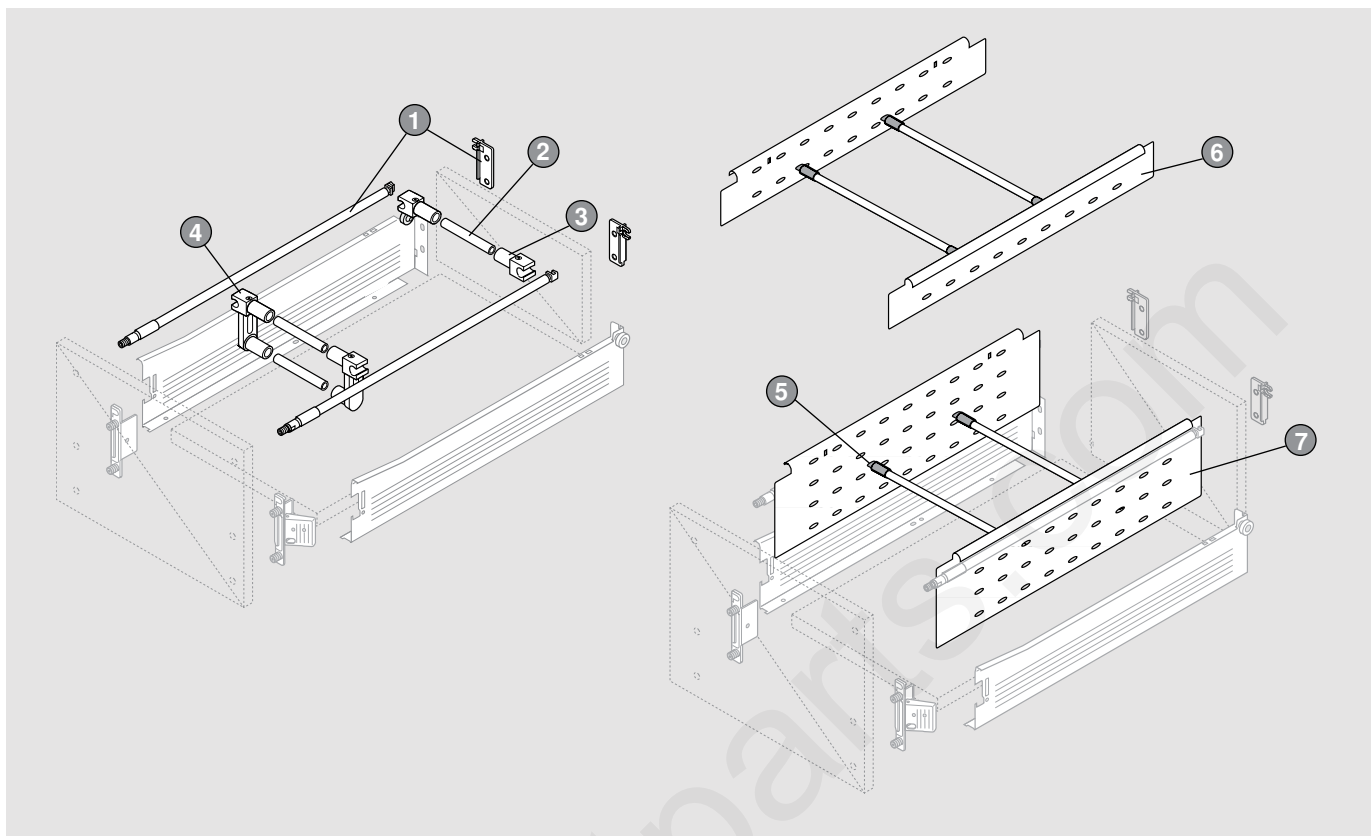

INSERTA gallery set

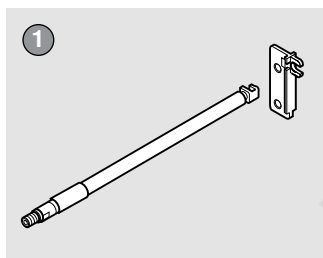

Includes 2 adjustable rails
2 rear fixing brackets
Colors: cream or white

ZRE.321S.ID	350 (14") drawer length
ZRE.371S.ID	400 (16") drawer length
ZRE.421S.ID	450 (18") drawer length
ZRE.471S.ID	500 (20") drawer length
ZRE.521S.ID	550 (22") drawer length

Gallery cross rail

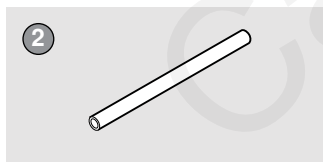

1104 (44") long, cut to length
Colors: cream or white
Length = inside opening
width minus **60 (2-3/8")**

ZRG.1104U gallery cross rail

Gallery connectors

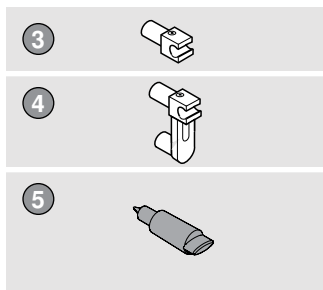

ZRU.00E0.01 Single gallery connector
Colors: cream or white

ZRU.00Z0.01 Double gallery connector
Colors: cream or white

ZRU.10B1E Spring connector
Colors: dust gray

BOXSIDE

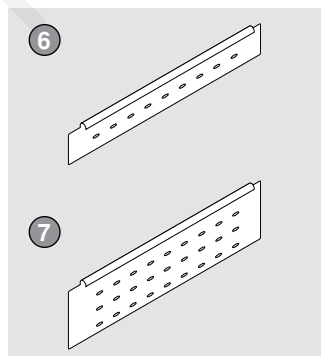

M (64mm high) Color: white
Z36M367SE01 400 (16") drawer length
Z36M417SE01 450 (18") drawer length
Z36M467SE01 500 (20") drawer length
Z36M517SE01 550 (22") drawer length

H (128mm high) Color: white
Z36H367SE01 400 (16") drawer length
Z36H417SE01 450 (18") drawer length
Z36H467SE01 500 (20") drawer length
Z36H517SE01 550 (22") drawer length

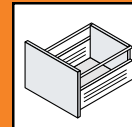

320N installation specifications

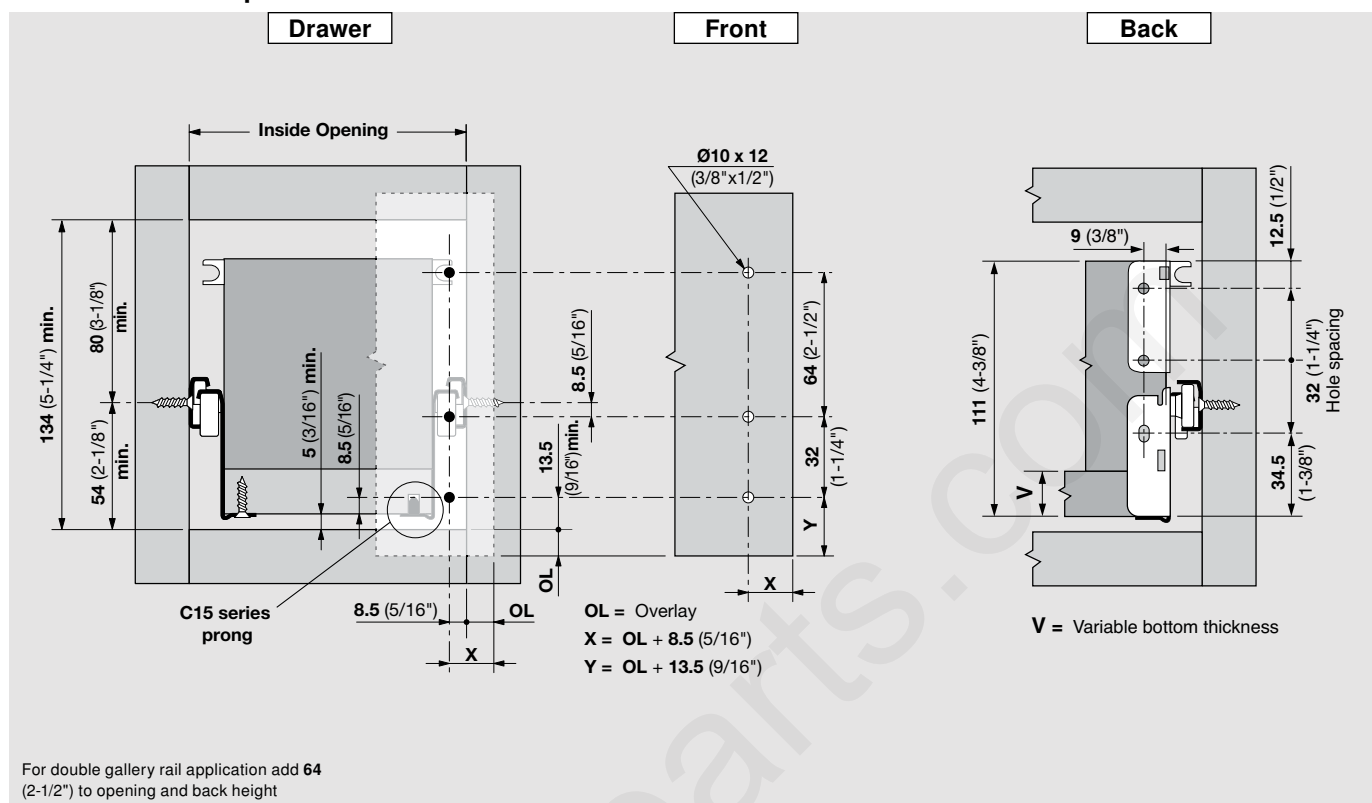

320M installation specifications

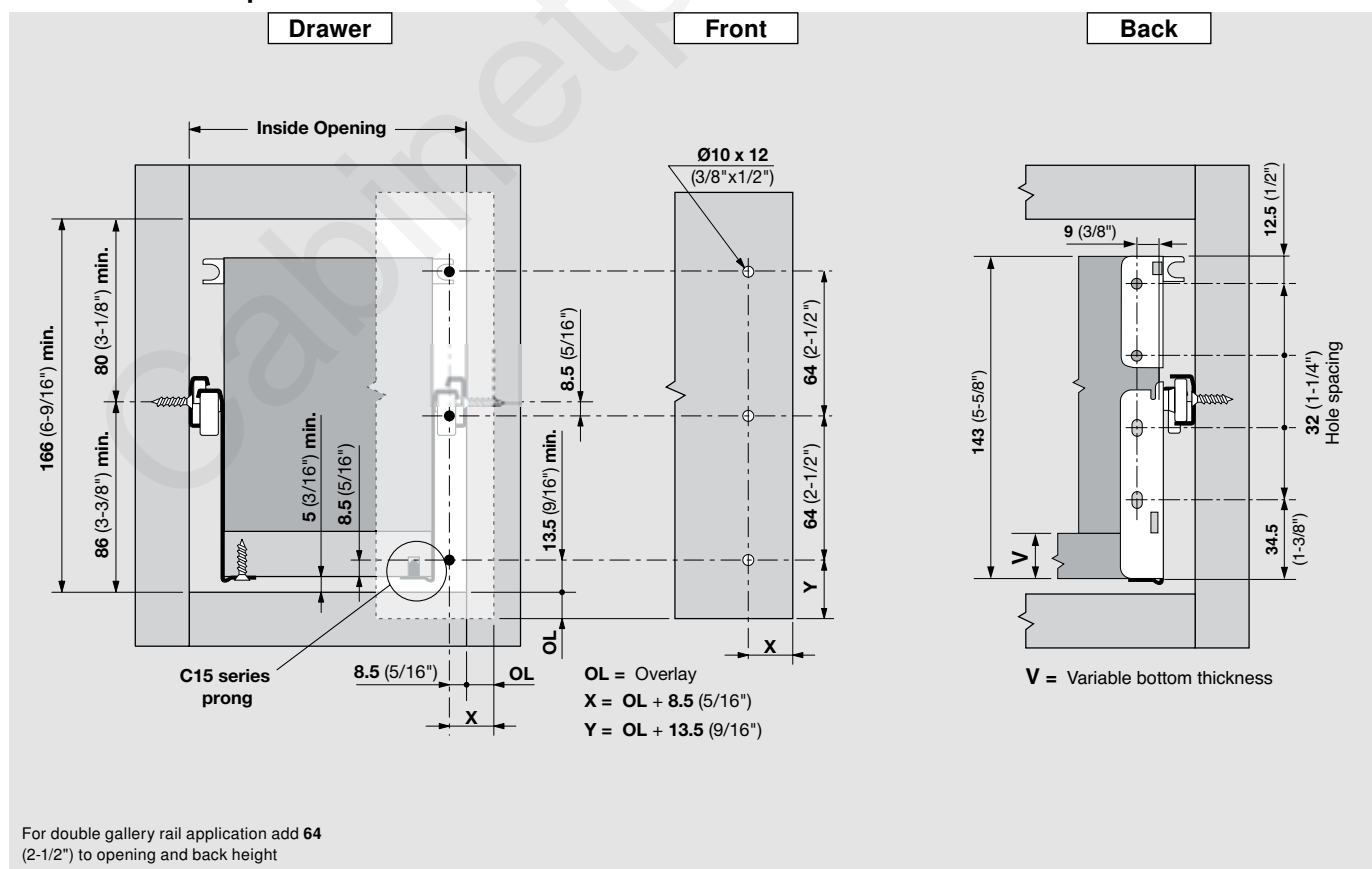

METABOX gallery rail and BOXSIDE systems

320K installation specifications

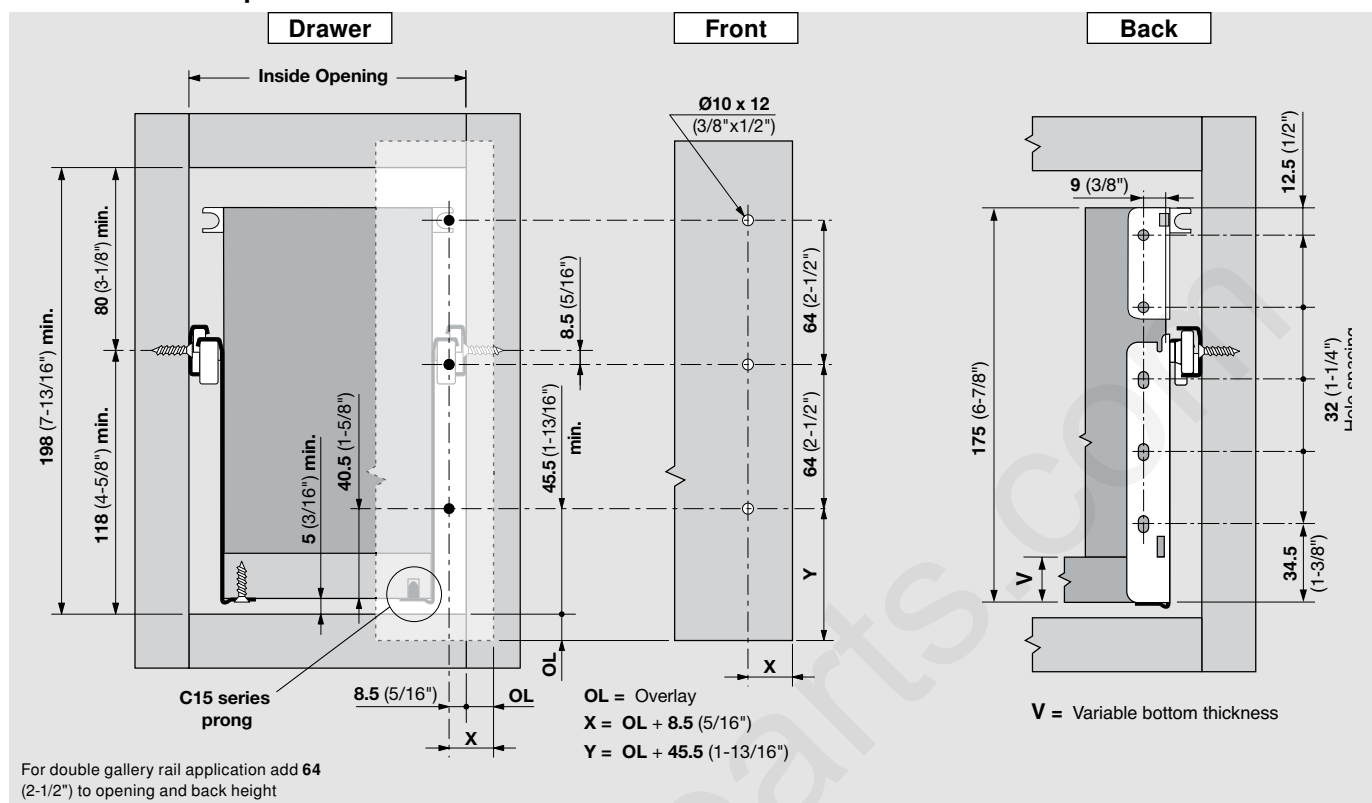

320H installation specifications

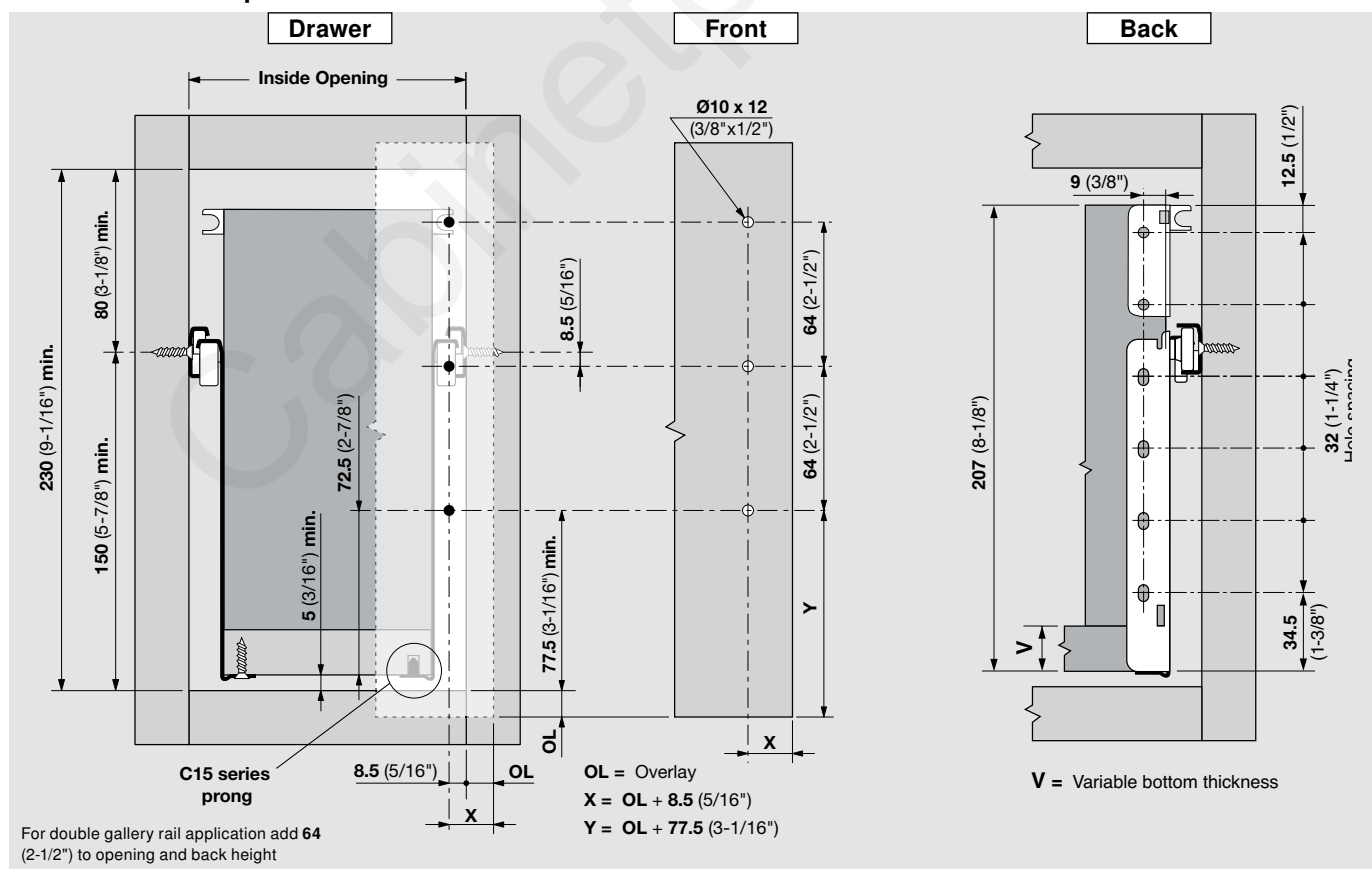

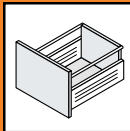

330M installation specifications

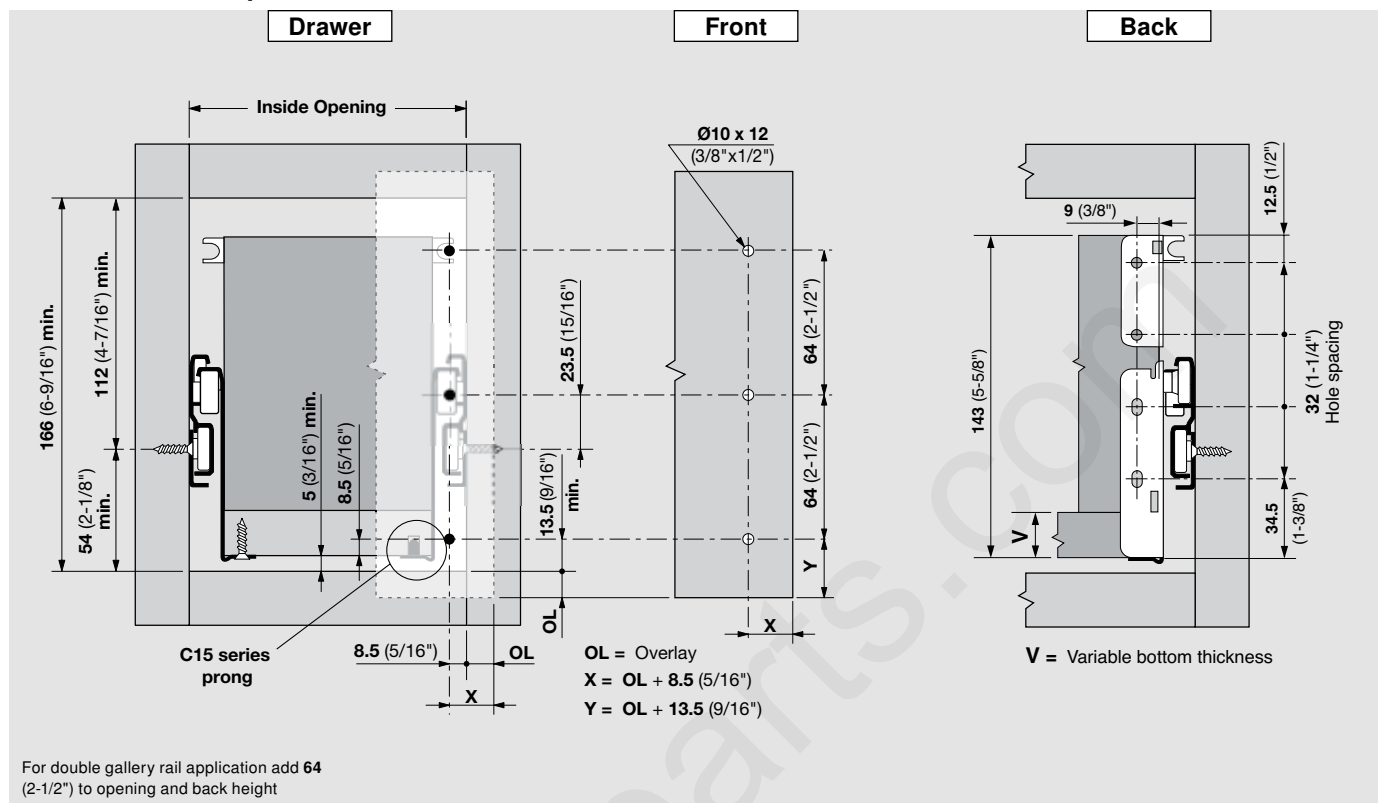

330H installation specifications

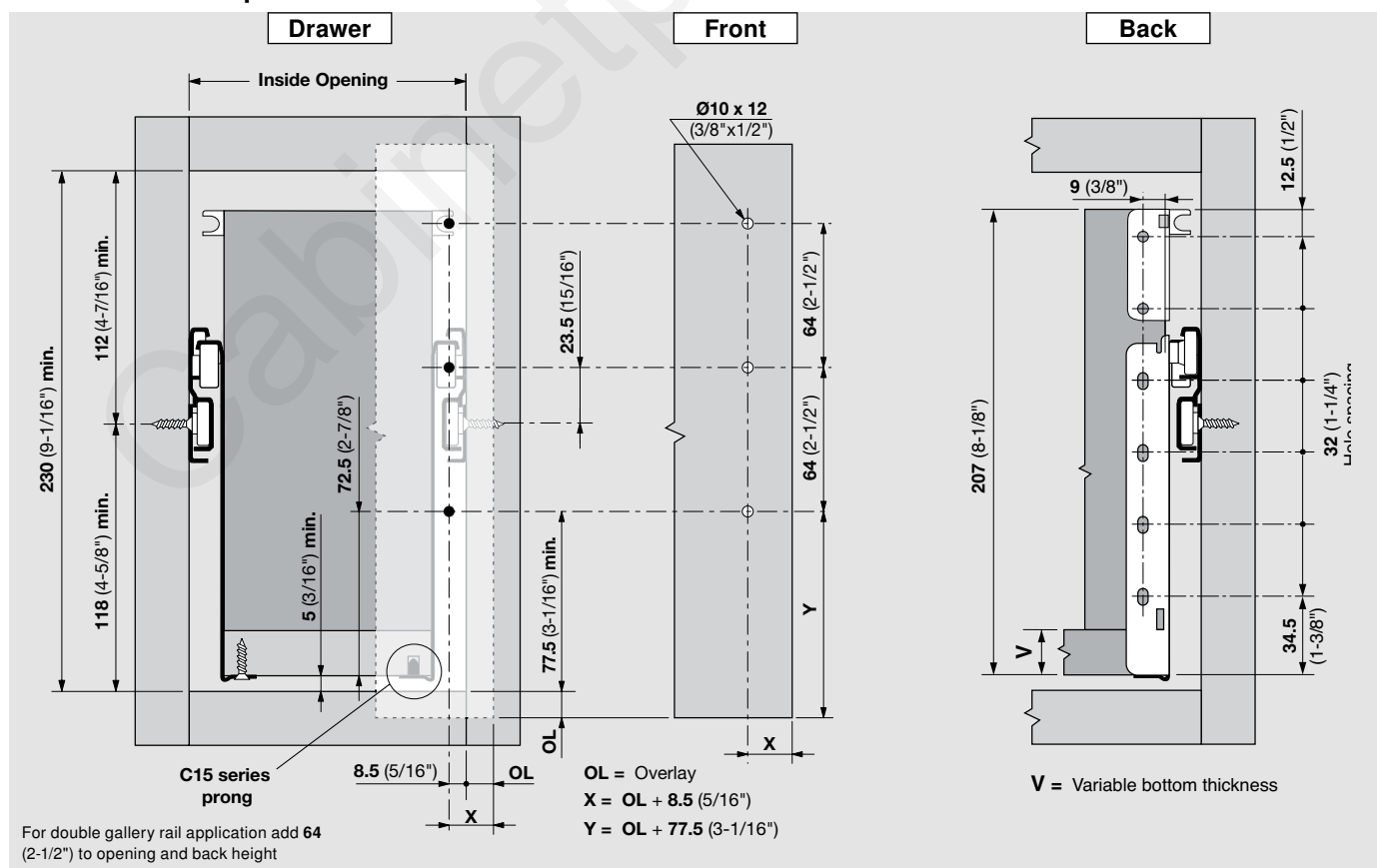

METABOX 320N interior drawer application

Drawer components

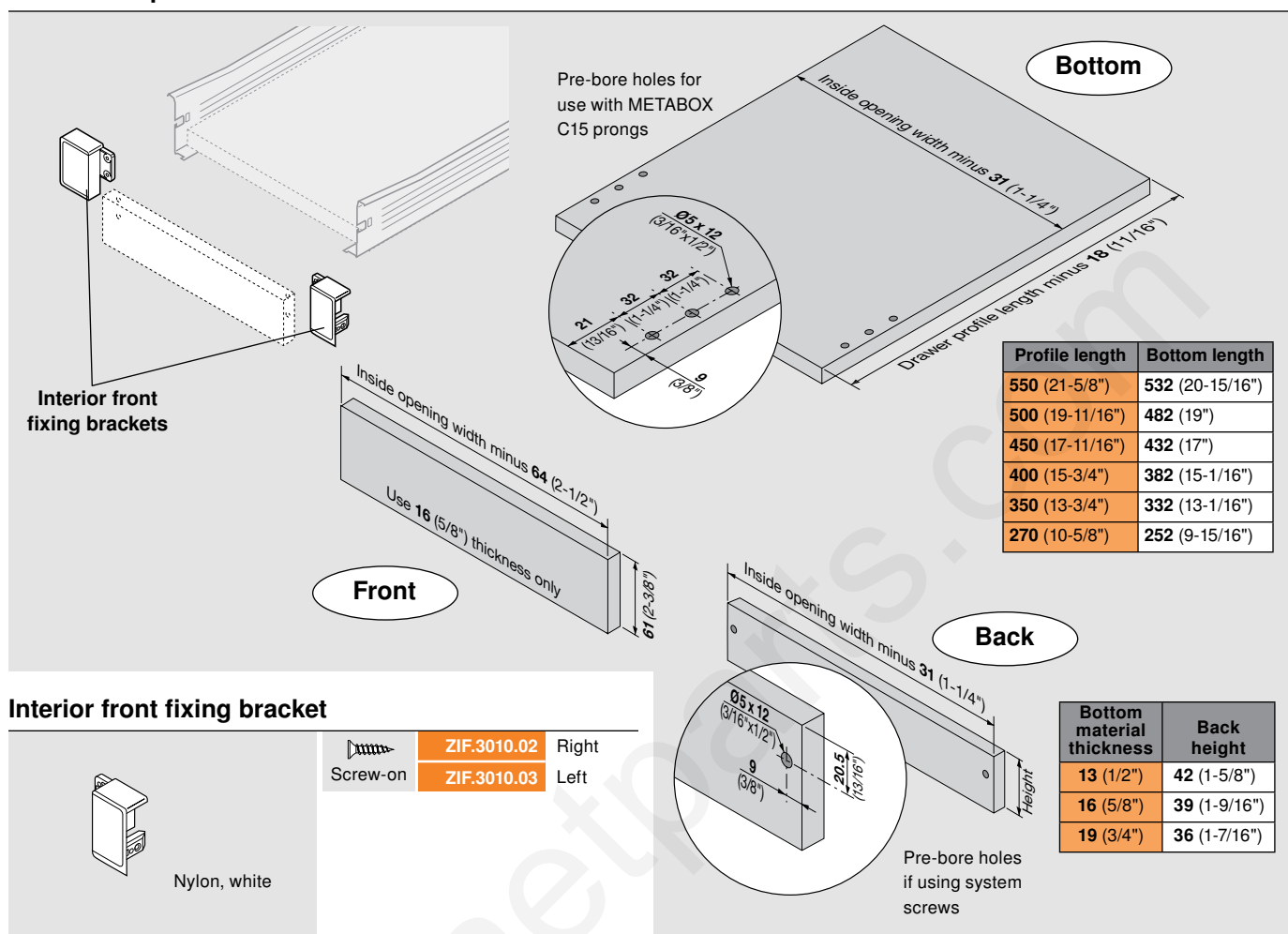

Installation specifications

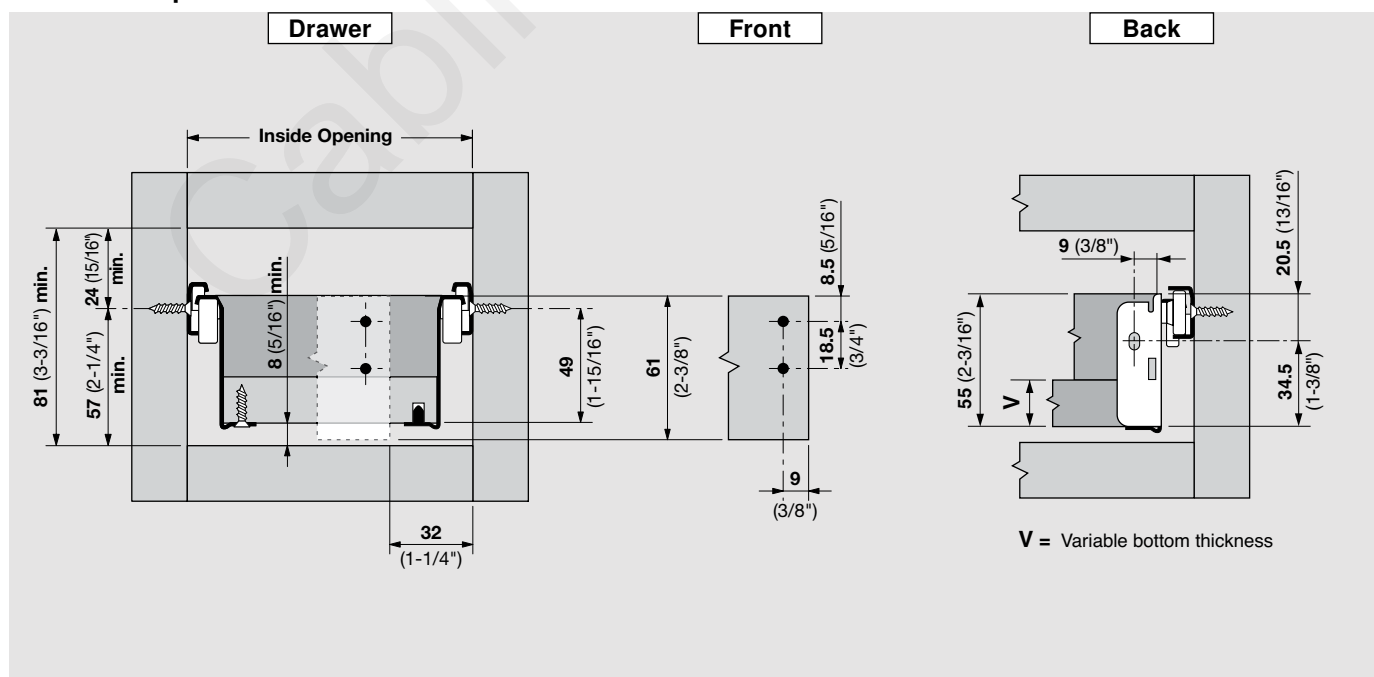

METABOX 320M interior drawer application

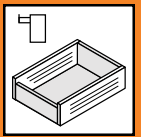

Drawer components

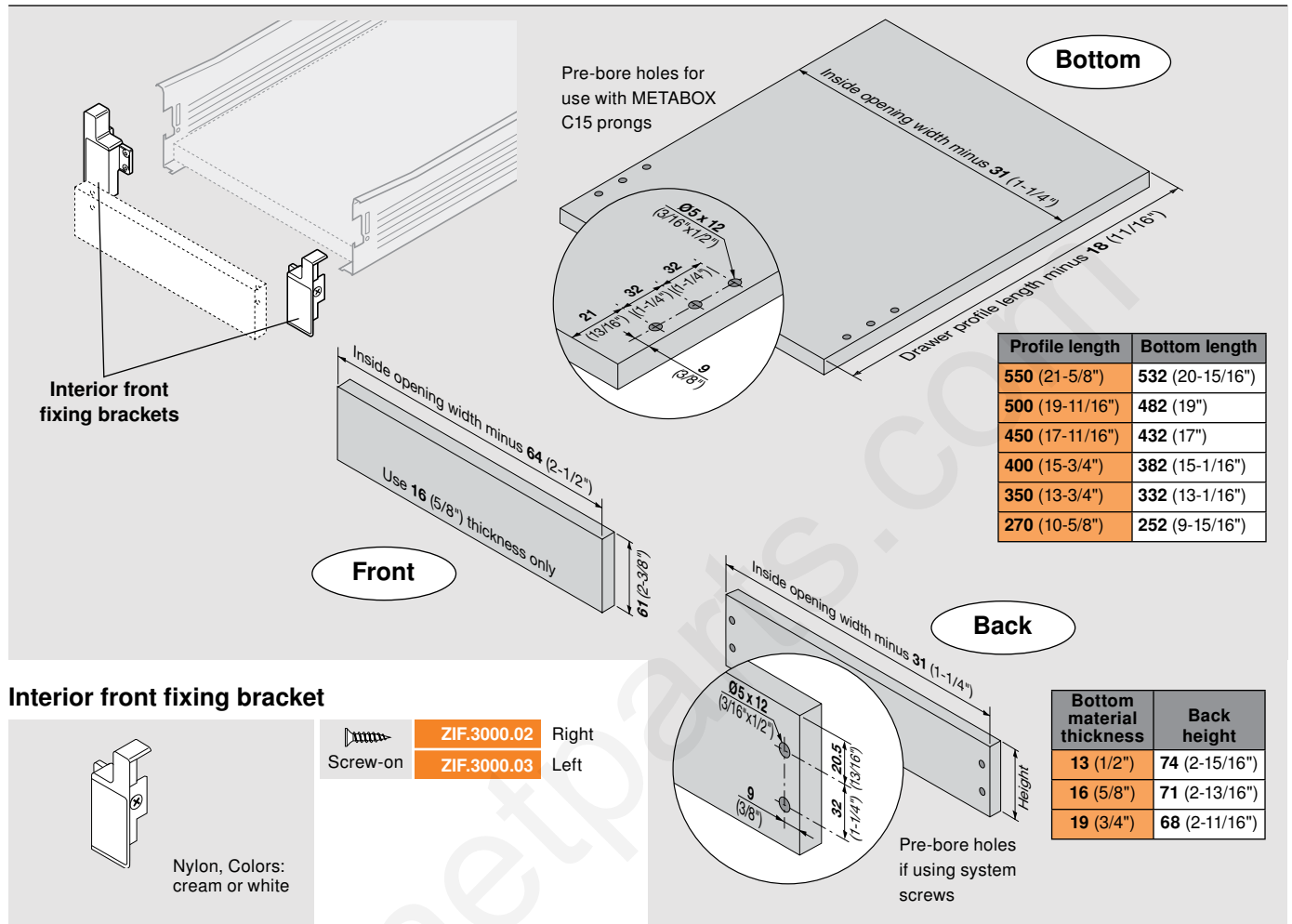

Installation specifications

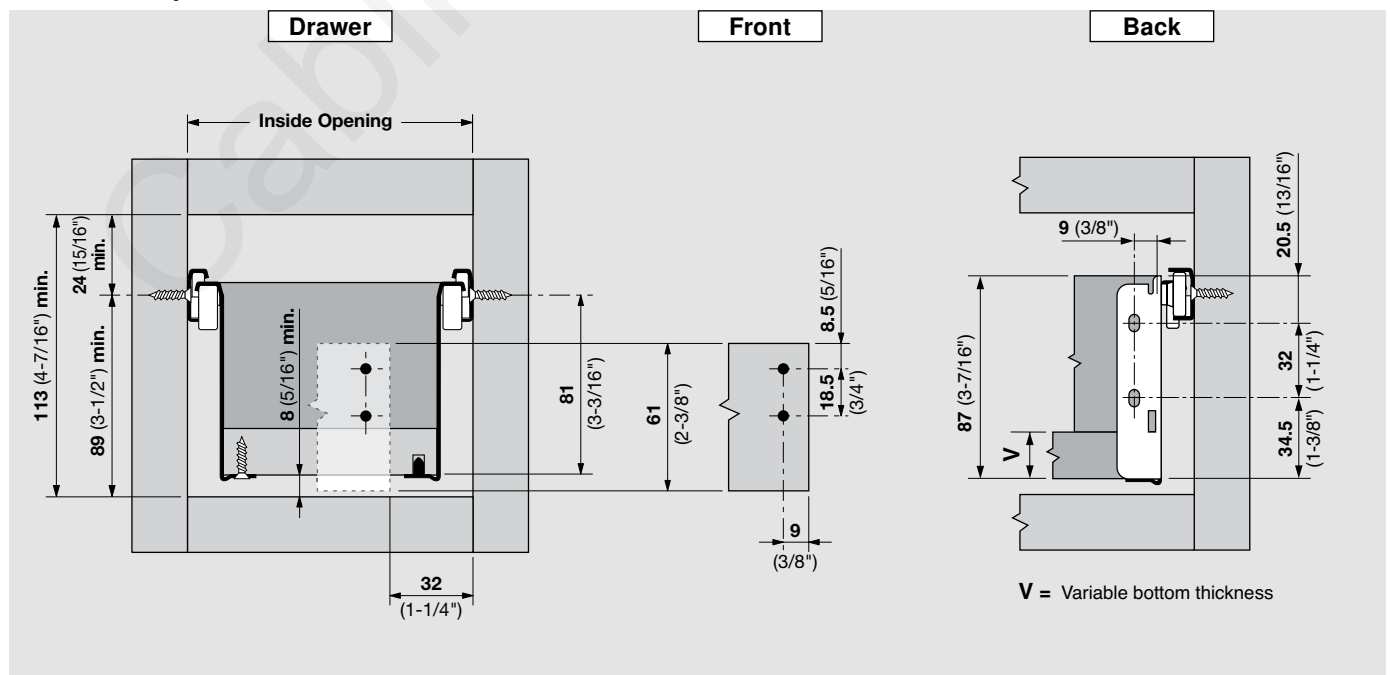

METABOX 320K interior drawer application

Drawer components

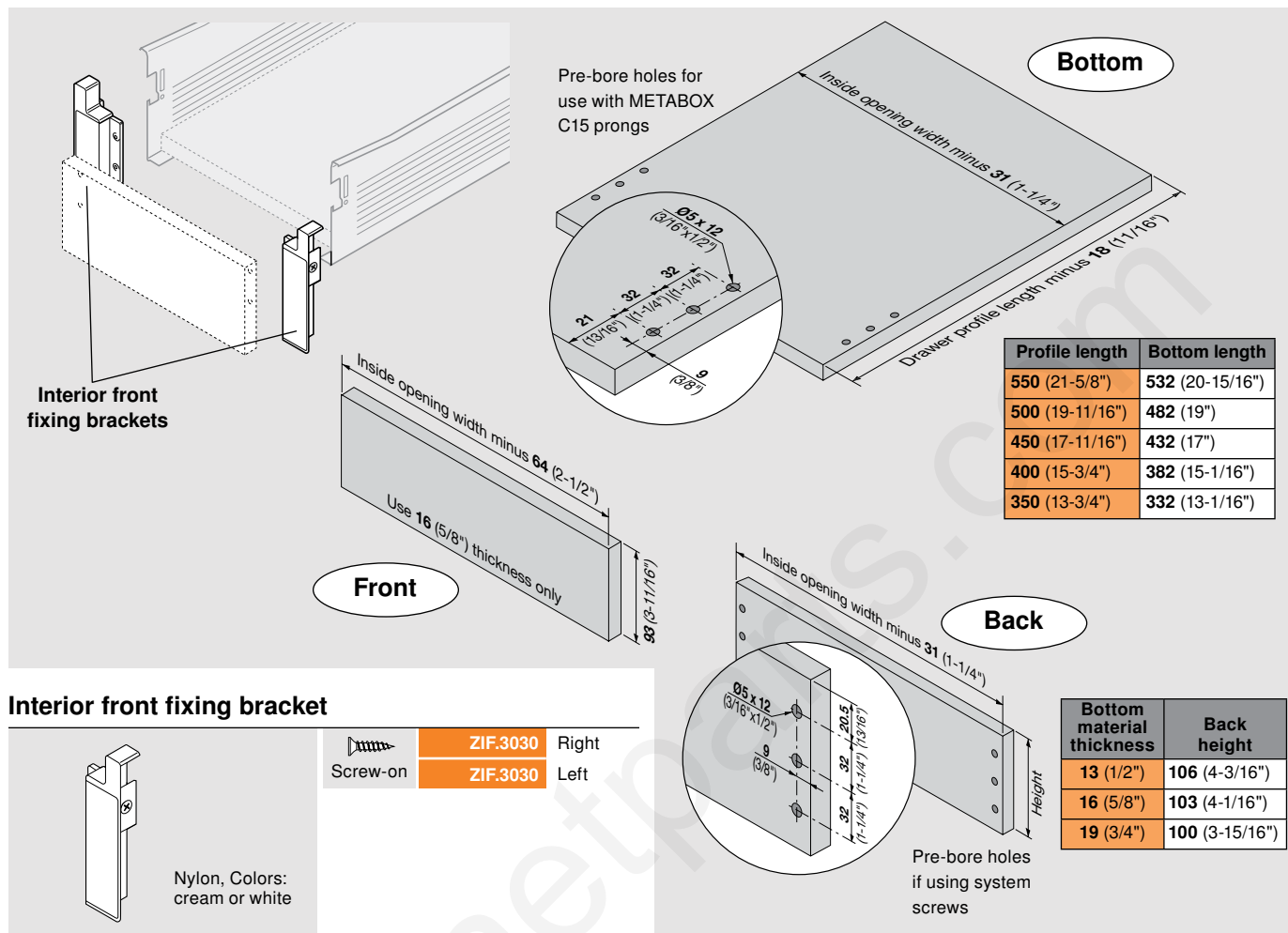

Installation specifications

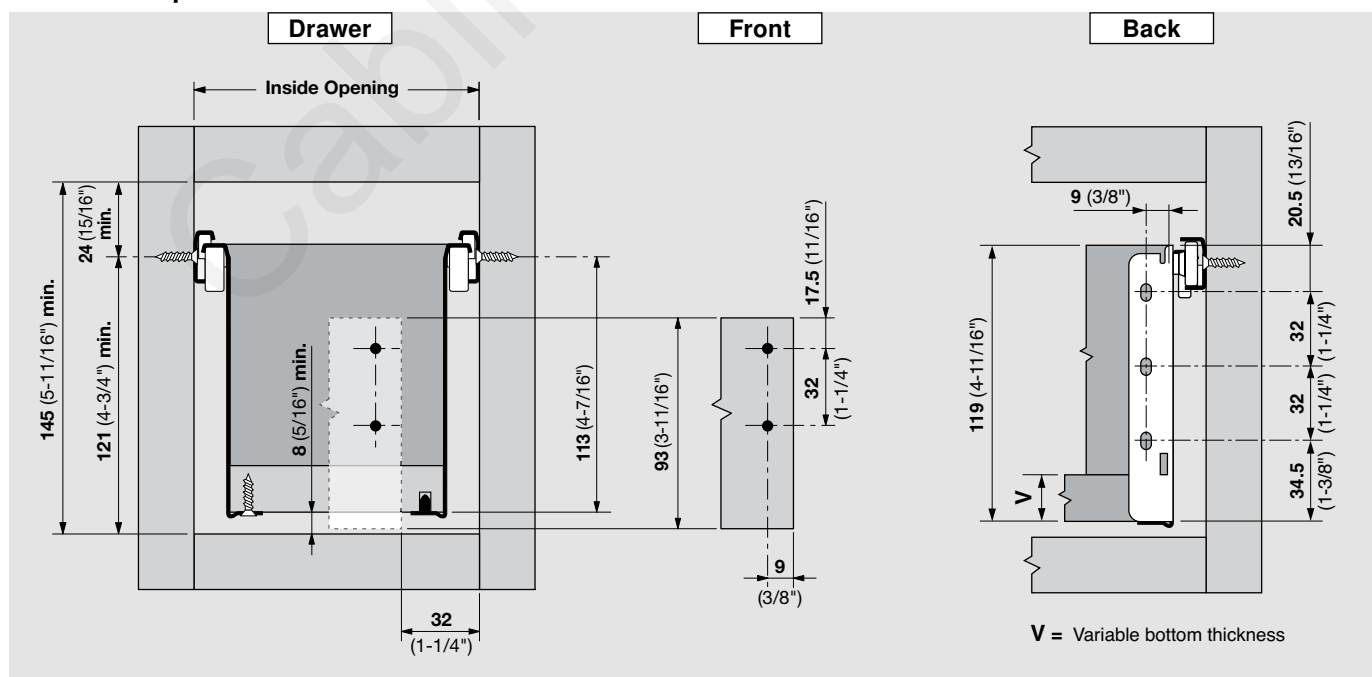

METABOX 320H interior drawer application

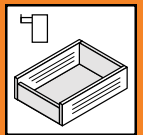

Drawer components

Interior front fixing brackets

Use 16 (5/8") thickness only

125 (4-15/16")

Inside opening width minus 64 (2-1/2")

Bottom

Pre-bore holes for use with METABOX C15 prongs

Inside opening width minus 31 (1-1/4")

Drawer profile length minus 18 (1-1/16")

Profile length	Bottom length
550 (21-5/8")	532 (20-15/16")
500 (19-11/16")	482 (19")
450 (17-11/16")	432 (17")
400 (15-3/4")	382 (15-1/16")
350 (13-3/4")	332 (13-1/16")

Interior front fixing bracket

Screw-on

ZIF.3050 Right

ZIF.3050 Left

Nylon, Colors: cream or white

Back

Pre-bore holes if using system screws

Inside opening width minus 31 (1-1/4")

Bottom material thickness	Back height
13 (1/2")	138 (5-7/16")
16 (5/8")	135 (5-5/16")
19 (3/4")	132 (5-3/16")

Installation specifications

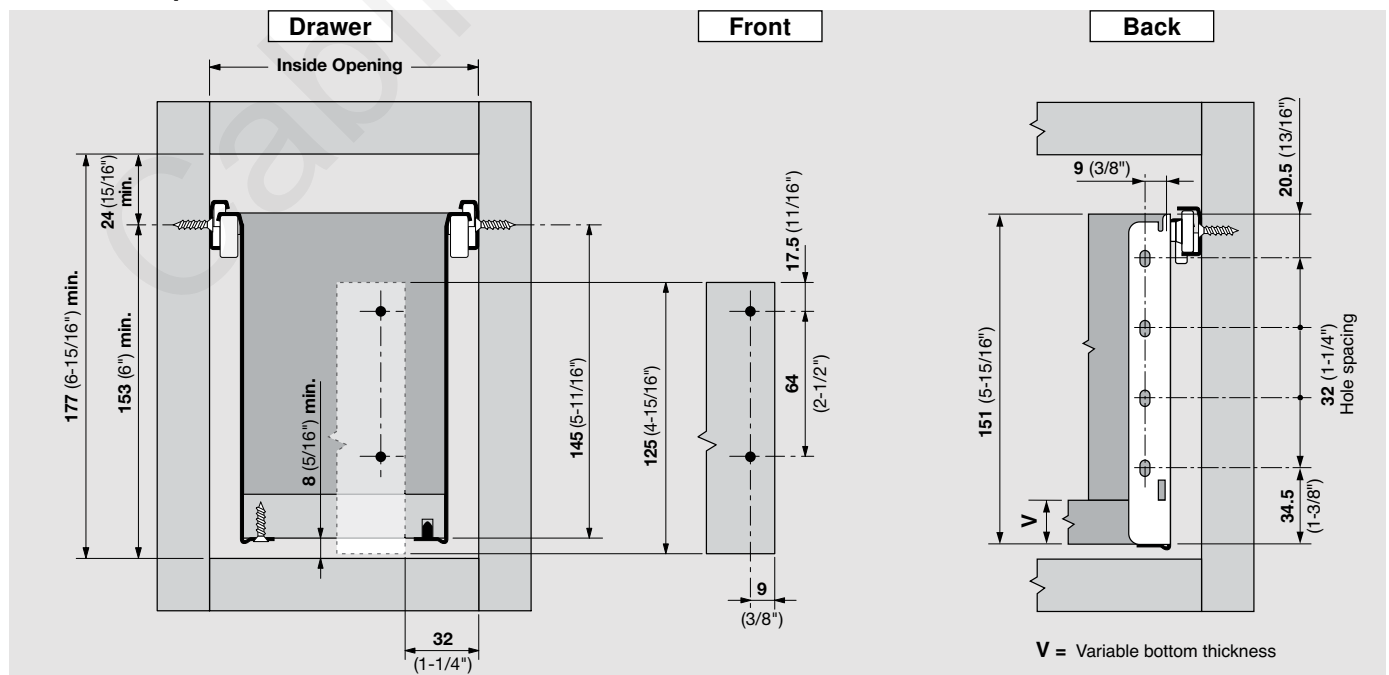

METABOX 330M interior drawer application

Drawer components

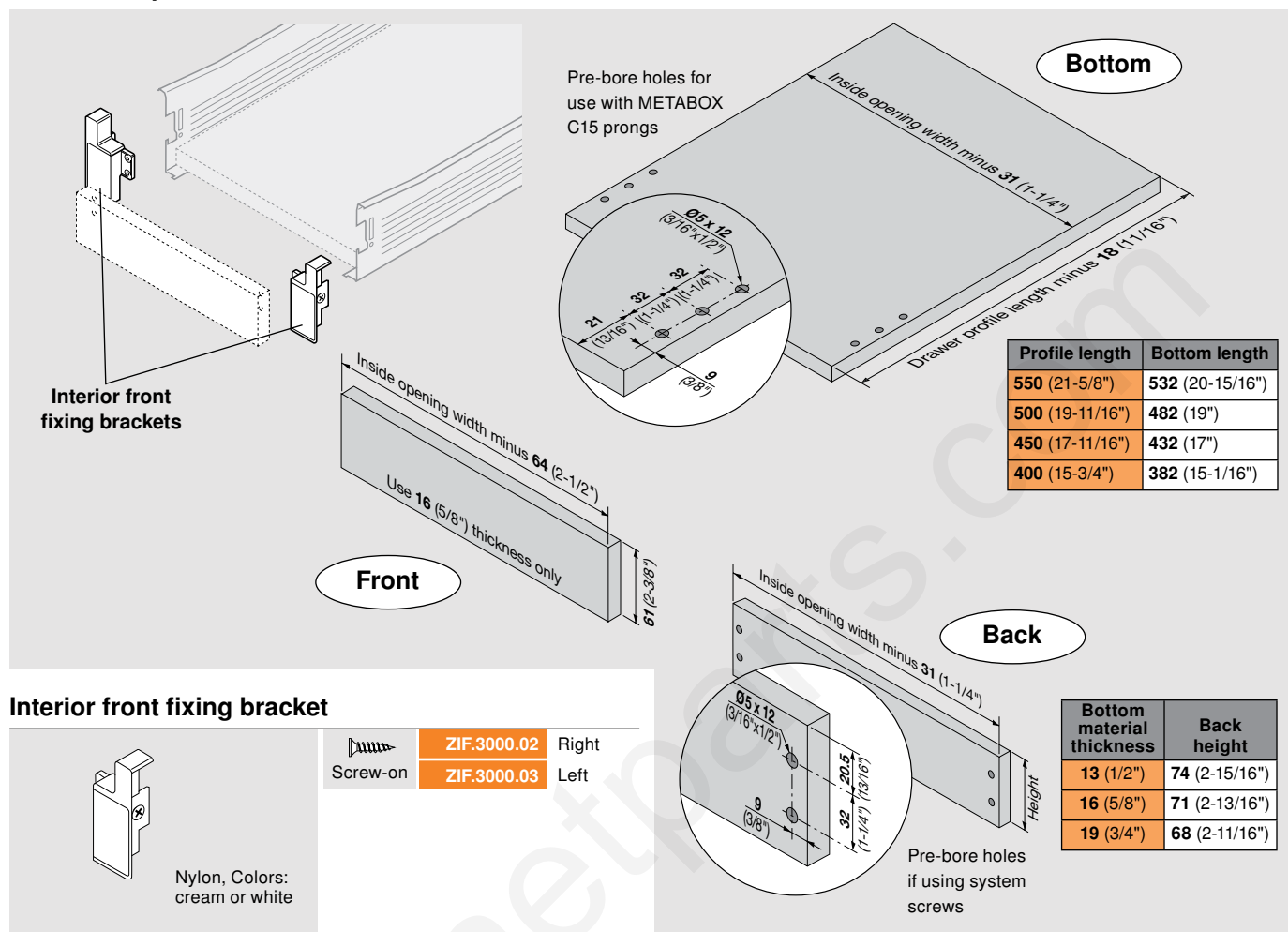

Installation specifications

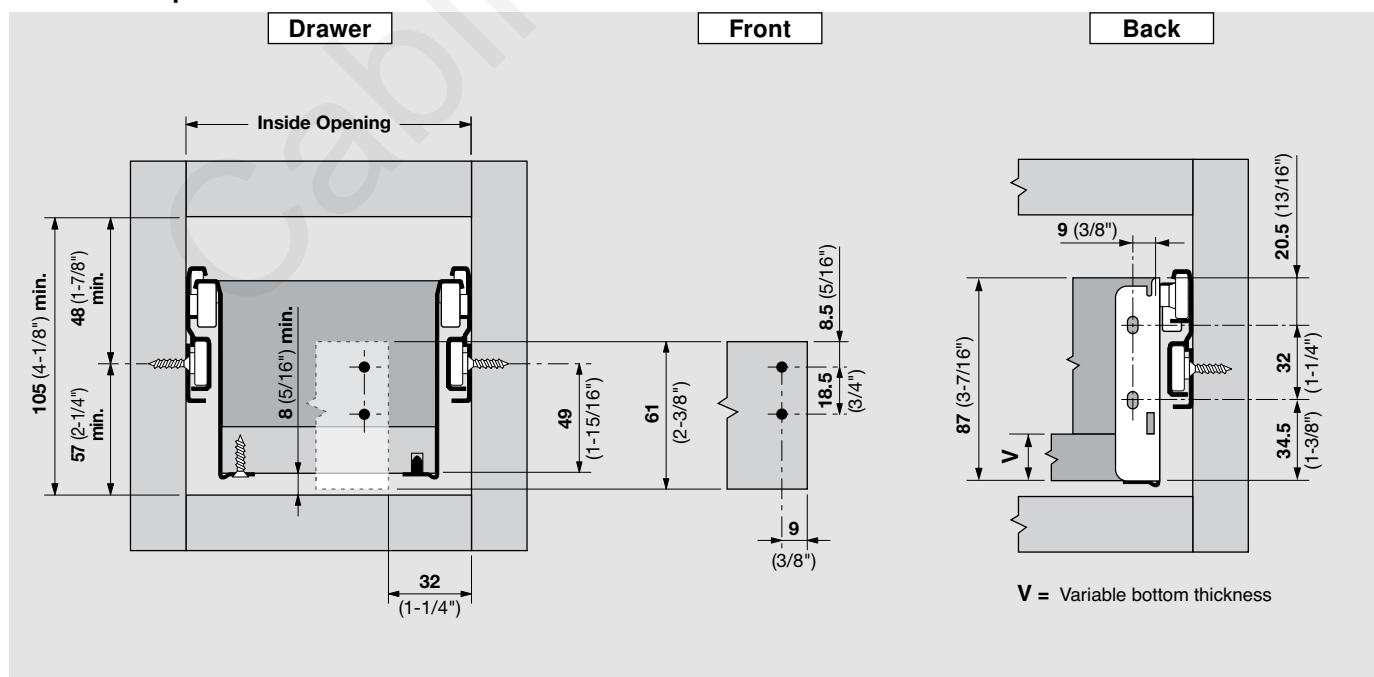

METABOX 330H interior drawer application

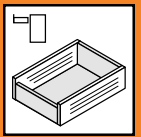

Drawer components

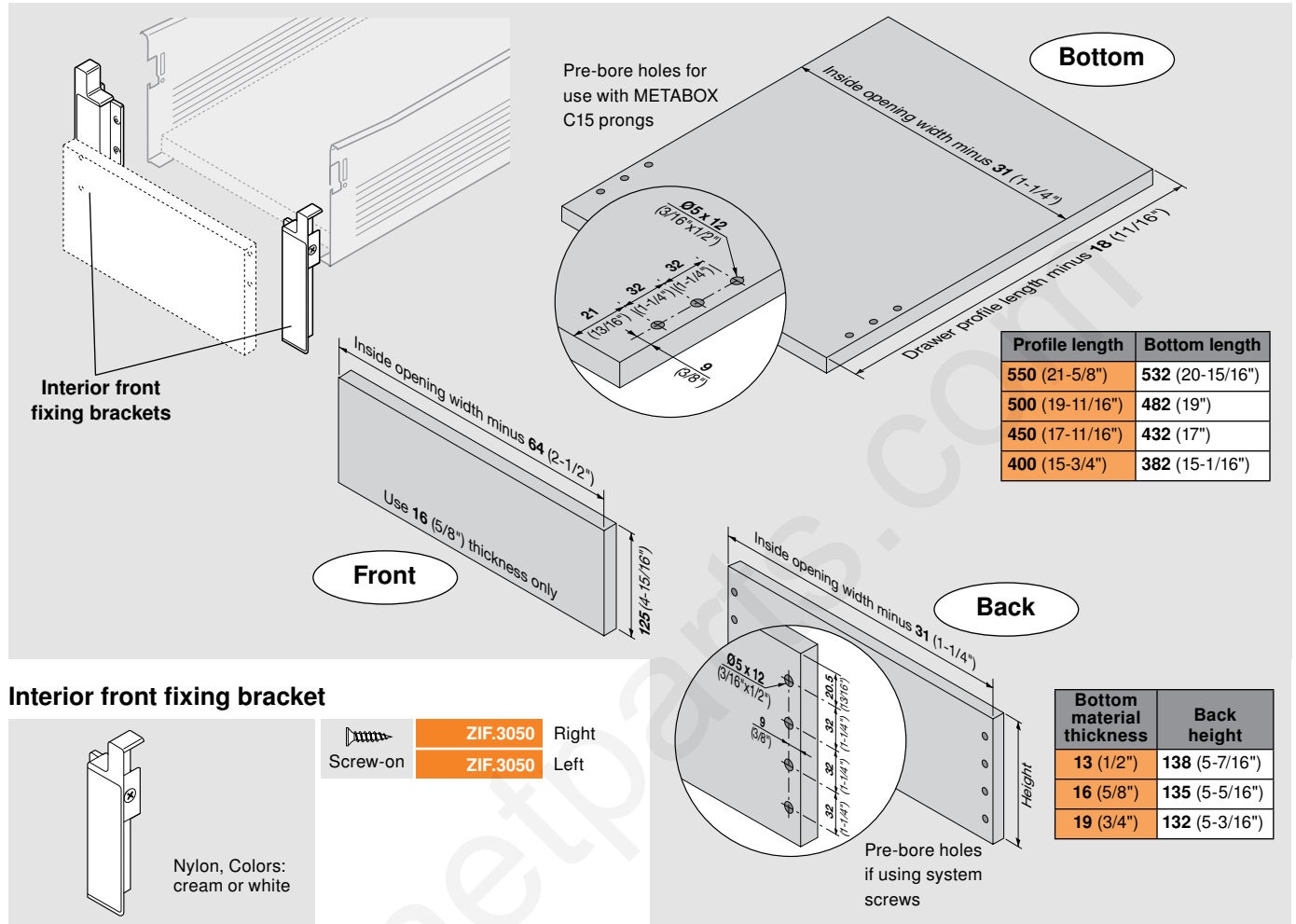

Installation specifications

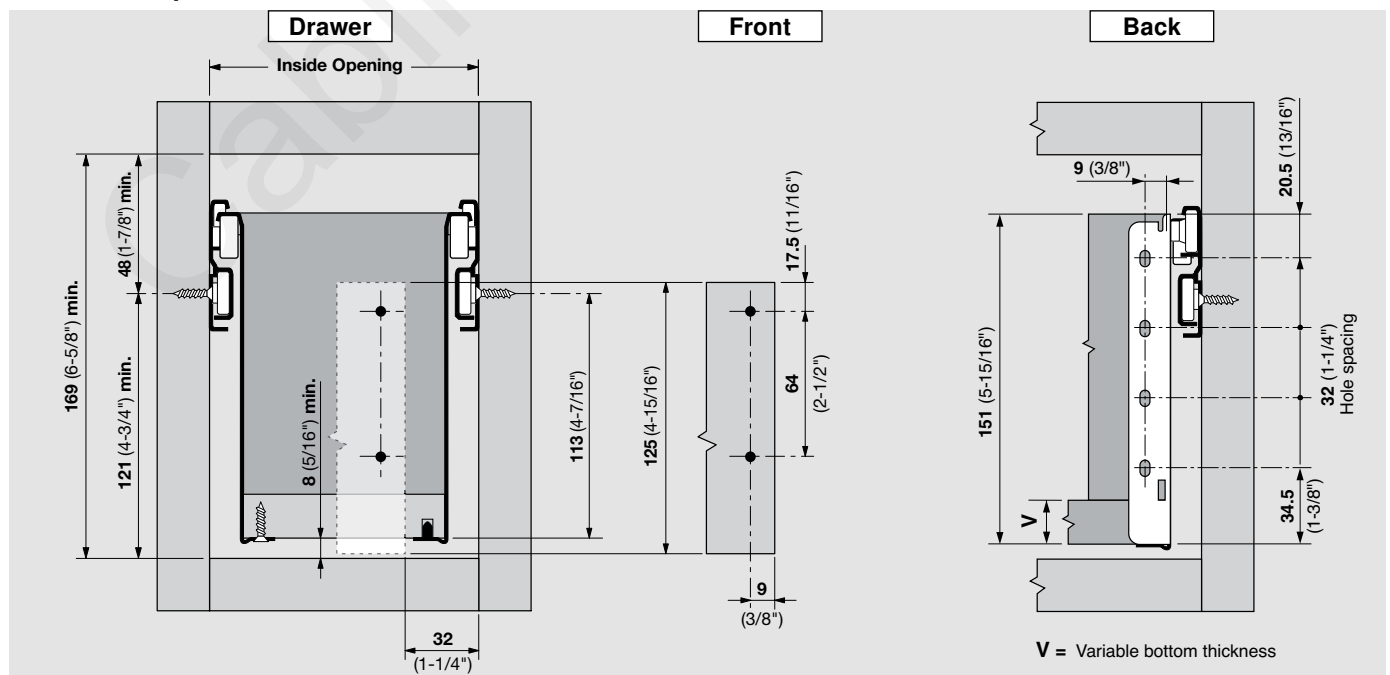

METAFILE for METABOX

Hanging rail accessories

METAFILE set

Includes components to make one standard hanging file system

Includes:

- 1 (2) **steel hanging rails** (ZRM.550S)
zinc coated, 3 x 13 x 550
- 2 (4) **rail support brackets** (ZRM.0005.10)
synthetic, natural color
- 3 (4) **rail support covers** (ZRM.0003.10)
synthetic, cream or white
- 4 (2) **glide profiles** (ZRM.550G)
synthetic, cream or white, 550 length
- 5 (8) **flathead wood screws** (6064N)
nickel, #6 x 3/4"

ZRM.5500.US METAFILE set

Lateral file accessories

- 6 **ZRM.0004.10** Lateral bracket
synthetic, cream or white,
4 required per drawer
- 7 **ZRM.1100S** Steel hanging rail
zinc coated, 3 x 13 x 1100
cut to length
- 8 **ZRM.1100G** Glide profile
synthetic, cream or white,
1100mm long, cut to length

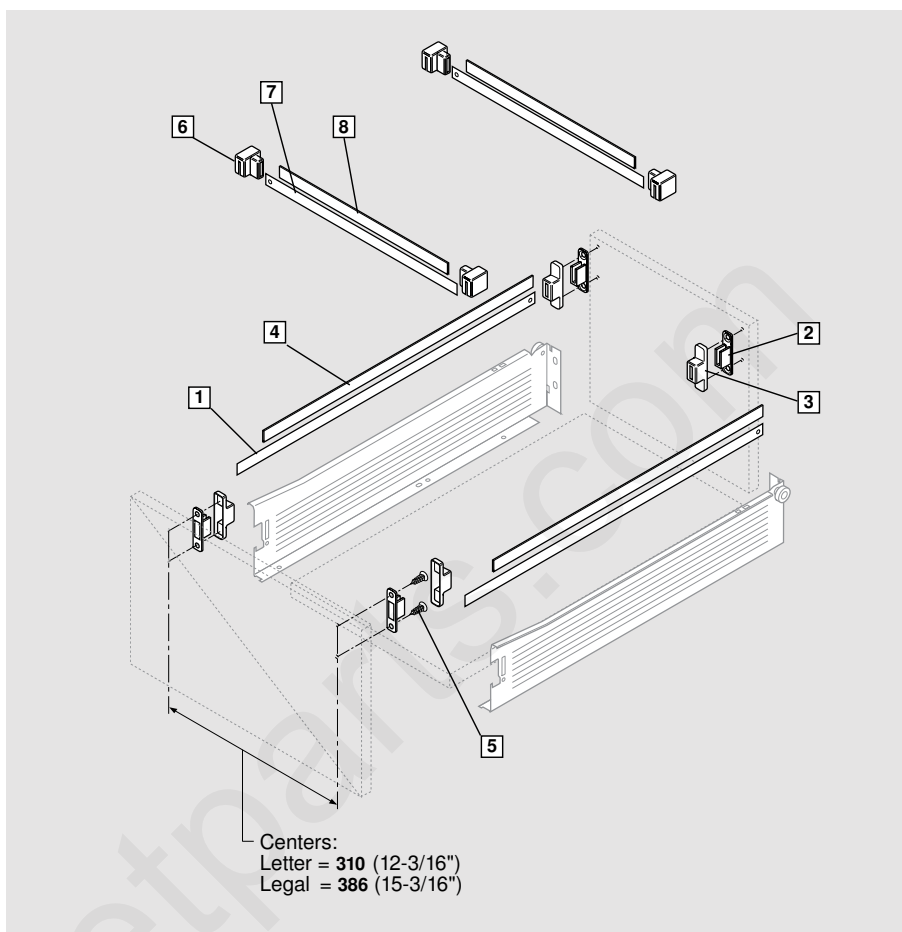

Assembly and installation specifications

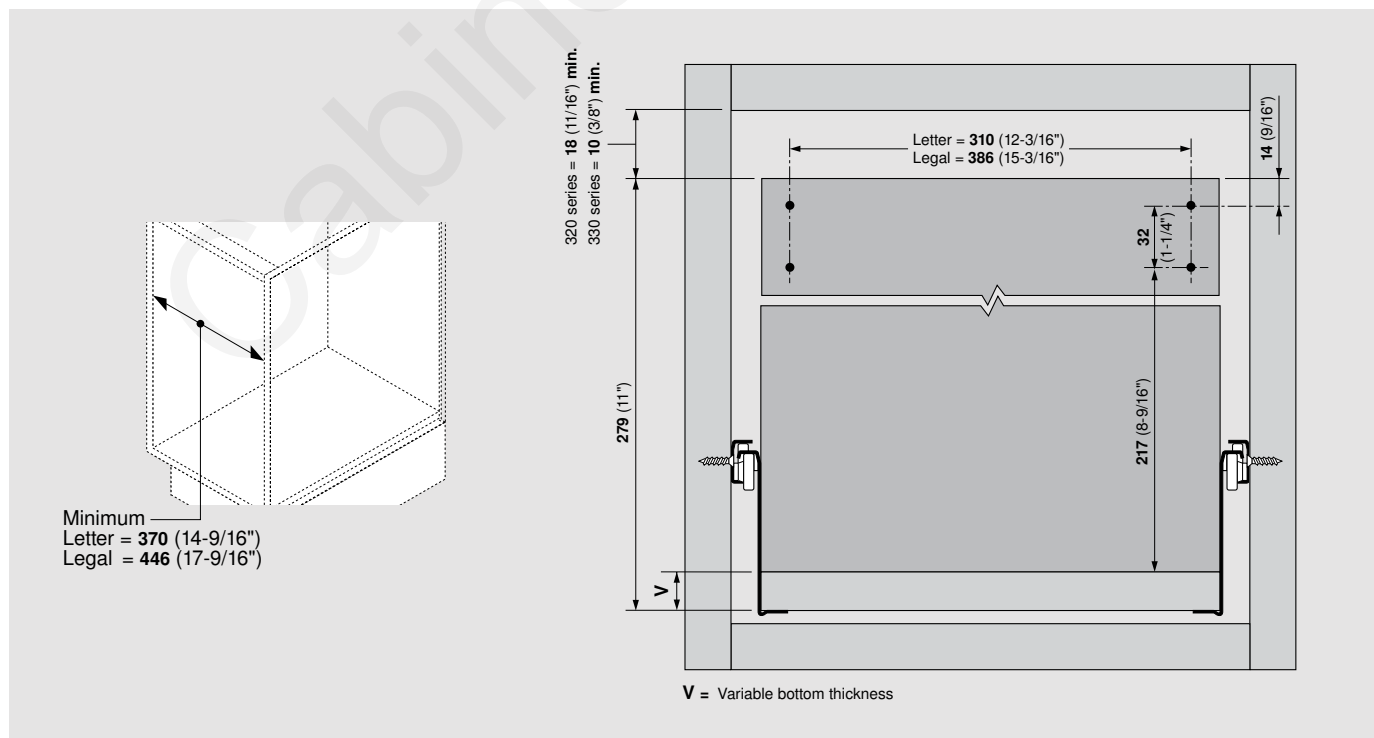

METABOX lateral stabilizer

Additional stabilization for wide drawers

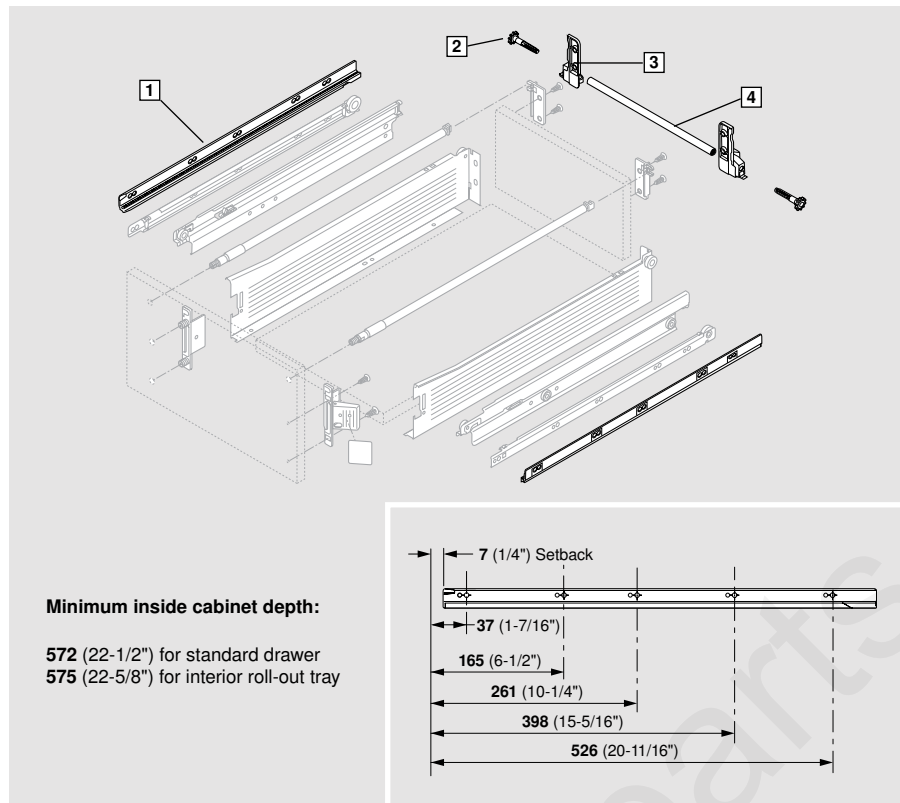

For use with METABOX 330M and H series full extension drawers only.

Available for drawer lengths 550mm (22")
Linkage rod [4] can be cut according to cabinet width.

Suitable for cabinet widths up to 1200mm (47"). Simple assembly of all components.

Does not increase load capacity.

Includes:

- [1] Gear racks, R & L
- [2] (2) pinion gears
- [3] Brackets, R & L
- [4] Linkage (1076mm)

ZST.550MH 550 (22") drawer length

Assembly and installation specifications

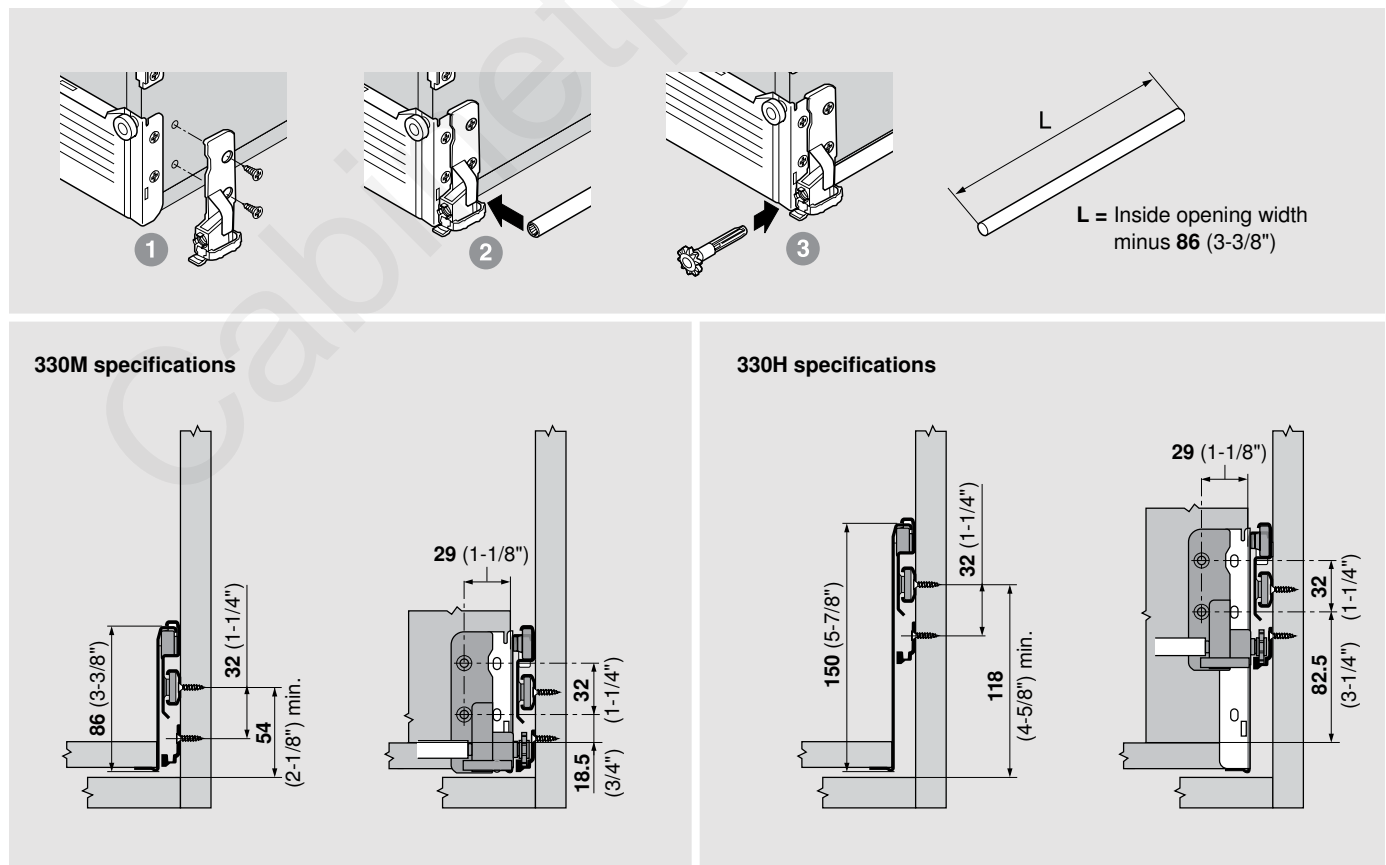

POSI-STOP

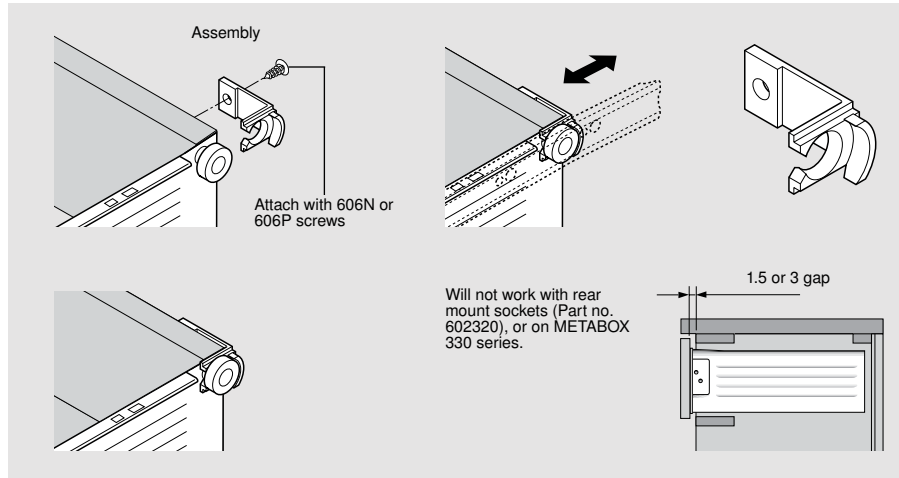

Add-on device to keep drawer front from contacting the cabinet face.

Available in thicknesses of
1.5 (1/16") or **3 (1/8")**

Synthetic, natural finish.

Non-handed, use two per drawer, snap in place and secure with wood screw

298.3210.01	1.5 (1/16") gap
298.3230.01	3 (1/8") gap

Drawer front support brackets

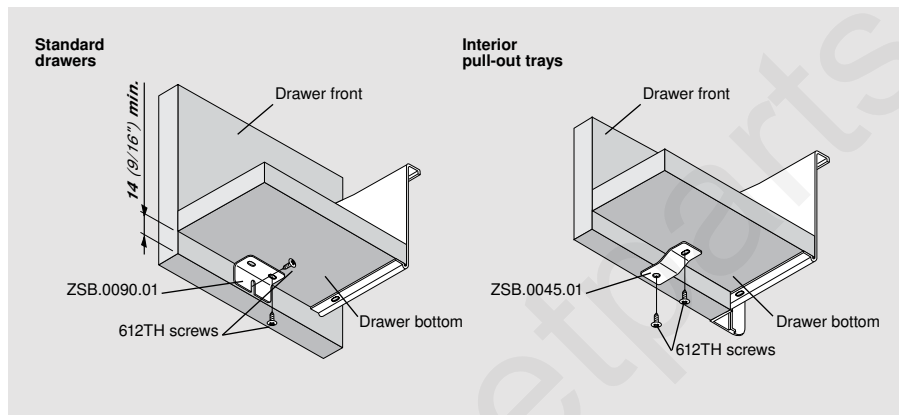

Add-on brackets for wide drawers to keep the front tight to the drawer bottom.

Stainless steel

Attach with 612TH screws

#6 x 1/2" trusshead

ZSB.0090.01	For standard drawers
ZSB.0045.01	For interior roll-out trays

Cabinet profile spacers

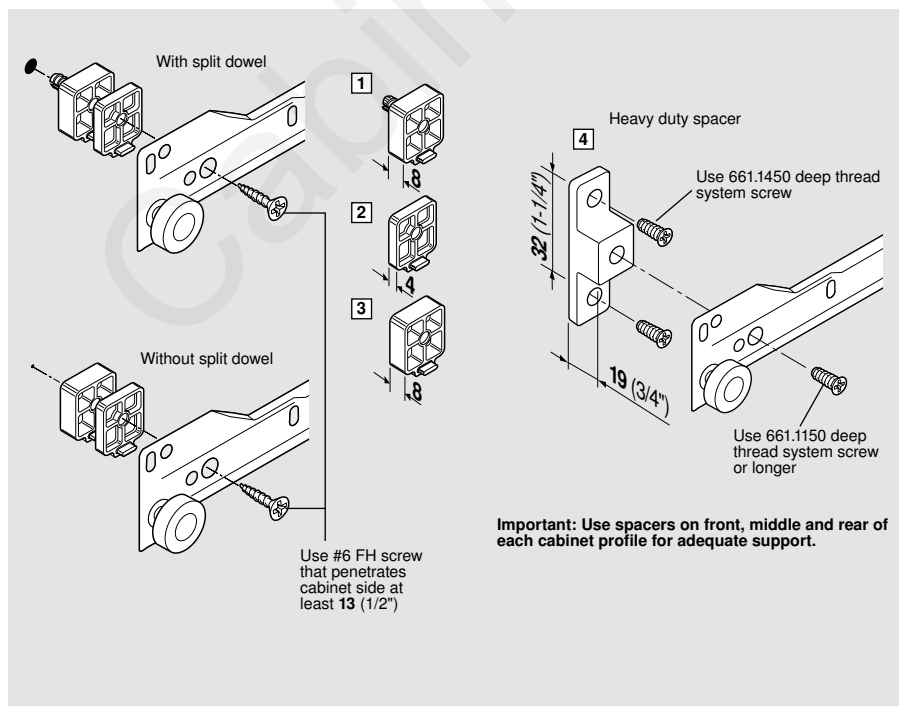

To space runners away from the cabinet side to clear door protrusion for interior roll-out trays.

Two thicknesses available that can be stacked up to **24 (15/16")**

Synthetic, cream color

1	320M0188	8 (5/16") with Ø5 (3/16") x 11 dowel for linebore mounting
2	320M0048	4 (5/32") stackable
3	320M0088	8 (5/16") stackable
4	602750	32 (1-1/4") x 19 (3/4") Heavy duty synthetic, white color

Universal drawer bracket

For mounting Blum runners to the underside of a counter surface (pencil drawer) or to the floor of a cabinet (roll-out tray).

Attach to cabinet with Blum 612TH screws,
#6 x 1/2" truss head
Zinc coated steel
Includes (8) M4 x 6 flathead machine screws
to attach runners to brackets

295.4000 Universal bracket kit (set of 4)

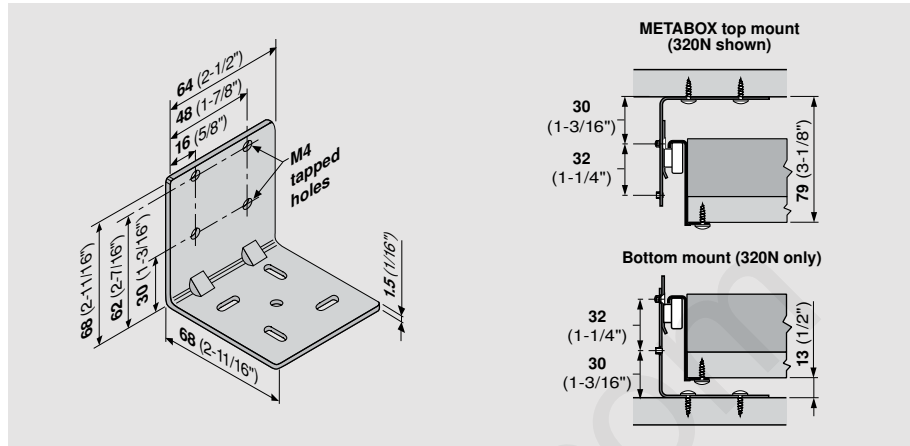

Rear mount sockets

For use with METABOX 320N, M, K, H and all 230M runners in frame cabinets.

Synthetic, cream color

Attach with Blum 612TH screws,
#6 x 1/2" trusshead

602320 Left & right socket set

Cannot be used with METABOX 330 series or in conjunction with POSI-STOP's.

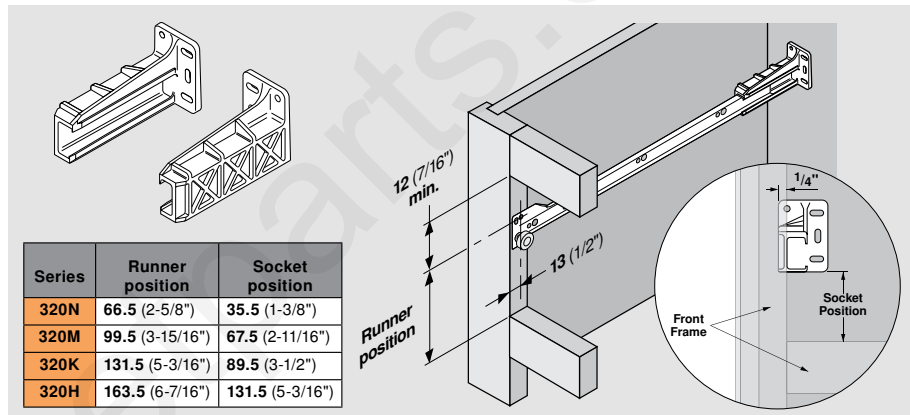

Door protectors

For pull-out surrounds to prevent damage to doors.

Attaches to the underside of the drawer.
For use with 230M runners only.
Epoxy coated steel with synthetic rollers,
cream color.

298.2200 Door protector

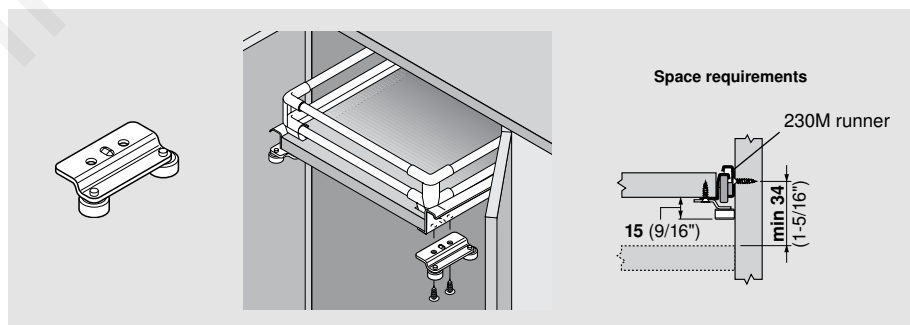

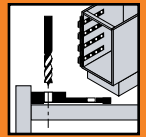

METABOX layout templates

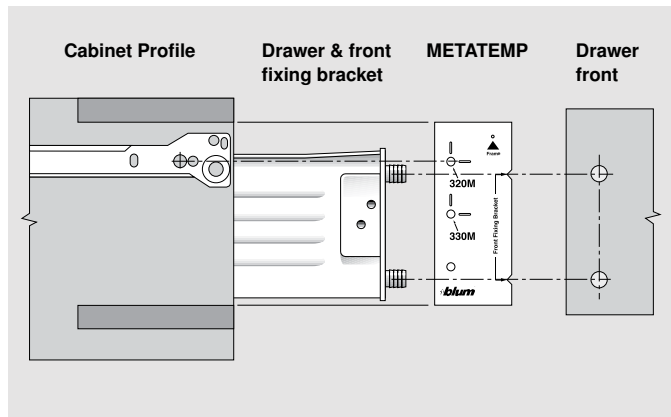

METATEMP layout templates provide a simple means for locating the cabinet profile and front fixing bracket positions.

Included in each kit are five templates for 320N, 320/330M, 320K, 320/330H, and a gallery locator for all series.

Each template's height is the minimum cabinet opening size required. To use, place on a side panel and mark the cabinet profile location. Transfer the front fixing bracket location to the drawer front. For linebored cabinets, insert a shelf pin through the template into the system hole.

METATEMP Layout template kit

Drawer front marking gauges

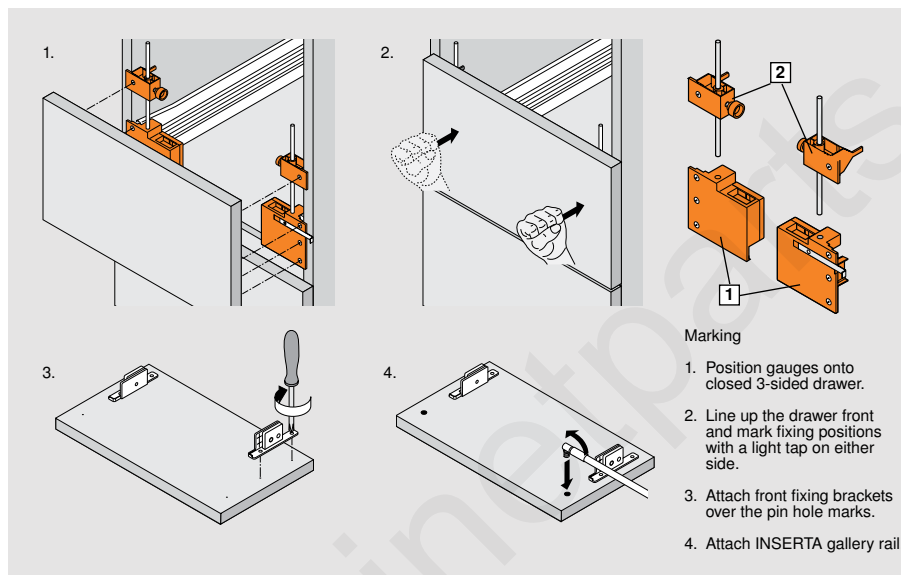

For marking all front fixing bracket positions including drawers with galleries.

1 Standard marking gauge set

ZML.1500 For METABOX 320M, K, and H

ZML.1510 For METABOX 320N

2 Gallery marking gauge set

ZML.8000.01 (2) rods with adjustable marking gauges

METABOX drilling template

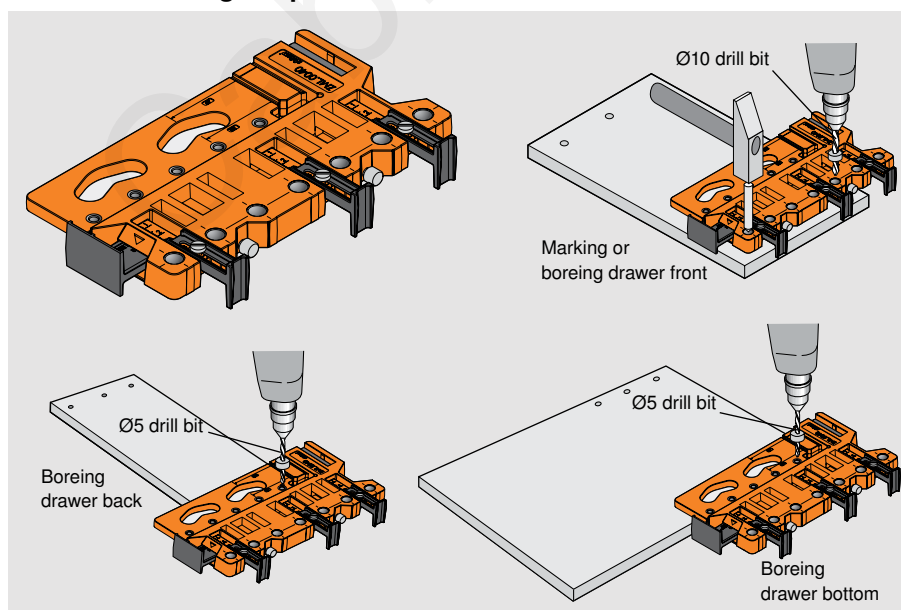

For manually boring all the holes necessary to build a METABOX drawer.

Drilling template can be used for drawer front, back and bottom. Locates all fixing points.

Ø5 (3/16") & Ø10 (3/8") stop collars included.
Ø10 (3/8") center punch included.

ZML.0040 Drilling template set

DB-5mm Ø5 (3/16") drill bit

DB-10mm Ø10 (3/8") drill bit

MINIFIX

For precise positioning of cabinet profile fixing screws.

For METABOX series 320N, M, K, H
For runners 230M

65.3300 MINIFIX

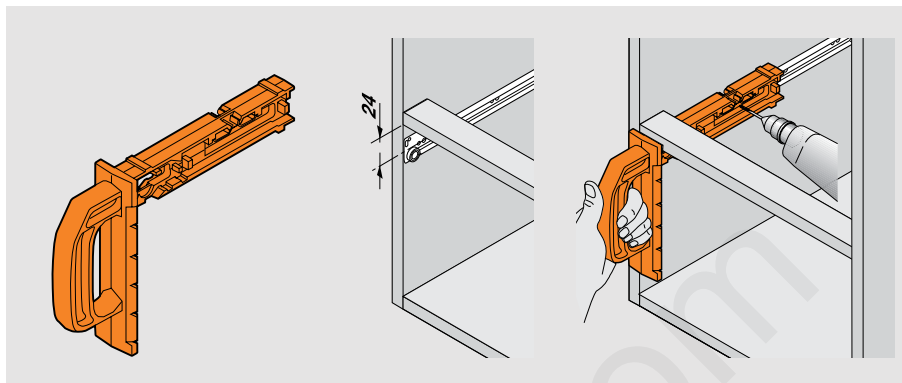

Adjustable calibrated drilling gauge

For determining cabinet profile positions and pilot boring.

Drilling gauge can be used with assembled or unassembled cabinets. Locates precise and level fixing points of cabinet profiles. Calibrated metric rail works with DynaPlan for locating profile position.

Includes:

- 1 Clamp assembly
- 2 Templates
- 3 Calibrated rail, length 1000 (39")
- 4 Extension drill bit for Ø2.5 (1/8")

T65.5000.01 Drilling gauge set
DB-2.5mm Ø2.5 (1/8") drill bit

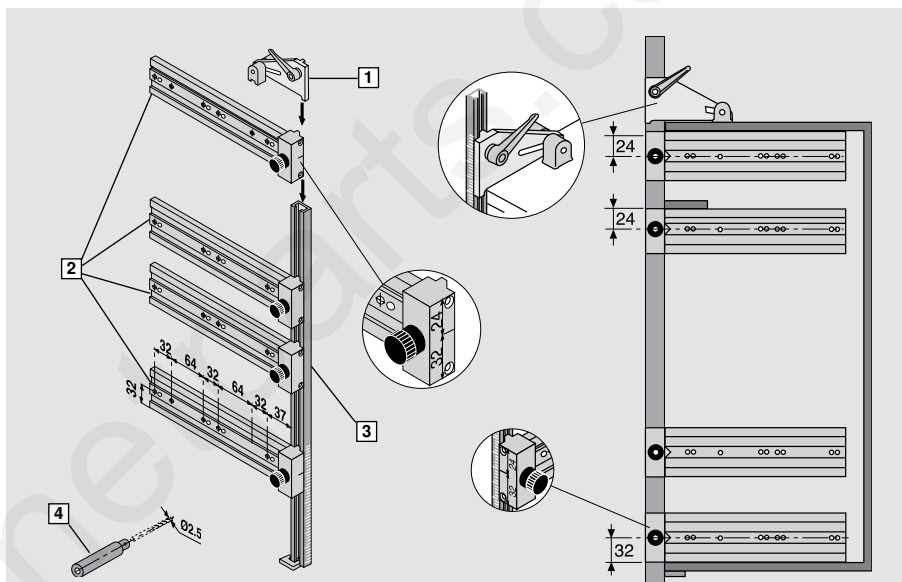

1. Determine runner locations from DynaPlan or by manual calculation.
2. Set templates on the bar by the scale
3. Clamp assembly to the cabinet side.
4. Bore Ø2.5mm pilot holes for front and middle mounting positions.

5. Fasten runners to cabinet with wood screws.
6. Add screws to back of runner for added strength as required.

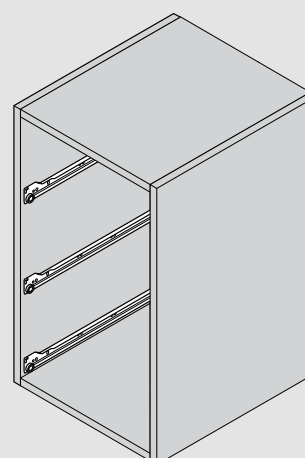
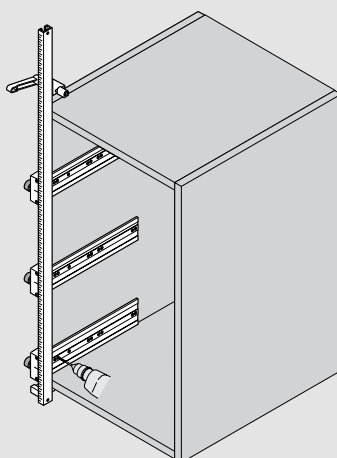

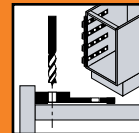

MINIPRESS P - Deluxe boring and insertion machine



Features:

- Front adjustable boring distance with digital calibration
- Pneumatic hold-down clamps
- Improved boring depth adjustment
- Improved positioning stops (4)
- Tool kit included
- Dust collection attachment
- Accepts optional 7 or 8 spindle boring heads

Single phase - 220V power

Laser center line optional.

Three phase - 220V power

Laser center line optional.

Three phase - 440V power

No laser center line option.

M53.1053.US

M53.1004.US

M53.1005.US

MINIPRESS P - Standard boring and insertion machine



Features:

- Front adjustable boring distance
- Improved boring depth adjustment
- Improved positioning stops (4)
- Tool kit included
- Dust collection attachment
- Accepts optional 7 or 8 spindle boring heads

Single phase - 220V power

Laser center line, hold down clamps and digital calibration optional.

M53.1053.UB

MINIPRESS M - 110V manual boring and insertion machine



Features:

- 110V power with molded plug (portable)
- Does not require pressurized air
- 4 positioning stops included
- Tool kit included
- Dust collection attachment
- Accepts optional 7 or 8 spindle boring heads

110V power

Boring distance stop kit optional. No laser center line option.

M52.1056.US

MINIDRILL P -Standard boring machine



Features:

- Front adjustable boring distance
- Improved boring depth adjustment
- Improved positioning stops (4)
- Tool kit included
- Dust collection attachment
- Accepts optional 7 or 8 spindle boring heads

Single phase- 220V power

Optional hold down clamps, laser center line and digital calibration.

Three phase - 220V power

Optional hold down clamps, laser center line and digital calibration.

Three phase - 440V power

Optional hold down clamps and digital calibration. No laser center line option.

M53.1053.50

M53.1004.50

M53.1005.50

MINIPRESS boring heads

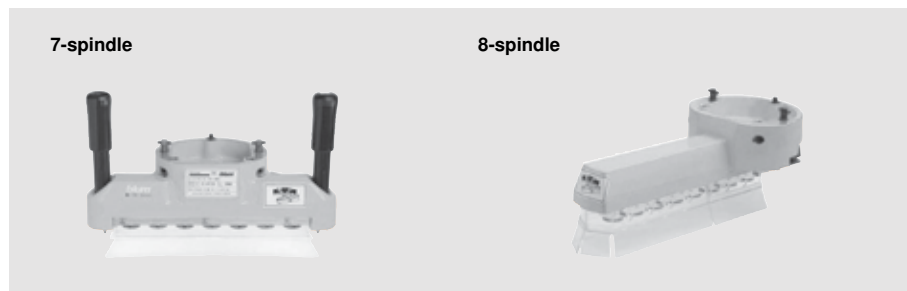

For line boring with the MINIPRESS.

The 7-spindle head bores 7 holes 32mm apart, parallel to the fence. The 8-spindle head bores 8 holes 32mm apart, perpendicular to the fence. Bores for all METABOX front fixing brackets and galleries.

MZK.1000.US 7 spindle boring head

MZK.8000.US 8 spindle boring head

Drill bits

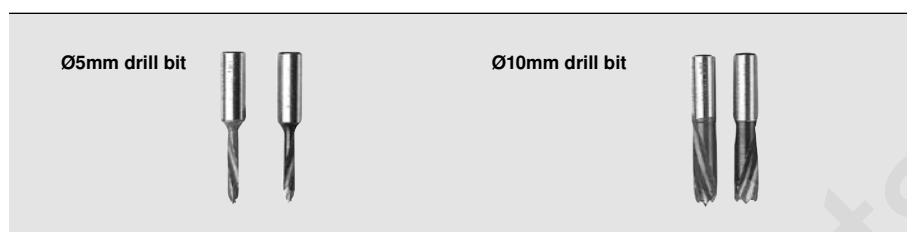

Drill bits for the MINIPRESS/MINDRILL and boring heads.

M01.ZB05.D2 Ø5mm drill bit (right hand)

M01.ZB05.D3 Ø5mm drill bit (left hand)

M01.ZB10.02 Ø10mm drill bit (right hand)

M01.ZB10.03 Ø10mm drill bit (left hand)

Installation tools

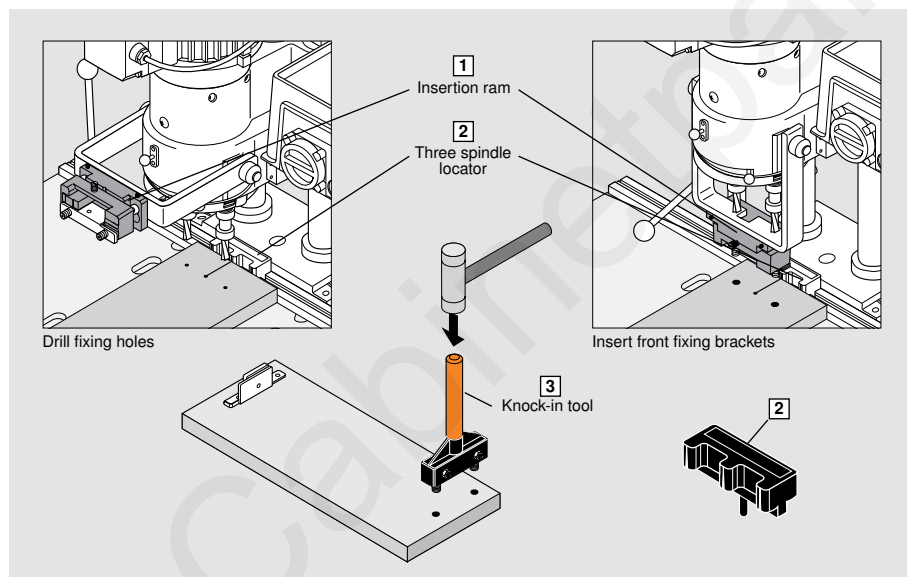

For location and insertion of front fixing brackets.

Three spindle locator enables the positioning of the drawer front without using fence stops.

MZM.0092.01 **1 Insertion ram for MINIPRESS**
for ZSF.1300 and ZSF.1800

MZR.2000 **2 Three spindle locator**

ZME.1600 **3 Knock-in tool**
for ZSF.1300 and ZSF.1800

ZME.1610 **3 Knock-in tool**
for ZSF.1610

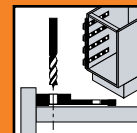

MINISTICK fence stop

Enables fast setup for drawer front boring and front fixing bracket insertion with the MINIPRESS.

Eliminates the need for multiple fence stops.

Includes:

- 1 LH & RH adj. stick mechanism
- 2 (2) Upper drawer stops
- 3 (2) Bottom drawer stops

MZS.0040 MINISTICK

Essential tool for production boring of drawer fronts when using DynaPlan software.

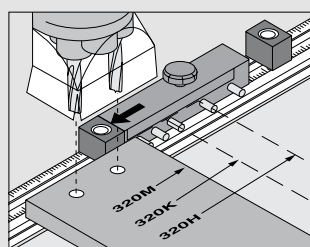

Boring drawer fronts

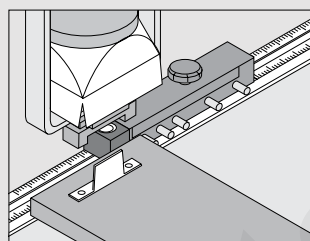

Inserting front fixing brackets

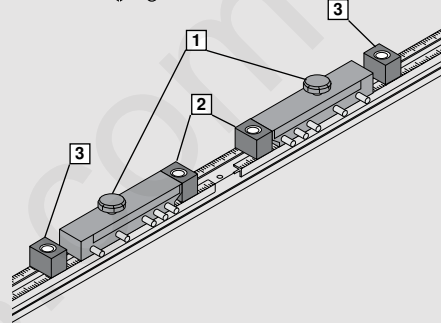
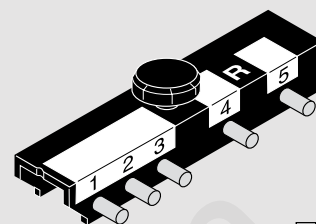

POZI DRIVER and bits

A POZI screwdriver (different from Phillips) is the most crucial tool you can use to assure that full torque is applied to all Blum adjustment screws. POZI screws can be identified by the distinctive "tick" marks located in the center of the screwhead recess.

- POZI DRIVER** #2 POZI DRIVER
- BIT HOLDER** 1/4" magnetic bit holder
- POZI BIT #2x1** #2 x 1" POZI bit insert

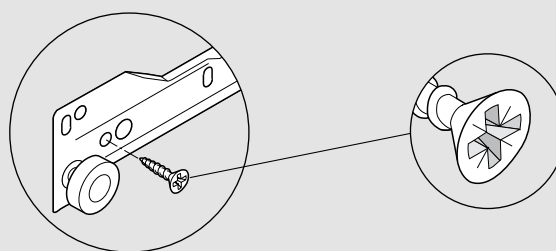
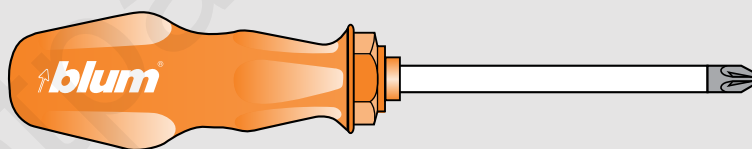

Screws and bumpers

Drawer bumpers

Cushions drawer closing
Self-adhesive back, clear



- FX4041** 6 (1/4") dia. x 1.5 (1/16") thk.
- SJ5312** 10 (3/8") dia. x 3 (1/8") thk.

Deep thread system screws

Pilot bore $\varnothing 5$ (3/16") hole
Nickel plated



- 661.1150** 11.5 (7/16"), #2 POZI
- 661.1300** 13 (1/2"), #2 POZI
- 661.1450** 14.5 (9/16"), #2 POZI
- 662.1150** 11.5 (7/16"), #2 POZI, small head for C15 METABOX assembly

Deep thread wood screws



606N/P

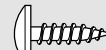

612TH

- 606N** #6 x 5/8", #2 Phillips, nickel plated
- 606P** #6 x 5/8", #2 POZI, nickel plated
- 612TH** #6 x 1/2", #2 Phillips, zinc plated

METABOX drawer front overlay charts

Determining front fixing bracket locations

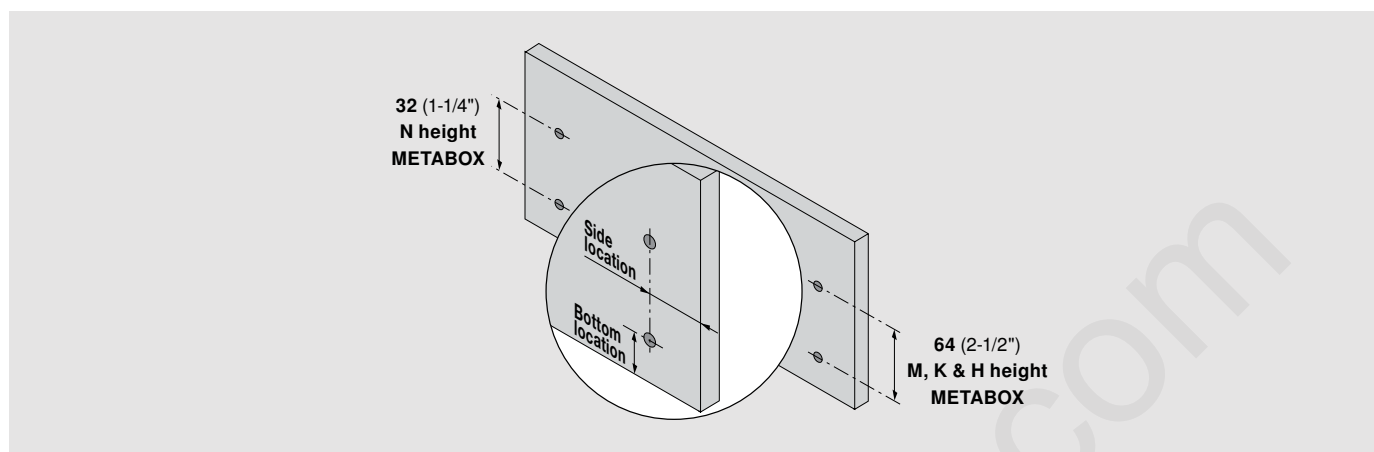

Side location

Side overlay	Screw or boring location
13 (1/2")	21.5 (13/16")
14 (9/16")	22.5 (7/8")
16 (5/8")	24.5 (15/16")
17.5 (11/16")	26 (1")
19 (3/4")	27.5 (1-1/16")

For overlays not shown please refer to specification pages 6-17 to calculate hole locations

Bottom location

Bottom overlay	Screw or boring location		
	N and M	K	H
13 (1/2")	26.5 (1")	58.5 (2-5/16")	90.5 (3-9/16")
14 (9/16")	27.5 (1-1/16")	59.5 (2-3/8")	91.5 (3-5/8")
16 (5/8")	29.5 (1-3/16")	61.5 (2-7/16")	93.5 (3-11/16")
17.5 (11/16")	31 (1-1/4")	63 (2-1/2")	95 (3-3/4")
19 (3/4")	32.5 (1-5/16")	64.5 (2-9/16")	96.5 (3-13/16")

For overlays not shown please refer to specification pages 6-17 to calculate hole locations

Part number index



Part No.	Page No.		
230M3500	30	320N5500C	6
230M4000	30	320N5500C15	6
230M4500	30	330H400PC	16
230M5000	30	330H400PC15	16
230M5500	30	330H450PC	16
295.4000	32	330H450PC15	16
298.2200	32	330H500PC	16
298.3210.01	31	330H500PC15	16
298.3230.01	31	330H550PC	16
320H3500C	12	330H550PC15	16
320H3500C15	12	330M400PC	14
320H4000C	12	330M400PC15	14
320H4000C15	12	330M450PC	14
320H4500C	12	330M450PC15	14
320H4500C15	12	330M500PC	14
320H5000C	12	330M500PC15	14
320H5000C15	12	330M550PC	14
320H5500C	12	330M550PC15	14
320H5500C15	12	602320	32
320K3500C	10	602750	31
320K3500C15	10	606N	37
320K4000C	10	606P	37
320K4000C15	10	612TH	37
320K4500C	10	65.3300	34
320K4500C15	10	661.1150	37
320K5000C	10	661.1300	37
320K5000C15	10	661.1450	37
320K5500C	10	662.1150	37
320K5500C15	10	BIT HOLDER	37
320M0048	31	DB-2.5mm	34
320M0088	31	DB-5mm	33
320M0188	31	DB-10mm	33
320M2700C	8	FX4041	37
320M2700C15	8	M01.ZB05.D2	36
320M3500C	8	M01.ZB05.D3	36
320M3500C15	8	M01.ZB10.02	36
320M4000C	8	M01.ZB10.03	36
320M4000C15	8	M52.1056.US	35
320M4500C	8	M53.1004.50	35
320M4500C15	8	M53.1004.US	35
320M5000C	8	M53.1005.50	35
320M5000C15	8	M53.1005.US	35
320M5500C	8	M53.1053.50	35
320M5500C15	8	M53.1053.UB	35
320N2700C	6	M53.1053.US	35
320N2700C15	6	M53.1056.US	35
320N3500C	6	METATEMP	33
320N3500C15	6	MZK.1000*US	35
320N4000C	6	MZK.8000*US	35
320N4000C15	6	MZM.0092.01	36
320N4500C	6	MZR.2000	36
320N4500C15	6	MZS.0040	37
320N5000C	6	POZI BIT #2x1	37
320N5000C15	6	POZI DRIVER	37
		SJ5312	37
		T65.5000.01	34
		Z36H367SE01	18
		Z36H417SE01	18
		Z36H467SE01	18
		Z36H517SE01	18
		Z36M367SE01	18
		Z36M417SE01	18
		Z36M467SE01	18
		Z36M517SE01	18
		ZAA.3500	8, 10, 12, 14, 16
		ZAA.3700	8, 10, 12, 14, 16
		ZIF.3000.02	23, 26
		ZIF.3000.03	23, 26
		ZIF.3010.02	22
		ZIF.3010.03	22
		ZIF.3030	24
		ZIF.3050	25, 27
		ZME.1600	36
		ZME.1610	36
		ZML.0010	30
		ZML.0040	33
		ZML.1500	33
		ZML.1510	33
		ZML.8000.01	33
		ZRE.321S.ID	18
		ZRE.371S.ID	18
		ZRE.421S.ID	18
		ZRE.471S.ID	18
		ZRE.521S.ID	18
		ZRG.1104U	18, 30
		ZRM.0004.10	28
		ZRM.1100G	28
		ZRM.1100S	28
		ZRM.5500.US	28
		ZRU.00E0.01	18, 30
		ZRU.00Z0.01	18, 30
		ZRU.10B1E	18
		ZSB.0045.01	31
		ZSB.0090.01	31
		ZSF.1200	8, 10, 12, 14, 16
		ZSF.1300	8, 10, 12, 14, 16
		ZSF.130E	8, 10, 12, 14, 16
		ZSF.1510.04	6
		ZSF.1510.05	6
		ZSF.1610.04	6
		ZSF.1610.05	6
		ZSF.1700	8, 10, 12, 14, 16
		ZSF.1800	8, 10, 12, 14, 16
		ZST.550MH	29
		ZTU.00Z0	30

Information is also available on these other Blum products:

- AVENTOS lift systems
- Blum Concealed hinges: CLIP top, CLIP, MODUL, and COMPACT
- BLUMOTION for doors
- DYNAMIC SPACE
- Machine and assembly aids
- ORGA-LINE organization system
- POCKET DOOR hardware
- STANDARD drawer runners
- SOLO concealed runners
- TANDEM concealed runners
- TANDEMBOX plus BLUMOTION drawer system



Blum, Inc.
7733 Old Plank Rd.
Stanley, NC 28164
toll free 800-438-6788
local 704-827-1345
fax 704-827-0799
internet www.blum.com
www.dynamicspace.us

